

**3/F Floor Plan  
3樓平面圖**

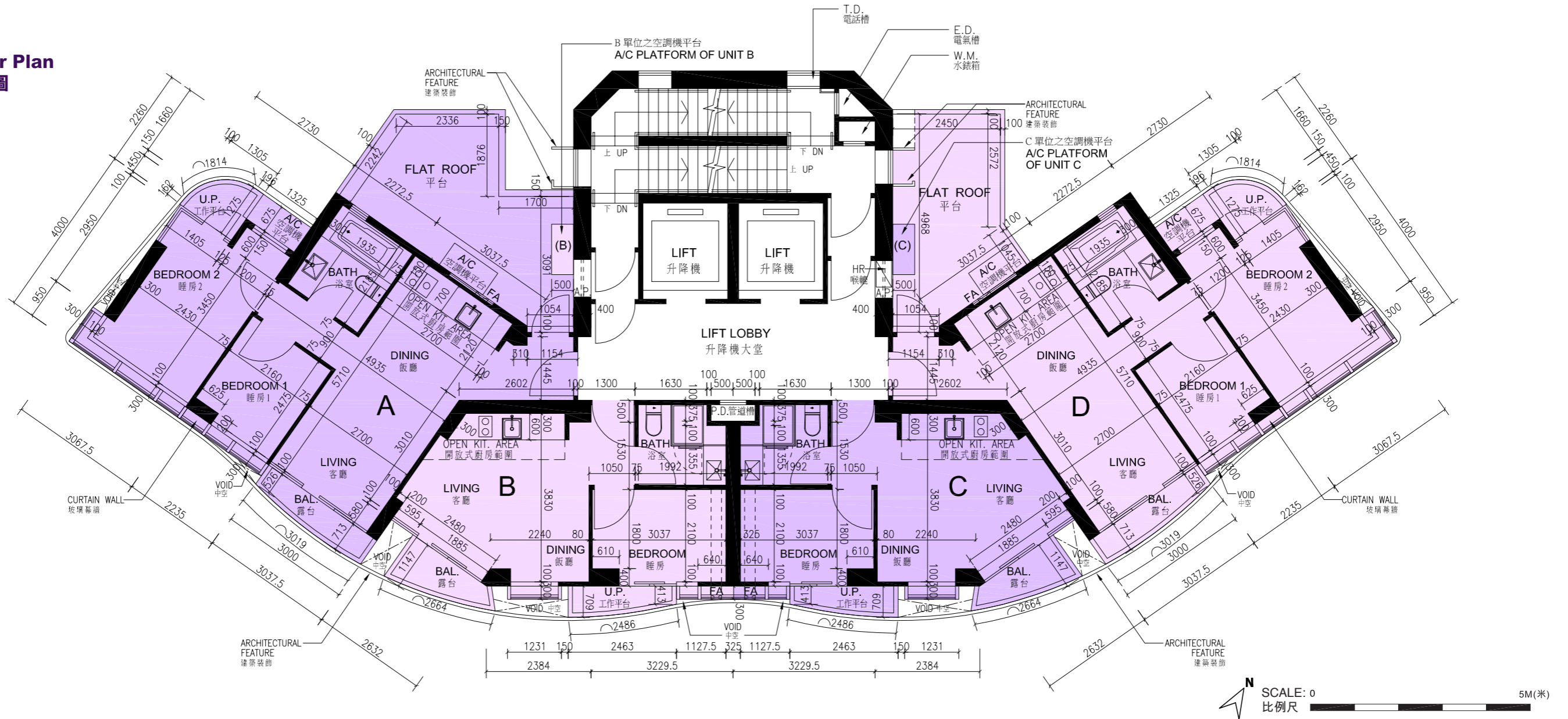

Living = Living Room 客廳  
Dining = Dining Room 飯廳  
A/C = Air Conditioner Platform 空調機平台  
E.D. = Electrical Duct 電氣槽

BAL. = Balcony 露台  
H.R./HR = Hose Reel 消防喉轆  
OPEN KIT. AREA = Open Kitchen Area 開放式廚房範圍  
P.D. = Pipe Duct 管道槽

T.D. = Telephone Duct 電話槽  
U.P. = Utility Platform 工作平台  
W.M. = Water Meter Room 水錶箱  
LAV. = Lavatory 洗手間

A.P. = Access Panel 檢修門  
FA = Flue Apertures 通風孔  
DN = Down 下

The thickness of the floor slabs (excluding plaster) of each residential property is 125mm, 150mm and 200mm.

The floor-to-floor height of the 3/F residential units is 3.12m.

The internal areas of the residential properties on the upper floors will generally be slightly larger than those on the lower floors because of the reducing thickness of the structural walls on the upper floors.

Note : 1. The dimensions in the floor plans are all structural dimensions in millimetre.

每個住宅物業的樓板 (不包括灰泥) 的厚度為125毫米、150毫米及200毫米。

3樓住宅物業的層與層之間的高度為3.12米。

因住宅物業的較高樓層的結構牆的厚度遞減，較高樓層的內部面積，一般比較低樓層的內部面積稍大。

附註：1. 平面圖所列之呎吋為以毫米標示之建築結構呎吋。

# Floor Plans of Residential Properties in the Development

## 發展項目的住宅物業的樓面平面圖

**5/F - 22/F Floor Plan**  
**(4/F, 13/F & 14/F are omitted)**  
**5樓至22樓平面圖**  
**(不設4樓、13樓及14樓)**

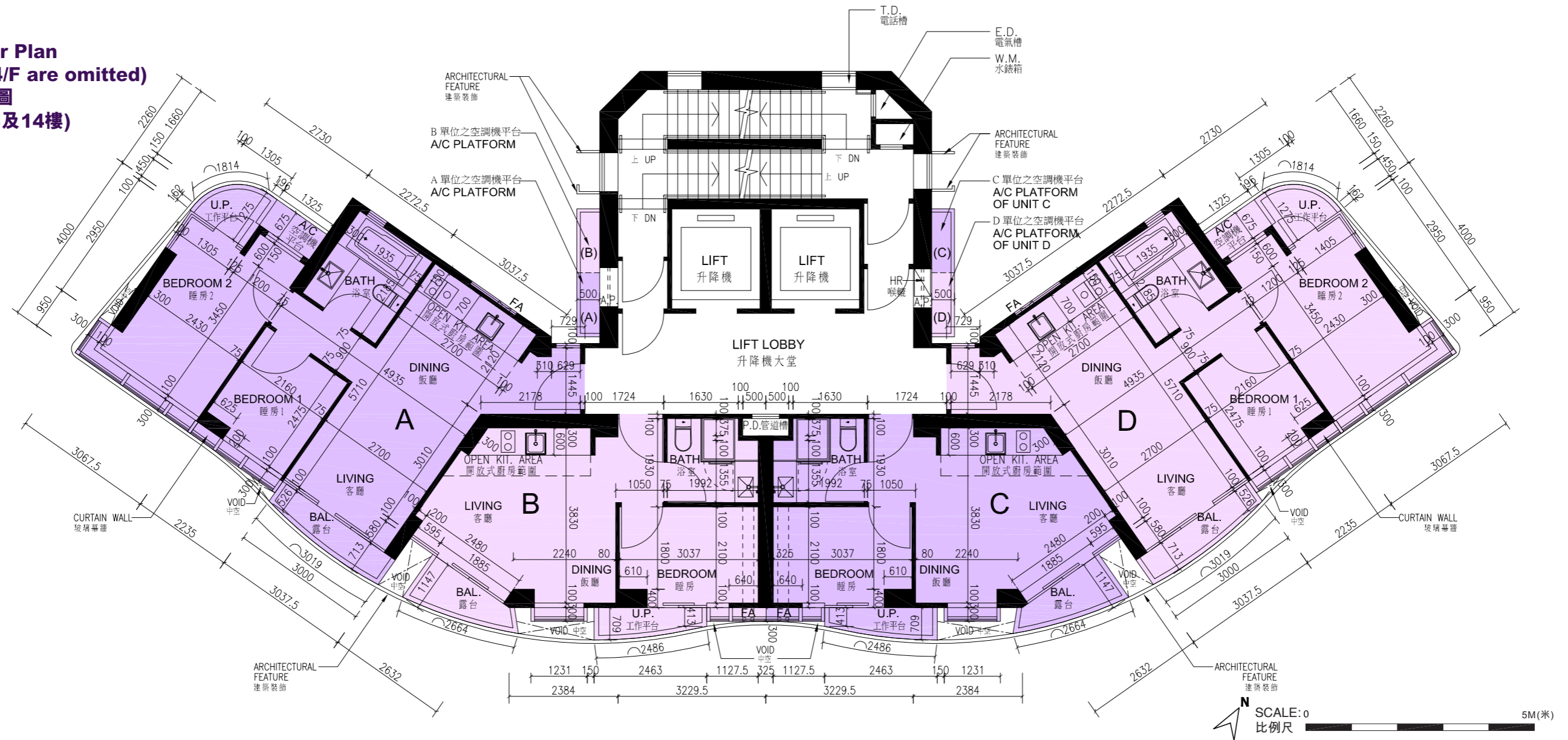

Living = Living Room 客廳  
 Dining = Dining Room 飯廳  
 A/C = Air Conditioner Platform 空調機平台  
 E.D. = Electrical Duct 電氣槽

BAL. = Balcony 露台  
 H.R./HR = Hose Reel 消防喉轆  
 OPEN KIT. AREA = Open Kitchen Area 開放式廚房範圍  
 P.D. = Pipe Duct 管道槽

T.D. = Telephone Duct 電話槽  
 U.P. = Utility Platform 工作平台  
 W.M. = Water Meter Room 水錶箱  
 LAV. = Lavatory 洗手間

A.P. = Access Panel 檢修門  
 FA = Flue Apertures 通風孔  
 DN = Down 下

The thickness of the floor slabs (excluding plaster) of each residential property is 125mm, 150mm and 200mm.

The floor-to-floor height of the 5/F - 12/F & 15/F - 22/F residential units is 3.12m.

The internal areas of the residential properties on the upper floors will generally be slightly larger than those on the lower floors because of the reducing thickness of the structural walls on the upper floors.

Note: 1. The dimensions in the floor plans are all structural dimensions in millimetre.

每個住宅物業的樓板 (不包括灰泥) 的厚度為125毫米、150毫米及200毫米。

5樓至12樓及15樓至22樓住宅物業的層與層之間的高度為3.12米。

因住宅物業的較高樓層的結構牆的厚度遞減，較高樓層的內部面積，一般比較低樓層的內部面積稍大。

附註： 1. 平面圖所列之呎吋為以毫米標示之建築結構呎吋。

**23/F Floor Plan  
23樓平面圖**

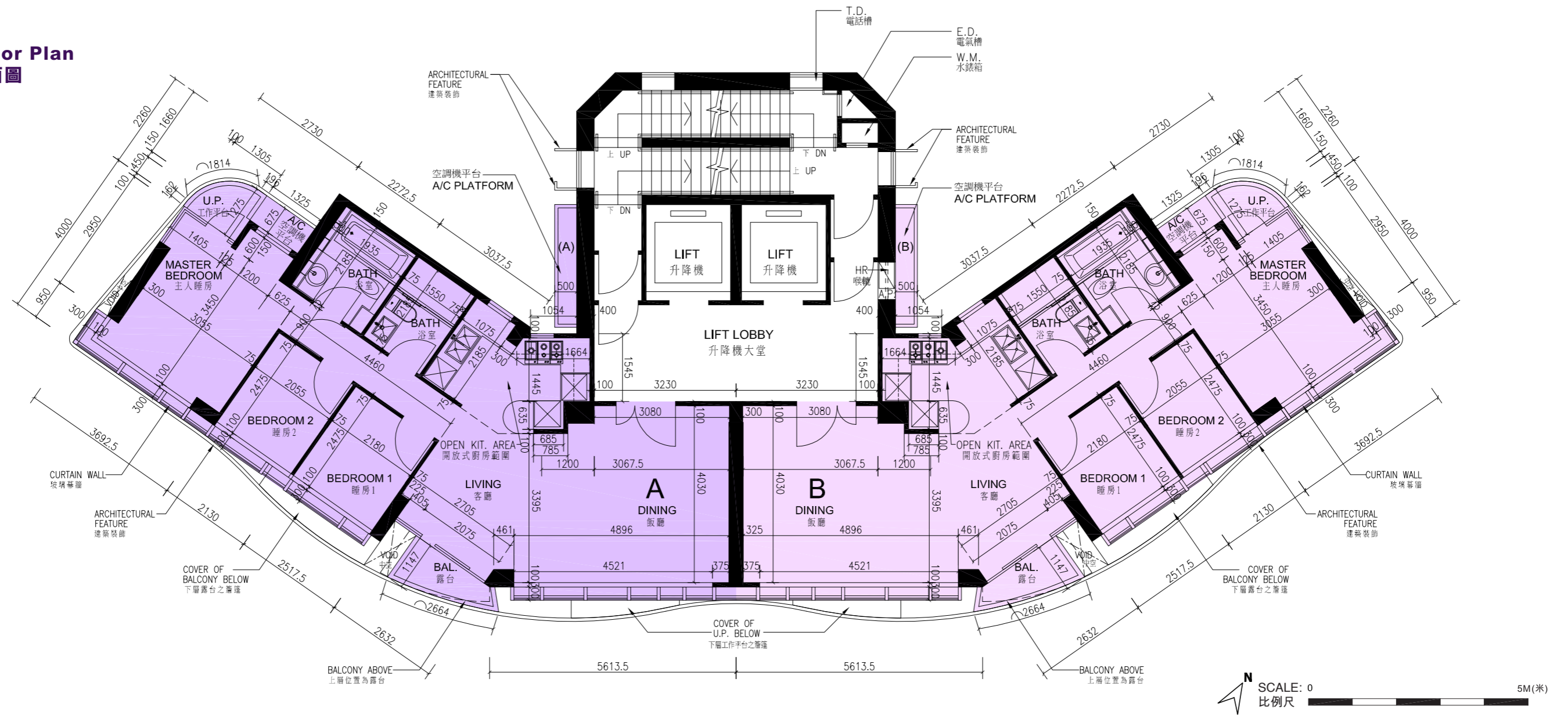

Living = Living Room 客廳  
 Dining = Dining Room 飯廳  
 A/C = Air Conditioner Platform 空調機平台  
 E.D. = Electrical Duct 電氣槽

BAL. = Balcony 露台  
 H.R./HR = Hose Reel 消防喉轆  
 OPEN KIT. AREA = Open Kitchen Area 開放式廚房範圍  
 P.D. = Pipe Duct 管道槽

T.D. = Telephone Duct 電話槽  
 U.P. = Utility Platform 工作平台  
 W.M. = Water Meter Room 水錶箱  
 LAV. = Lavatory 洗手間

A.P. = Access Panel 檢修門  
 FA = Flue Apertures 通風孔  
 DN = Down 下

The thickness of the floor slabs (excluding plaster) of each residential property is 125mm, 150mm and 200mm.

The floor-to-floor height of the 23/F residential units is 3.12m.

The internal areas of the residential properties on the upper floors will generally be slightly larger than those on the lower floors because of the reducing thickness of the structural walls on the upper floors.

Note: 1. The dimensions in the floor plans are all structural dimensions in millimetre.

每個住宅物業的樓板 (不包括灰泥) 的厚度為125毫米、150毫米及200毫米。

23樓住宅物業的層與層之間的高度為3.12米。

因住宅物業的較高樓層的結構牆的厚度遞減，較高樓層的內部面積，一般比較低樓層的內部面積稍大。

附註： 1. 平面圖所列之呎吋為以毫米標示之建築結構呎吋。

# Floor Plans of Residential Properties in the Development

## 發展項目的住宅物業的樓面平面圖

**25/F - 29/F Floor Plan**  
**25樓至29樓平面圖**

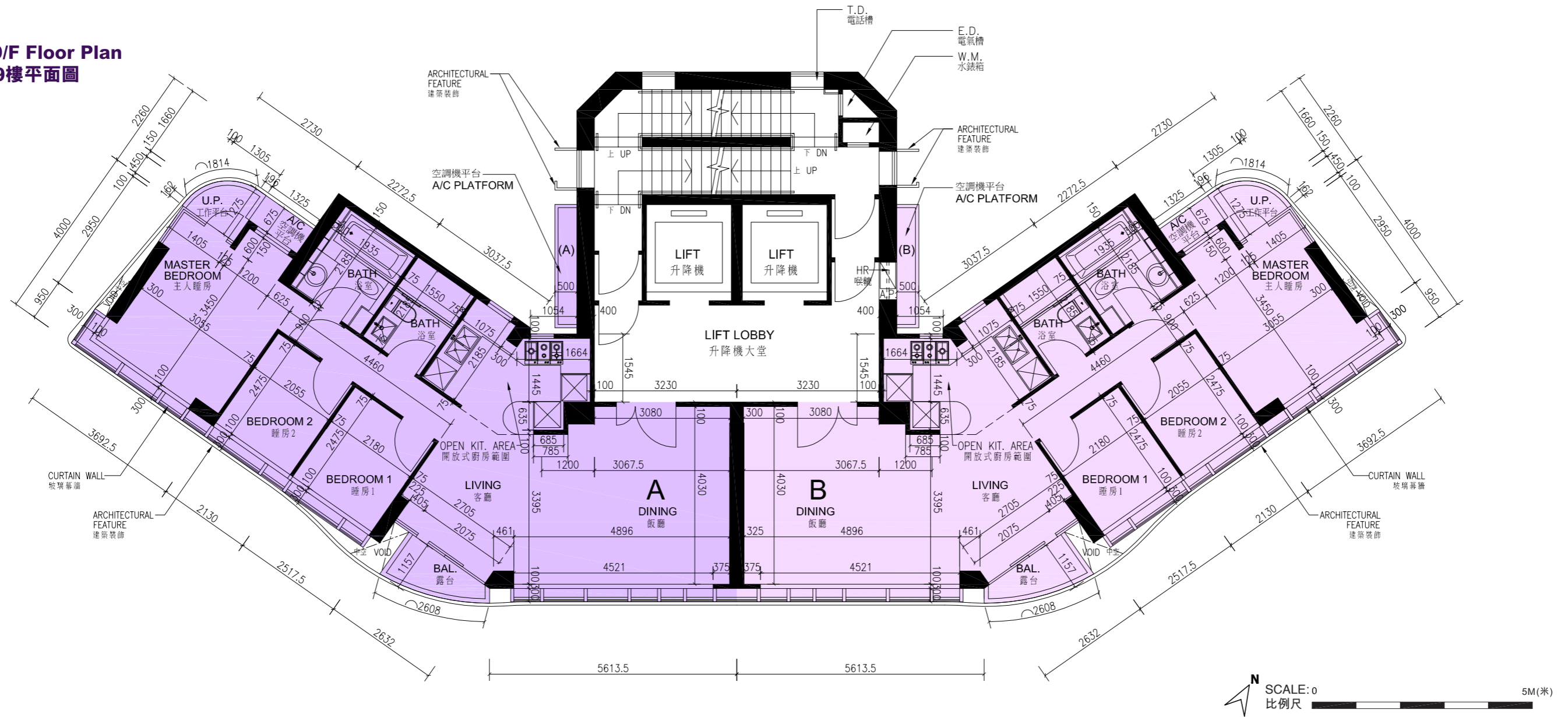

Living = Living Room 客廳  
Dining = Dining Room 飯廳  
A/C = Air Conditioner Platform 空調機平台  
E.D. = Electrical Duct 電氣槽

BAL. = Balcony 露台  
H.R./HR = Hose Reel 消防喉轆  
OPEN KIT. AREA = Open Kitchen Area 開放式廚房範圍  
P.D. = Pipe Duct 管道槽

T.D. = Telephone Duct 電話槽  
U.P. = Utility Platform 工作平台  
W.M. = Water Meter Room 水錶箱  
LAV. = Lavatory 洗手間

A.P. = Access Panel 檢修門  
FA = Flue Apertures 通風孔  
DN = Down 下

The thickness of the floor slabs (excluding plaster) of each residential property is 125mm, 150mm and 200mm.

The floor-to-floor height of the 25/F-29/F residential units is 3.12m.

The internal areas of the residential properties on the upper floors will generally be slightly larger than those on the lower floors because of the reducing thickness of the structural walls on the upper floors.

Note : 1. The dimensions in the floor plans are all structural dimensions in millimetre.

每個住宅物業的樓板 (不包括灰泥) 的厚度為125毫米、150毫米及200毫米。

25樓至29樓住宅物業的層與層之間的高度為3.12米。

因住宅物業的較高樓層的結構牆的厚度遞減，較高樓層的內部面積，一般比較低樓層的內部面積稍大。

附註： 1. 平面圖所列之呎吋為以毫米標示之建築結構呎吋。

**30/F Floor Plan**  
**30樓平面圖**

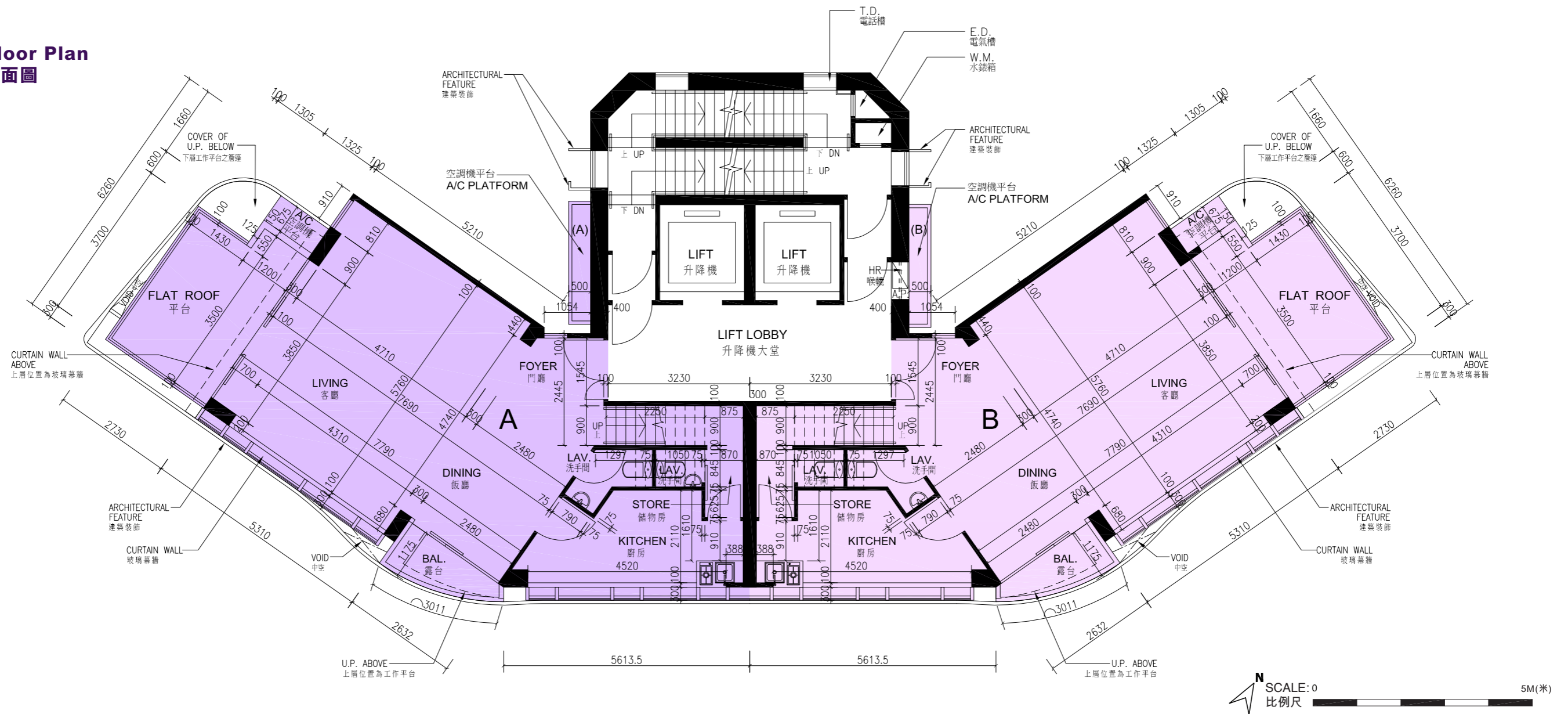

Living = Living Room 客廳  
Dining = Dining Room 飯廳  
A/C = Air Conditioner Platform 空調機平台  
E.D. = Electrical Duct 電氣槽

BAL. = Balcony 露台  
H.R./HR = Hose Reel 消防喉轆  
OPEN KIT. AREA = Open Kitchen Area 開放式廚房範圍  
P.D. = Pipe Duct 管道槽

T.D. = Telephone Duct 電話槽  
U.P. = Utility Platform 工作平台  
W.M. = Water Meter Room 水錶箱  
LAV. = Lavatory 洗手間

A.P. = Access Panel 檢修門  
FA = Flue Apertures 通風孔  
DN = Down 下

The thickness of the floor slabs (excluding plaster) of each residential property is 125mm, 150mm and 200mm.

The floor-to-floor height of the 30/F & 31/F residential units is 3.15m.

The internal areas of the residential properties on the upper floors will generally be slightly larger than those on the lower floors because of the reducing thickness of the structural walls on the upper floors.

Note : 1. The dimensions in the floor plans are all structural dimensions in millimetre.

每個住宅物業的樓板 (不包括灰泥) 的厚度為125毫米、150毫米及200毫米。

30樓及31樓住宅物業的層與層之間的高度為3.15米。

因住宅物業的較高樓層的結構牆的厚度遞減，較高樓層的內部面積，一般比較低樓層的內部面積稍大。

附註： 1. 平面圖所列之呎吋為以毫米標示之建築結構呎吋。

# Floor Plans of Residential Properties in the Development

## 發展項目的住宅物業的樓面平面圖

### 31/F Floor Plan 31樓平面圖

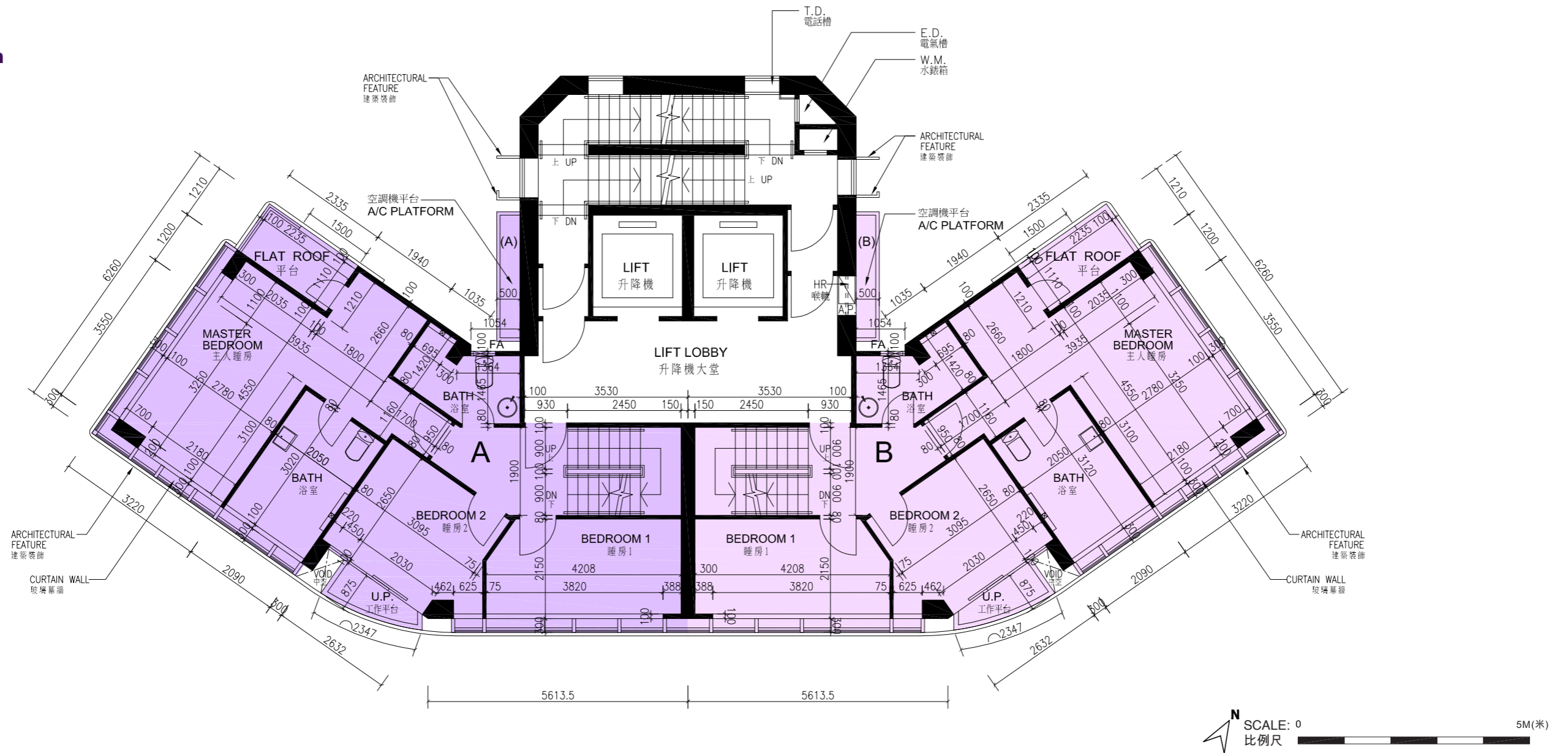

Living = Living Room 客廳  
 Dining = Dining Room 飯廳  
 A/C = Air Conditioner Platform 空調機平台  
 E.D. = Electrical Duct 電氣槽

BAL. = Balcony 露台  
 H.R./HR = Hose Reel 消防喉轆  
 OPEN KIT. AREA = Open Kitchen Area 開放式廚房範圍  
 P.D. = Pipe Duct 管道槽

T.D. = Telephone Duct 電話槽  
 U.P. = Utility Platform 工作平台  
 W.M. = Water Meter Room 水錶箱  
 LAV. = Lavatory 洗手間

A.P. = Access Panel 檢修門  
 FA = Flue Apertures 通風孔  
 DN = Down 下

The thickness of the floor slabs (excluding plaster) of each residential property is 125mm, 150mm and 200mm.

The floor-to-floor height of the 30/F & 31/F residential units is 3.15m.

The internal areas of the residential properties on the upper floors will generally be slightly larger than those on the lower floors because of the reducing thickness of the structural walls on the upper floors.

Note : 1. The dimensions in the floor plans are all structural dimensions in millimetre.

每個住宅物業的樓板 (不包括灰泥) 的厚度為125毫米、150毫米及200毫米。

30樓及31樓住宅物業的層與層之間的高度為3.15米。

因住宅物業的較高樓層的結構牆的厚度遞減，較高樓層的內部面積，一般比較低樓層的內部面積稍大。

附註： 1. 平面圖所列之呎吋為以毫米標示之建築結構呎吋。

## Roof Floor Plan 天台平面圖

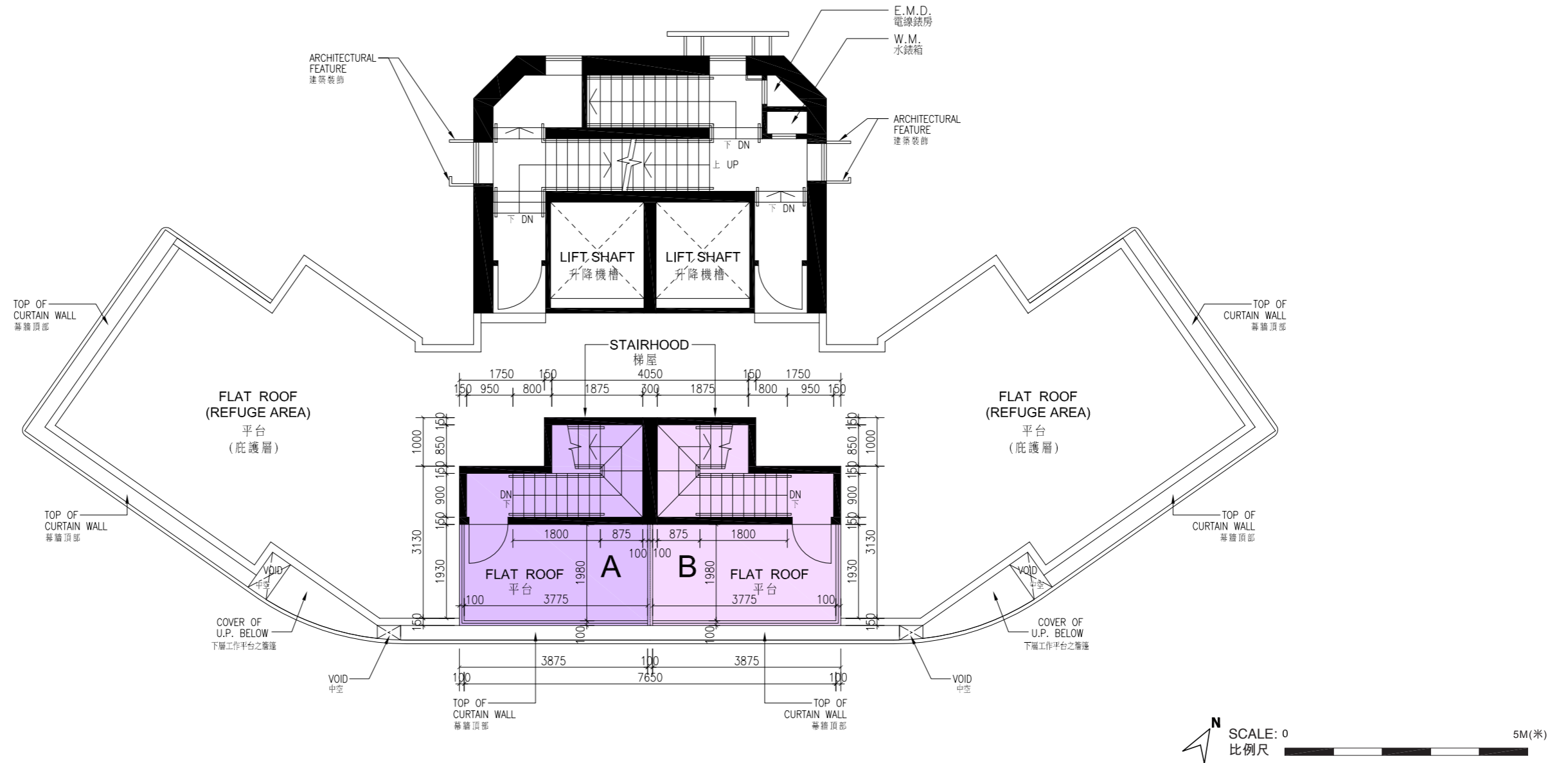

Living = Living Room 客廳  
Dining = Dining Room 飯廳  
A/C = Air Conditioner Platform 空調機平台  
E.D. = Electrical Duct 電氣槽

BAL. = Balcony 露台  
H.R./HR = Hose Reel 消防喉轆  
OPEN KIT. AREA = Open Kitchen Area 開放式廚房範圍  
P.D. = Pipe Duct 管道槽

T.D. = Telephone Duct 電話槽  
U.P. = Utility Platform 工作平台  
W.M. = Water Meter Room 水錶箱  
LAV. = Lavatory 洗手間

A.P. = Access Panel 檢修門  
FA = Flue Apertures 通風孔  
DN = Down 下

The thickness of the floor slabs (excluding plaster) of each residential property is 125mm, 150mm and 200mm.

The floor-to-floor height of the residential units: Not applicable.

The internal areas of the residential properties on the upper floors will generally be slightly larger than those on the lower floors because of the reducing thickness of the structural walls on the upper floors.

Note : 1. The dimensions in the floor plans are all structural dimensions in millimetre.  
2. The "FLAT ROOF" on the roof plan means the uppermost roof slab of the development.

每個住宅物業的樓板 (不包括灰泥) 的厚度為125毫米、150毫米及200毫米。

住宅物業的層與層之間的高度：不適用。

因住宅物業的較高樓層的結構牆的厚度遞減，較高樓層的內部面積，一般比較低樓層的內部面積稍大。

附註： 1. 平面圖所列之呎吋為以毫米標示之建築結構呎吋。  
2. 此天台平面圖上的「平台」是指此發展項目的最高天台樓板。