

# 7

## LOCATION PLAN OF THE DEVELOPMENT

### 發展項目的所在位置圖

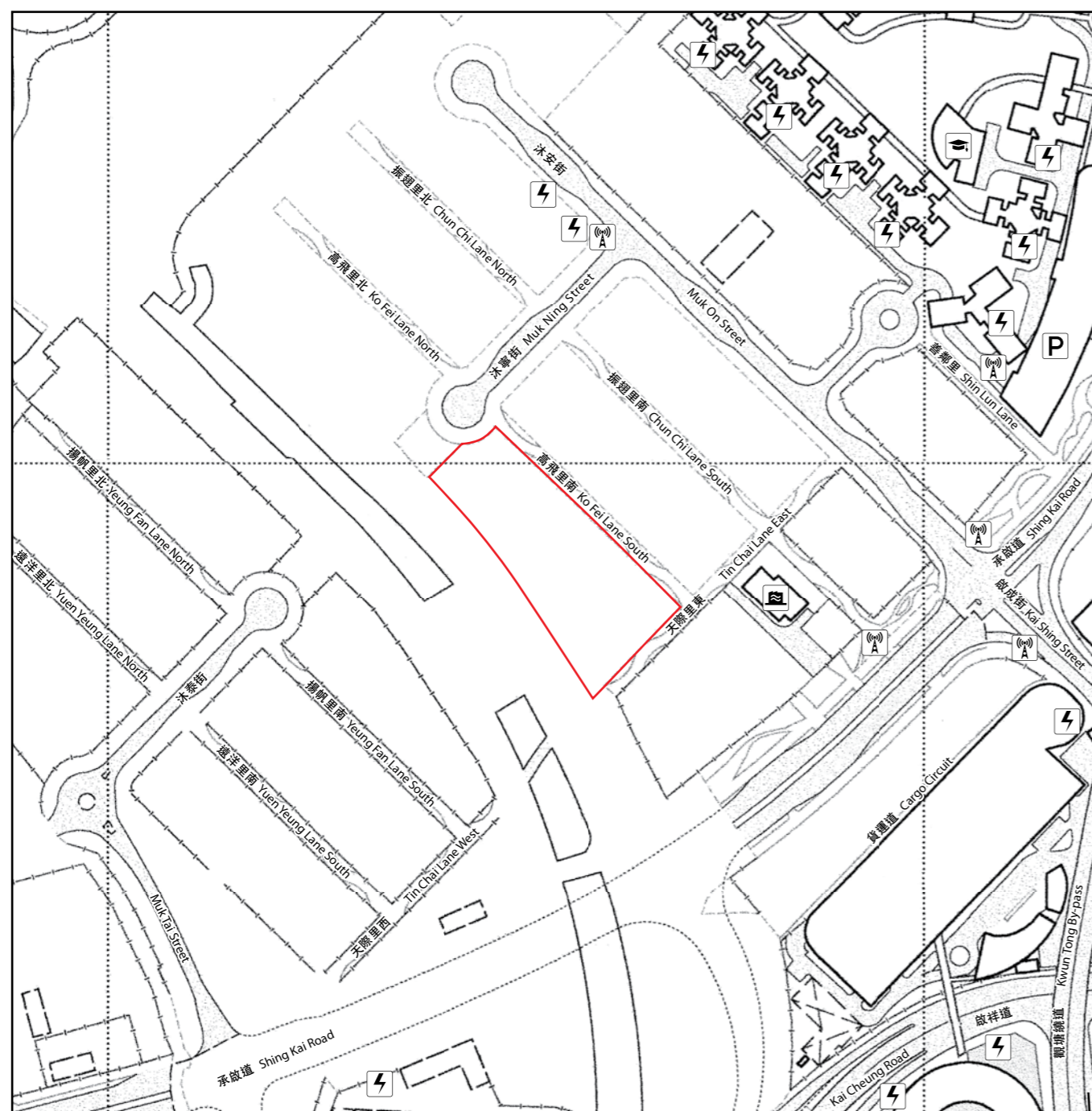

#### NOTATION 圖例

- |  |   |
|--|---|
| a power plant (including electricity sub-stations)<br>發電廠 (包括電力分站) | sewage treatment works and facilities<br>污水處理廠及設施 |
| a public carpark (including a lorry park)<br>公眾停車場 (包括貨車停泊處)       | a public utility installation<br>公用事業設施裝置         |
| a school (including a kindergarten)<br>學校 (包括幼稚園)                  |   |

#### Notes:

1. The Location Plan of the Development is made with reference to Survey Sheet Nos. 11-NE-A dated 2 February 2017 and 11-NE-C dated 2 February 2017, with adjustments where necessary.
2. The Location Plan may show more than the area required under Residential Properties (First-hand Sales) Ordinance due to the technical reason that the boundary of the Development is irregular.
3. The Vendor advises purchasers to conduct an on-site visit for a better understanding of the development site, its surrounding environment and the public facilities nearby.
4. The street name of "Ko Fei Lane South" as shown in this Location Plan was formerly known as "Kai Tak Third Lane" (as shown in the approved building plans of the Development). The said street is shown as "Kai Tak Third Lane" in the other sections of this Sales Brochure.
5. The street name of "Tin Chai Lane East" as shown in this Location Plan was formerly known as "Kai Tak Fourth Lane" (as shown in the approved building plans of the Development). The said street is shown as "Kai Tak Fourth Lane" in the other sections of this Sales Brochure.

#### 附註：

1. 發展項目的所在位置圖參考於2017年2月2日修訂之測繪圖編號11-NE-A及於2017年2月2日修訂之測繪圖編號11-NE-C，經修正處理。
2. 由於發展項目的邊界不規則的技術原因，此位置圖所顯示的範圍可能超過《一手住宅物業銷售條例》所要求顯示的範圍。
3. 賣方建議買方到該發展地盤作實地考察，以對該發展地盤及其周邊地區環境及附近的公共設施有較佳的了解。
4. 此位置圖所顯示的街道名稱“高飛里南”前稱“啟德三里”(如發展項目的經批准的建築圖則中所示)。該街道在本售樓說明書的其他部份顯示為“啟德三里”。
5. 此位置圖所顯示的街道名稱“天際里東”前稱“啟德四里”(如發展項目的經批准的建築圖則中所示)。該街道在本售樓說明書的其他部份顯示為“啟德四里”。

Location of the Development  
發展項目的位置

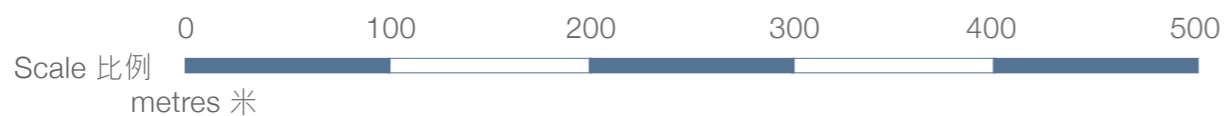

展貿徑 Trademart Drive

The map is reproduced with permission of the Director of Lands © The Government of Hong Kong SAR. Licence No. 26/2017.  
地圖版權屬香港特區政府，經地政總署准許複印，版權特許編號26/2017。