

LOCATION PLAN OF THE DEVELOPMENT 發展項目的所在位置圖

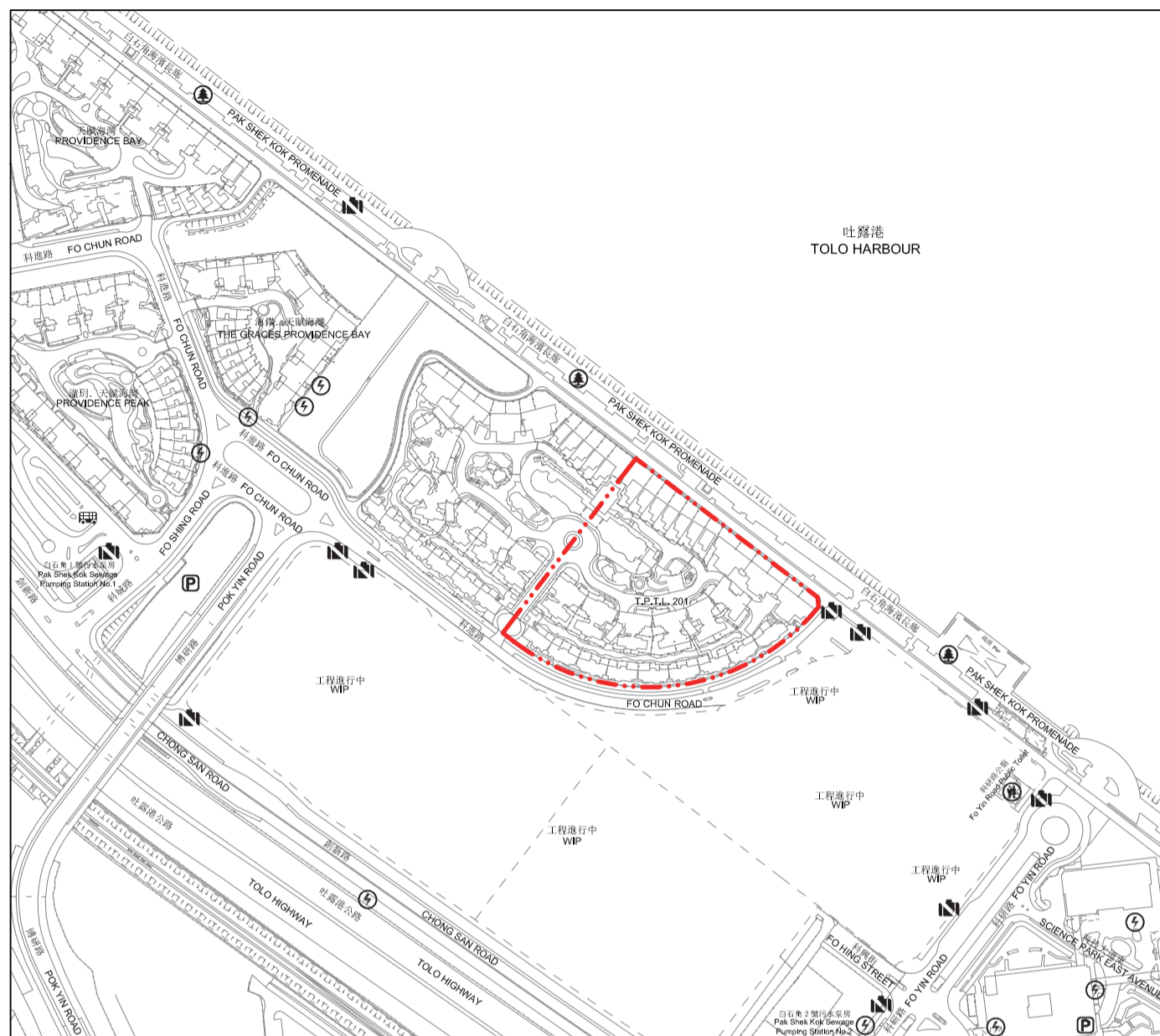

Boundary line of Development
發展項目的邊界

The Location Plan is prepared with reference to part of the Digital Topographic Map iB1000 / Sheet Number 7-NE-11D (Last update on 8th June 2017); 7-NE-12C (Last update on 30th March 2017); 7-NE-16B (Last update on 6th July 2017) & 7-NE-17A (Last update on 25th June 2017) from Survey and Mapping office of the Lands Department with adjustments where necessary.

The Location Plan is reproduced with permission of the Director of Lands. ©The Government of the Hong Kong SAR. Licence No. 60/2014.

此所在位置圖是參考於地政總署測繪處之數碼地形圖 iB1000/ 編號 7-NE-11D(最近更新 2017 年 6 月 8 日); 7-NE-12C(最近更新 2017 年 3 月 30 日); 7-NE-16B(最近更新 2017 年 7 月 6 日) 及 7-NE-17A(最近更新 2017 年 6 月 25 日)，有需要地方經修正處理。

此所在位置圖版權屬香港特區政府，經地政總署准許複印，版權特許編號 60/2014。

Scale: 0M/ 米 250M/ 米
比例:

Legends 圖例

- | | | |
|--|--|-----------------|
| | power plant (including electricity sub-stations) | 發電廠 (包括電力分站) |
| | public convenience | 公廁 |
| | public transport terminal (including a rail station) | 公共交通總站 (包括鐵路車站) |
| | public utility installation | 公用事業設施裝置 |
| | public park | 公園 |
| | public carpark (including a lorry park) | 公眾停車場 (包括貨車停泊處) |

Remark:

Due to technical reasons, this Location Plan shows more than the area required under the Residential Properties (First-hand Sales) Ordinance (Cap. 621).

備註:

由於技術原因，此所在位置圖所顯示的範圍超過《一手住宅物業銷售條例》(第621章)的規定。