

## 發展項目的布局圖

## LAYOUT PLAN OF THE DEVELOPMENT

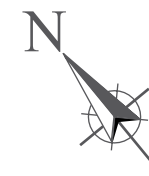

SHUN NING ROAD 順寧道

TONKIN STREET 東京街

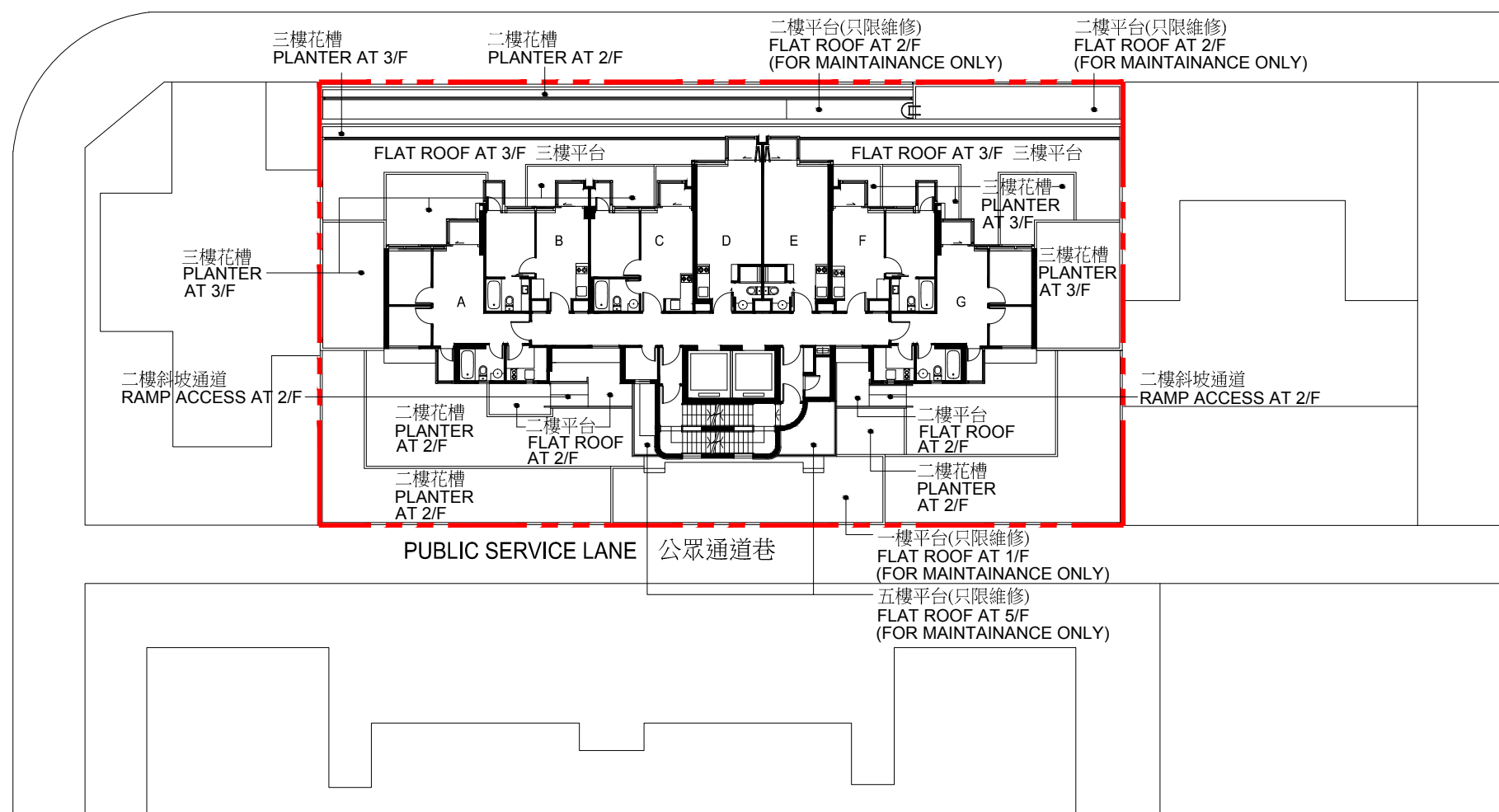

 發展項目界線  
Boundary Line of Development

由發展項目的認可人士提供的未落成建築物或設施的預計落成日期(註:指佔用許可證發出日期):  
2018年2月28日

附註：  
圖中所示之發展項目住宅大樓布局參照適用於十八樓之布局。

0米/M 20米/M

比例: 

Scale:

The estimated date of completion of the uncompleted building or facilities (note: i.e. issue of the occupation permit) as provided by the Authorized Person for the Development: 28th February 2018

Note:  
The layout of the residential tower of the Development shown in the plan is based on the layout applicable to 18/F.