

OUTLINE ZONING PLAN RELATING TO THE DEVELOPMENT 關乎發展項目的分區計劃大綱圖

Extract from part of The Kowloon Planning Area no. 14 (PART) – Draft Kwun Tong (South) Outline Zoning Plan No. S/K14S/21 gazetted on 3rd November, 2017.
 摘錄自2017年11月3日憲報公布之觀塘南部(九龍規劃區第14區部分)分區計劃大綱草圖(編號S/K14S/21)。
 The Outline Zoning Plan is reproduced with permission of the Director of Lands. The Government of Hong Kong SAR Licence No. 25/2013.
 分區大綱圖版權屬香港特區政府，經地政總署准許複印，版權特許編號25/2013。



Notation 圖例

Zones 地帶

- Commercial 商業 C
- Residential(Group A) 住宅(甲類) R(A)
- Residential(Group B) 住宅(乙類) R(B)
- Government, Institution Or Community 政府、機構或社區 G/I/C
- Open Space 休憩用地 O
- Other Specified Uses 其他指定用途 OU
- Green Belt 綠化地帶 GB

Communications 交通

- Railway And Station 鐵路及車站 STATION
- Railway And Station (Underground) 鐵路及車站(地下) STATION
- Railway And Station (Elevated) 鐵路及車站(高架) STATION
- Major Road And Junction 主要道路及路口 STATION
- Elevated Road 高架道路 STATION

Miscellaneous 其他

- Boundary Of Planning Scheme 規劃範圍界線 STATION
- Urban Renewal Authority Development Scheme Plan Area 市區重建局發展計劃圖範圍 STATION
- Building Height Control Zone Boundary 建築物高度管制區界線 STATION
- Maximum Building Height (In Meters Above Principal Datum) 最高建築物高度 (在主水平基準上若干米) STATION
- Petrol Filling Station 加油站 PFS STATION

此區的土地用途地帶見市區重建局觀塘市中心
 - 主地盤發展計劃圖
 FOR ZONING OF THIS AREA, REFER TO URBAN RENEWAL AUTHORITY KWUN TONG TOWN CENTRE DEVELOPMENT SCHEME PLAN - MAIN SITE

此區的土地用途地帶見市區重建局觀塘市中心
 - 月華街地盤發展計劃圖
 FOR ZONING OF THIS AREA, REFER TO URBAN RENEWAL AUTHORITY KWUN TONG TOWN CENTRE DEVELOPMENT SCHEME PLAN - YUET WAH STREET SITE

 Boundary Line of the Development
 發展項目邊界

Scale: 0M/米 500M/米
 比例:

Remark: Due to technical reasons (such as the shape of the Development), the Outline Zoning Plan has shown more than the area required under the Residential Properties (First-hand Sales) Ordinance.

備註：因技術原因(例如發展項目之形狀)，分區計劃大綱圖所顯示之範圍多於《一手住宅物業銷售條例》所要求者。

DEVELOPMENT SCHEME PLAN RELATING TO THE DEVELOPMENT
 關乎發展項目的發展計劃圖

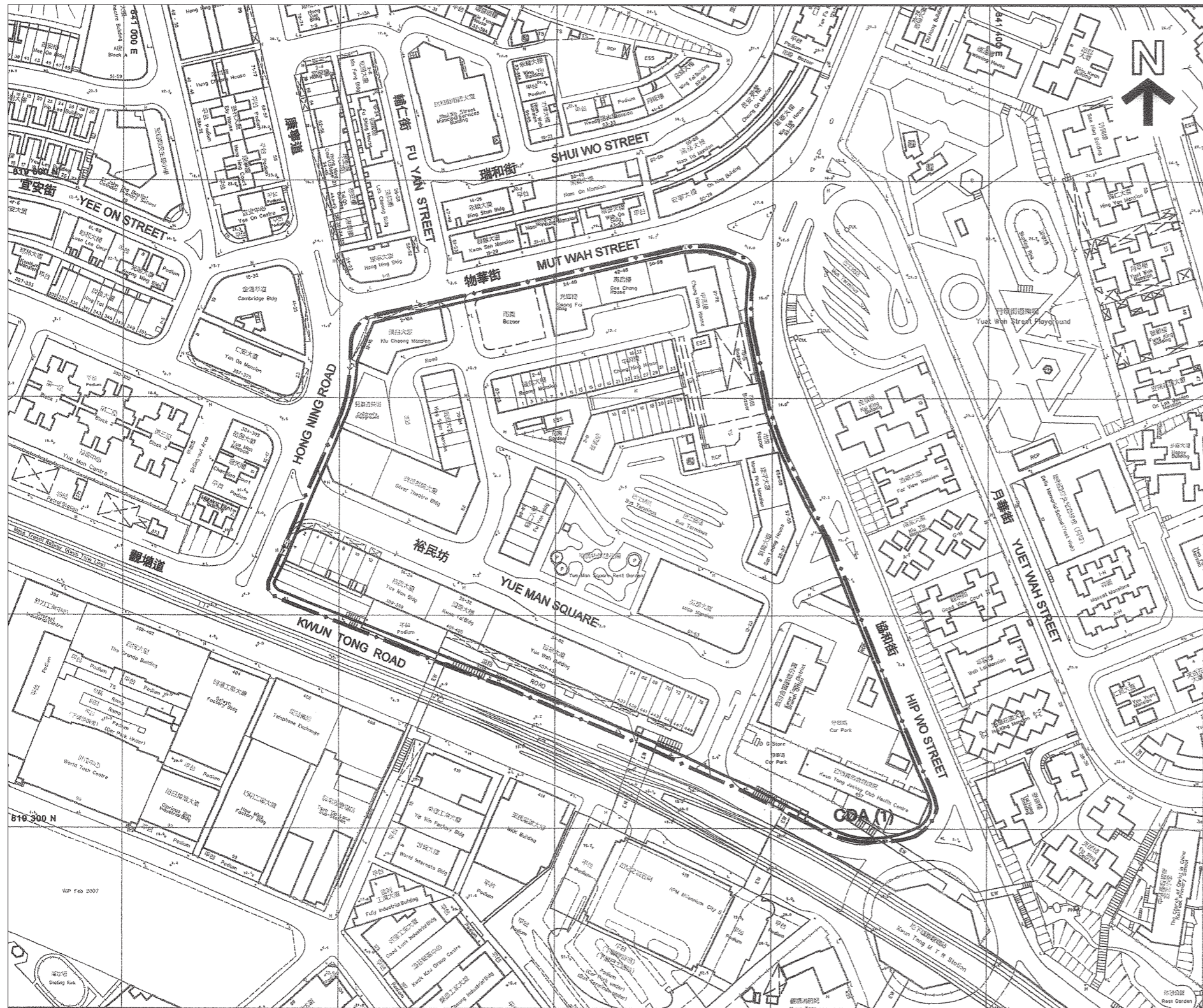

Notation 圖例

Boundary of Development Scheme
 發展計劃範圍界線



Comprehensive Development (1)
 綜合發展區(1)



0M/米 120M/米
 Scale:
 比例:

Extract from the Urban Renewal Authority Kwun Tong Town Centre Development Scheme Plan - Main Site (Plan No. S/K14S/URA1/2) Gazetted on 12 Sept, 2008. 摘錄自2008年9月12日刊憲之市區重建局觀塘市中心 - 主地盤發展計劃圖 (編號 S/K14S/URA1/2)

The Development Scheme Plan - Land Use Diagram is reproduced with permission of the Director of Lands The Government of Hong Kong SAR Licence No. 25/2013. 發展計劃圖 - 土地用途圖表版權屬香港特區政府，經地政總署准許複印，版權特許編號25/2013。

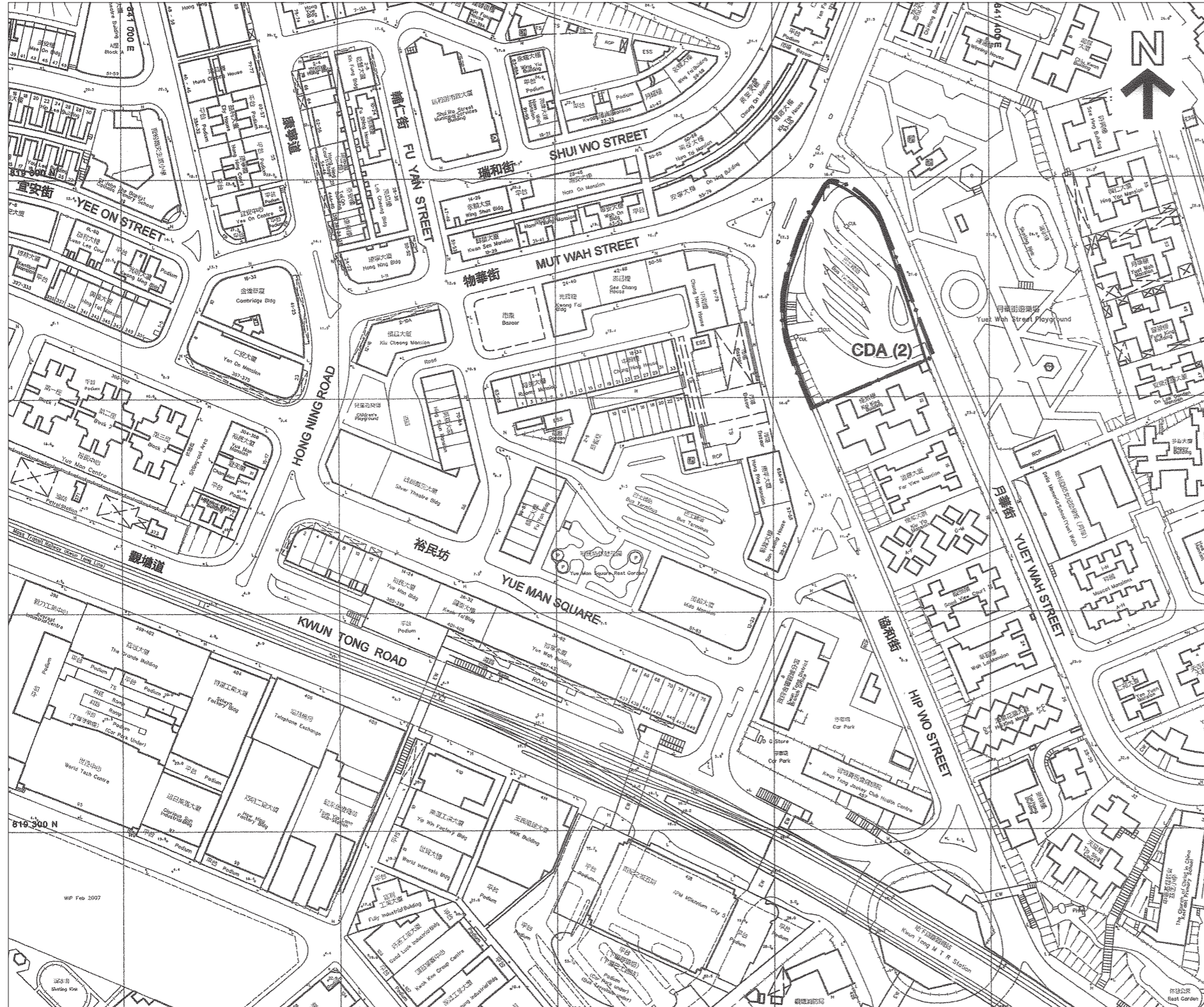

Notation 圖例

Boundary of Development Scheme
 發展計劃範圍界線



Comprehensive Development (2)
 綜合發展區 (2)



0M/米 120M/米
 Scale: 比例:

Extract from the Urban Renewal Authority Kwun Tong Town Centre Development Scheme Plan - Yuet Wah Street Site. (Plan No. S/K14S/URA2/2) Gazetted on 12 Sept, 2008. 摘錄自2008年9月12日刊憲之市區重建局觀塘市中心 - 月華街地盤發展計劃圖 (編號 S/K14S/URA2/2)

The Development Scheme Plan - Land Use Diagram is reproduced with permission of the Director of Lands The Government of Hong Kong SAR Licence No. 25/2013. 發展計劃圖 - 土地用途圖表版權屬香港特區政府，經地政總署准許複印，版權特許編號25/2013。

OUTLINE ZONING PLAN RELATING TO THE DEVELOPMENT 關乎發展項目的分區計劃大綱圖

The outline zoning plan is adopted from part of the Kowloon Planning Area No.15 - Approved Cha Kwo Ling, Yau Tong, Lei Yue Mun Outline Zoning Plan No. S/K15/25 gazetted on 28th April 2017.
 分區計劃大綱圖摘錄自憲報公布日期為2017年4月28日的茶果嶺、油塘及鯉魚門(九龍規劃區第15區)分區計劃大綱核准圖(編號S/K15/25)。
 The Outline Zoning Plan is reproduced with permission of the Director of Lands, The Government of Hong Kong SAR Licence No. 25/2013.
 分區大綱圖版權屬香港特區政府，經地政總署准許複印，版權特許編號25/2013。

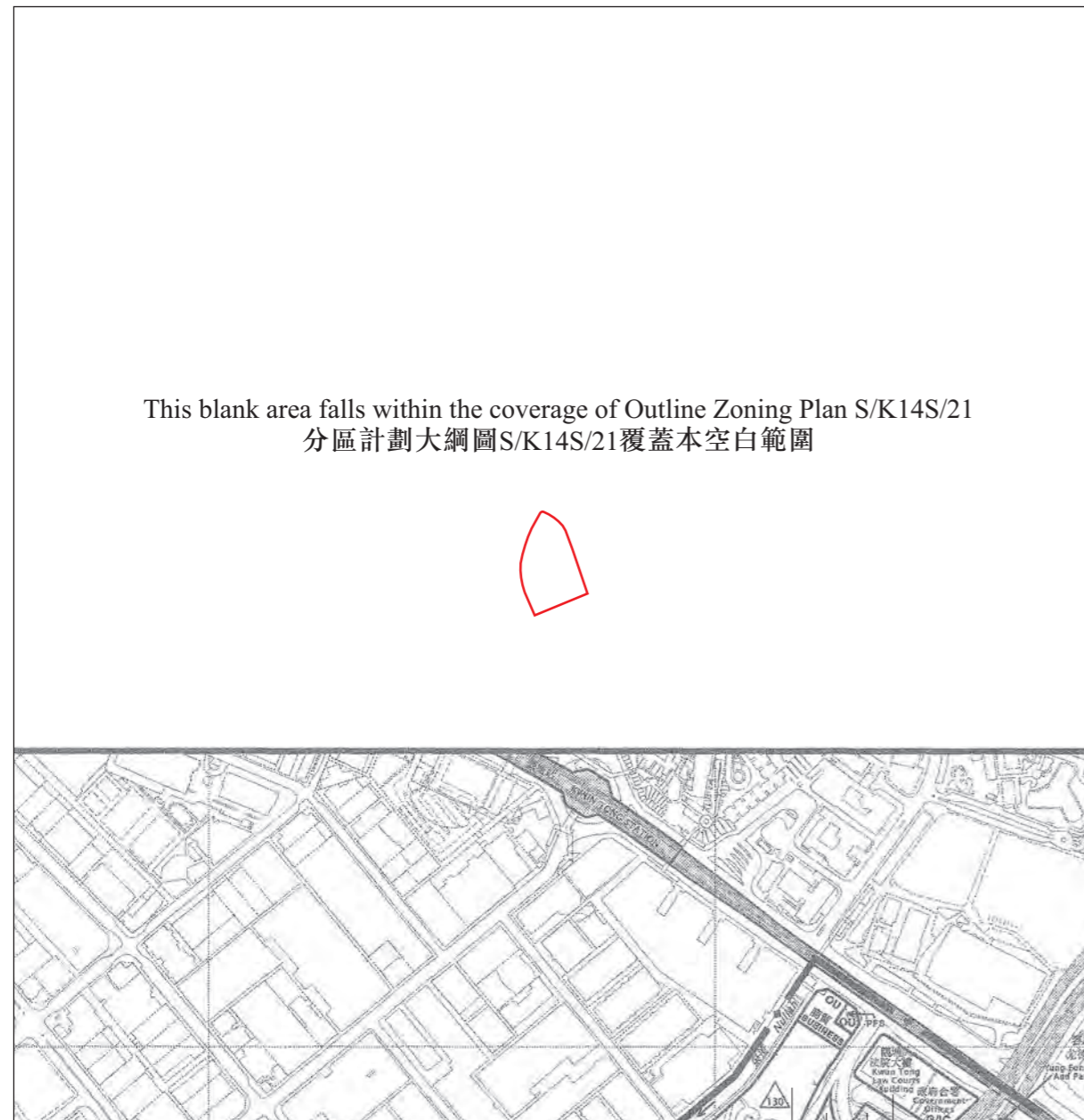

Boundary Line of the Development
 發展項目邊界



		Notation 圖例	
Zones 地帶		Communications 交通	
Commercial 商業		Railway And Station 鐵路及車站	
Comprehensive Development Area 綜合發展區		Railway And Station (Underground) 鐵路及車站(地下)	
Residential (Group A) 住宅(甲類)		Railway And Station (Elevated) 鐵路及車站(高架)	
Residential (Group E) 住宅(戊類)		Major Road And Junction 主要道路及路口	
Village Type Development 鄉村式發展		Elevated Road 高架道路	
Government, Institution Or Community 政府、機構或社區		Miscellaneous 其他	
Open Space 休憩用地		Boundary Of Planning Scheme 規劃範圍界線	
Other Specified Uses 其他指定用途		Building Height Control Zone Boundary 建築物高度管制區界線	
Green Belt 綠化地帶		Maximum Building Height (In Meters Above Principal Datum) 最高建築物高度 (在主水平基準上若干米)	
Coastal Protection Area 海岸保護區		Maximum Building Height (In Number of Storeys) 最高建築物高度(樓層數目)	
		Petrol Filling Station 加油站	P F S

Remark: Due to technical reasons (such as the shape of the Development), the Outline Zoning Plan has shown more than the area required under the Residential Properties (First-hand Sales) Ordinance.

備註：因技術原因(例如發展項目之形狀)，分區計劃大綱圖所顯示之範圍多於《一手住宅物業銷售條例》所要求者。