

發展項目的布局圖

Layout plan of the development

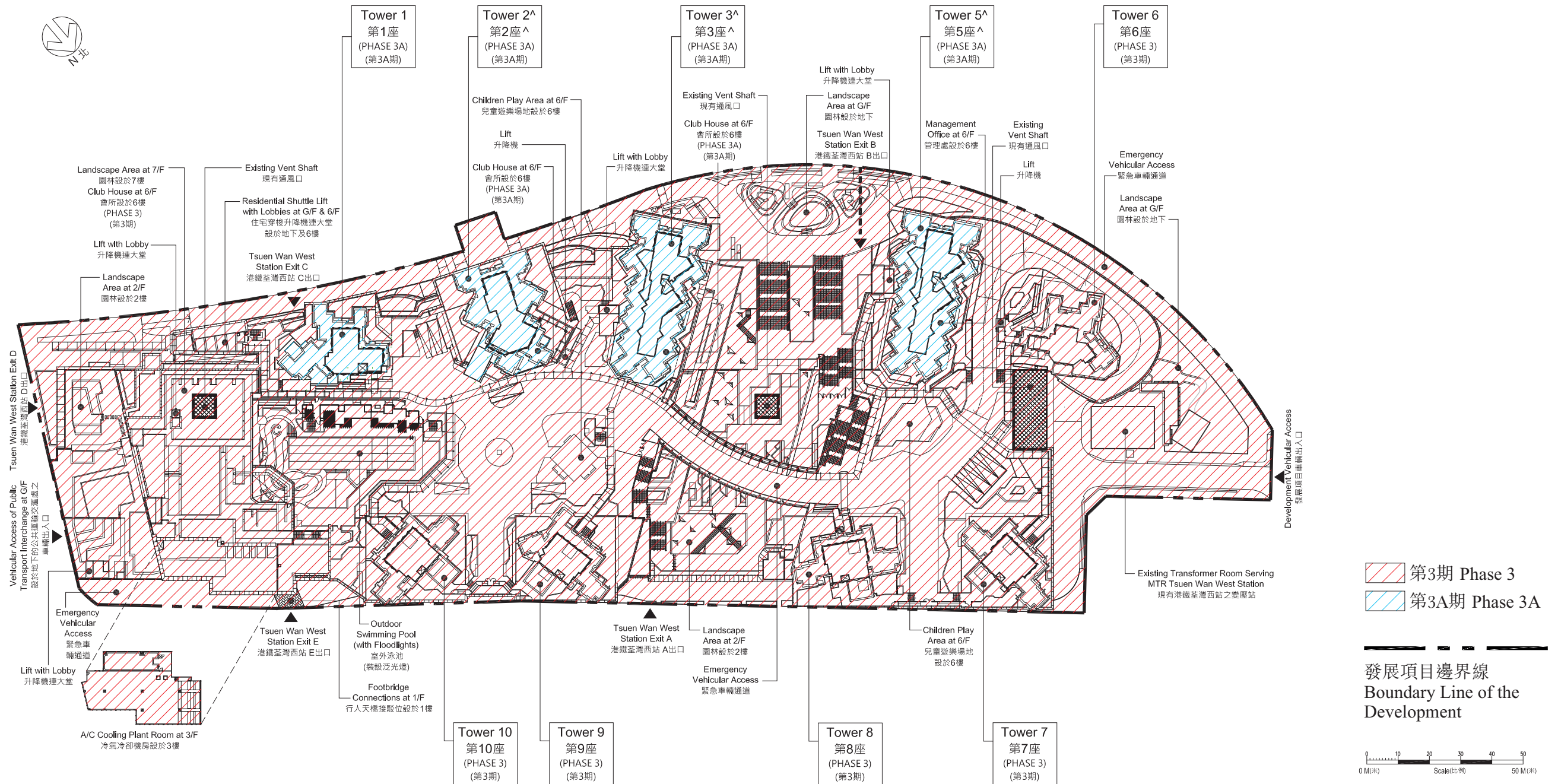

備註1：游泳池之周邊會裝設泛光燈以供應游泳池的照明（視乎情況需要）。

備註2：組成發展項目一部分的港鐵荃灣西站上蓋有香港鐵路的通風口。

備註3：期數內的每座大樓下方的發展項目低層基座樓宇的外牆可能設有背光招牌及裝飾照明。該等招牌及裝飾照明的位置可能不時改變。

^ 第2座包含第2A座及第2B座，第3座包含第3A座、第3B座及第3C座，第5座包含第5A座、第5B座及第5C座。

Note 1: Floodlights will be provided along the perimeter of the swimming pool for its lighting as required.

Note 2: There are existing vent shafts for the Mass Transit Railway above Tsuen Wan West Station which forms part of the Development.

Note 3: There may be backlit signboard and decoration lighting at the external walls of the Podium at lower levels of the Development below each tower of the Phase. The location of such signboard, lighting may be changed from time to time.

^ Tower 2 comprises Tower 2A and Tower 2B. Tower 3 comprises Tower 3A, Tower 3B and Tower 3C. Tower 5 comprises Tower 5A, Tower 5B and Tower 5C.