

Location plan of the development

發展項目的所在位置圖

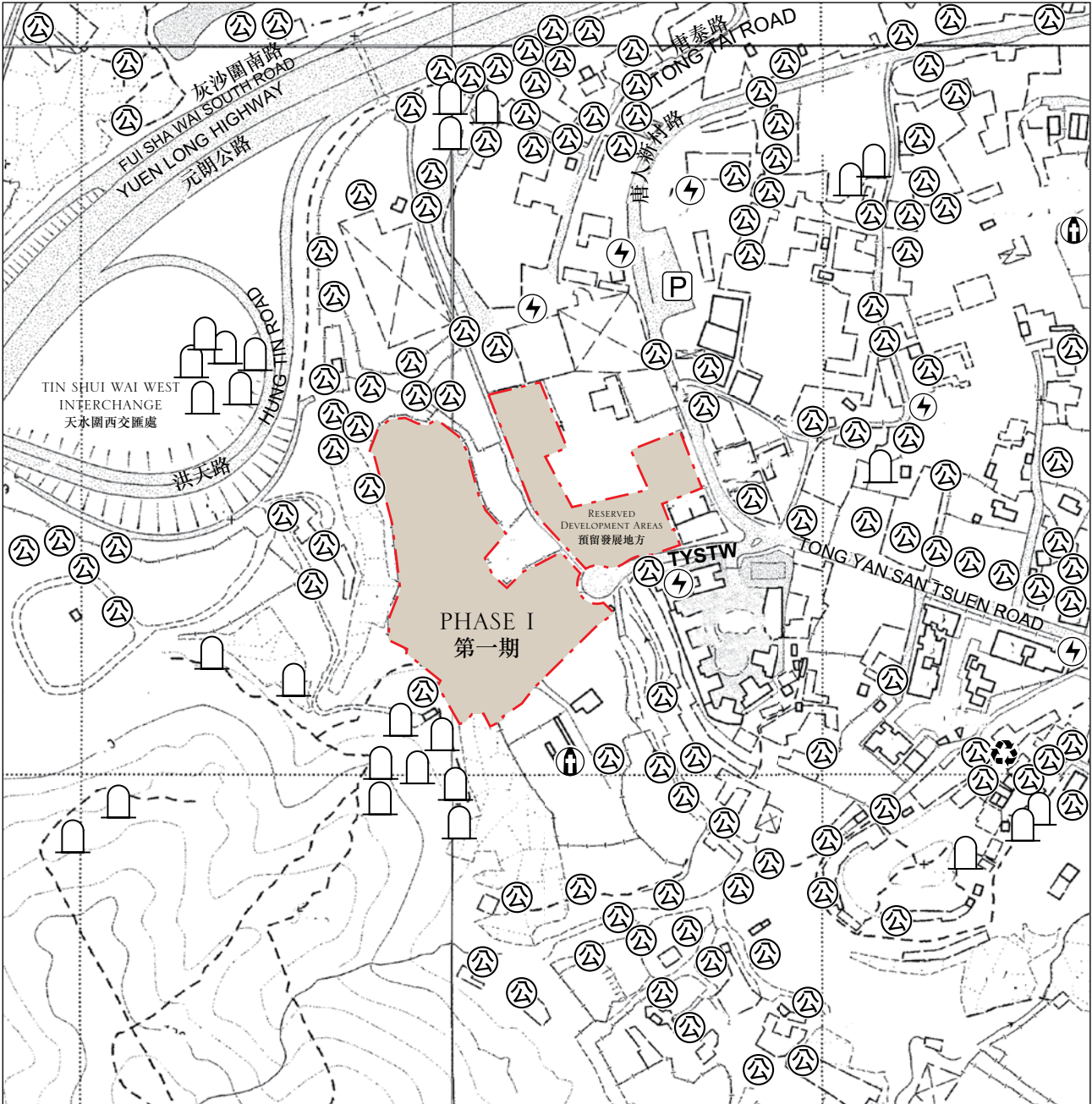

Scale: 0 200 400 600 Metres (米)
比例： 0 200 400 600 Metres (米)

Location of the Development
發展項目的位置



The Location Plan is prepared based on a reproduction of Survey Sheet Nos. 6-NW-A dated 28 March 2019, 6-NW-B dated 28 March 2019, 6-NW-C dated 28 March 2019 & 6-NW-D dated 28 March 2019 with adjustments where necessary.

所在位置圖依據日期為2019年3月28日之測繪圖(編號6-NW-A), 2019年3月28日之測繪圖(編號6-NW-B), 2019年3月28日之測繪圖(編號6-NW-C)及2019年3月28日之測繪圖(編號6-NW-D)複印後擬備, 有需要處經修正處理。

Legend 圖例

- Power plant (including electricity sub-stations)
發電廠 (包括電力分站)
- Cemetery
墳場
- Public carpark (including lorry park)
公眾停車場 (包括貨車停泊處)
- Public utility installation
公用事業設施裝置
- Religious institution (including church, temple and Tsz Tong)
宗教場所 (包括教堂、廟宇及祠堂)
- Refuse collection point
垃圾收集站

Street name not shown in full in the location plan
於所在位置圖未能顯示全名之街道

TYSTW Tong Yan San Tsuen West Road
唐人新村西路

- Remarks :
- Due to technical reasons as a result of the irregular boundary of the Development, the Location Plan has shown more than the area required under the Residential Properties (First-hand Sales) Ordinance.
 - The map reproduced with permission of the Director of Lands. © The Government of the Hong Kong SAR. Licence No. 5/2017.
 - The vendor advises prospective purchasers to conduct an on-site visit for a better understanding of the development site, its surrounding environment and the public facilities nearby.

- 備註：
- 因發展項目的不規則界線引致的技術原因，所在位置圖所顯示的範圍多於《一手住宅物業銷售條例》所要求。
 - 地圖版權屬香港特區政府，經地政總署准許複印，版權特許編號5/2017。
 - 賣方建議準買方到該發展地盤作實地考察，以對該發展地盤、其周邊地區環境及附近的公共設施有較佳了解。