

7 LOCATION PLAN OF THE DEVELOPMENT 發展項目的所在位置圖

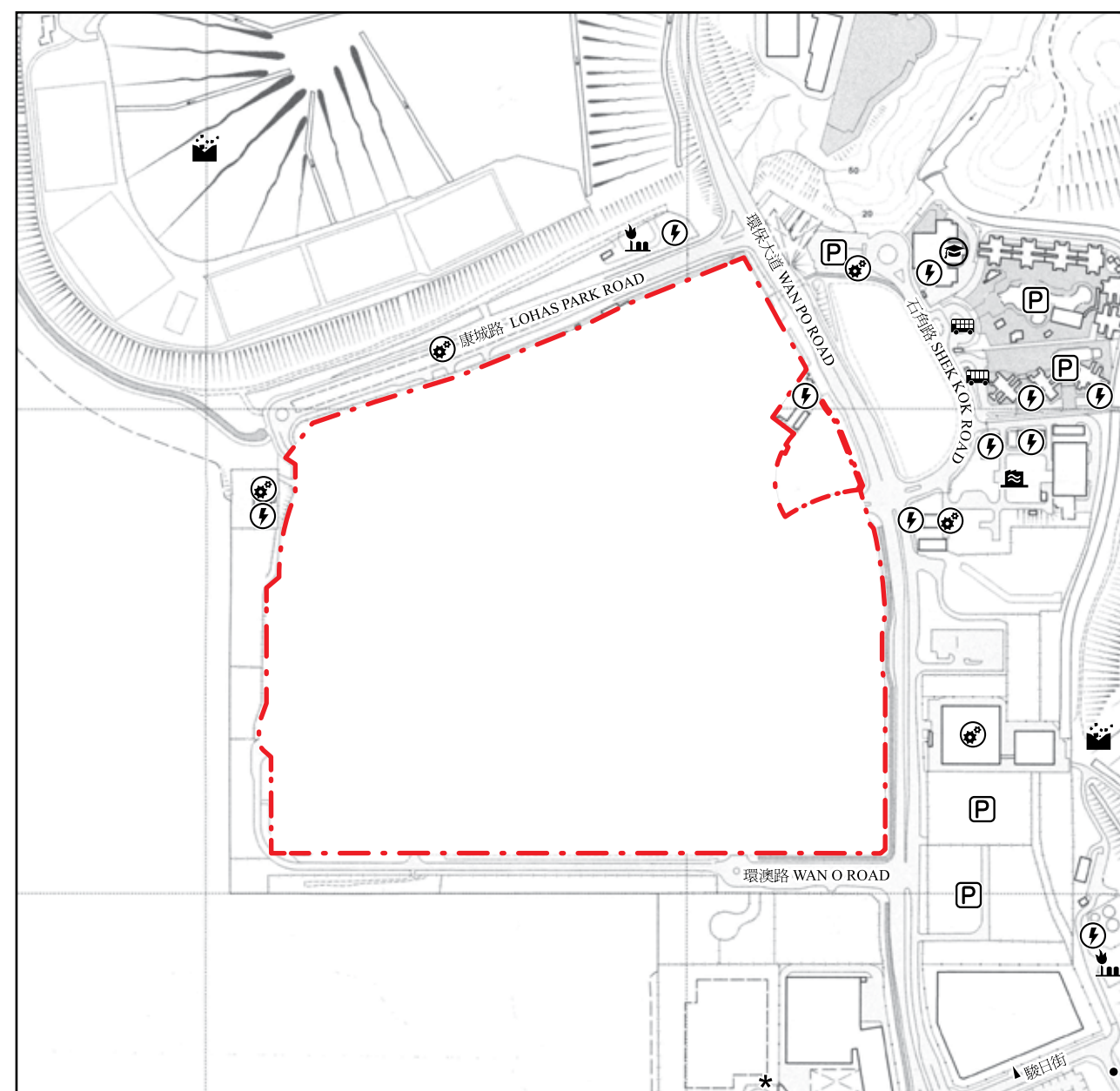

Location of the Development
發展項目的位置

Scale : 0M/米 250M/米
比例



Street name(s) not shown in full in the Location Plan of the Development:

於發展項目的所在位置圖未能完全顯示之街道全名：

- Chun Sing Street 駿昇街
- ▲ Chun Yat Street 駿日街
- * Chun Cheong Street 駿昌街

The Location Plan is made with reference to the Survey Sheet (Series HP5C) Sheet No. 12-SW-A dated 18th March 2019 from Survey and Mapping Office of the Lands Department with adjustments where necessary.

此發展項目的所在位置圖是參考於2019年3月18日出版之地政總署測繪處之測繪圖(組別編號HP5C)，圖幅編號12-SW-A編製，有需要處經修正處理。

NOTATION 圖例

- | | |
|--|--|
| Power Plant (including Electricity Sub-stations)
發電廠(包括電力分站) | Sewage Treatment Works and Facilities
污水處理廠及設施 |
| Public Carpark (including Lorry Park)
公眾停車場(包括貨車停泊處) | Landfills (including Ex-landfills)
堆填區(包括已停用的堆填區) |
| Public Transport Terminal (including Rail Station)
公共交通總站(包括鐵路車站) | Landfill Gas Flaring Plant
堆填區氣體燃燒廠 |
| Public Utility Installation
公用事業設施裝置 | School (including Kindergarten)
學校(包括幼稚園) |

The Government of the Hong Kong SAR has the copyright of the above plan. The map is reproduced with permission of the Director of Lands. © The Government of Hong Kong SAR. Licence No. 135/2017.

地圖版權屬香港特區政府，經地政總署准許複印，版權特許編號135/2017.

Notes:

- The vendor advises prospective purchasers to conduct an on-site visit for a better understanding of the development, its surrounding environment and the public facilities nearby.
- The plan may show more than the area required under the Residential Properties (First-hand Sales) Ordinance due to the technical reason that the boundary of the Development is irregular.

附註：

- 賣方建議準買家到該發展項目作實地考察，以對該發展項目、其周邊地區環境及附近的公共設施有較佳了解。
- 由於發展項目的邊界不規則的技術原因，此圖所顯示的範圍可能超過《一手住宅物業銷售條例》所規定的範圍。