

# Location plan of the development

## 發展項目的所在位置圖

The Location Plan is prepared based on a reproduction of Survey Sheet No. 6-SE-D dated 9 August 2019 with adjustments where necessary.

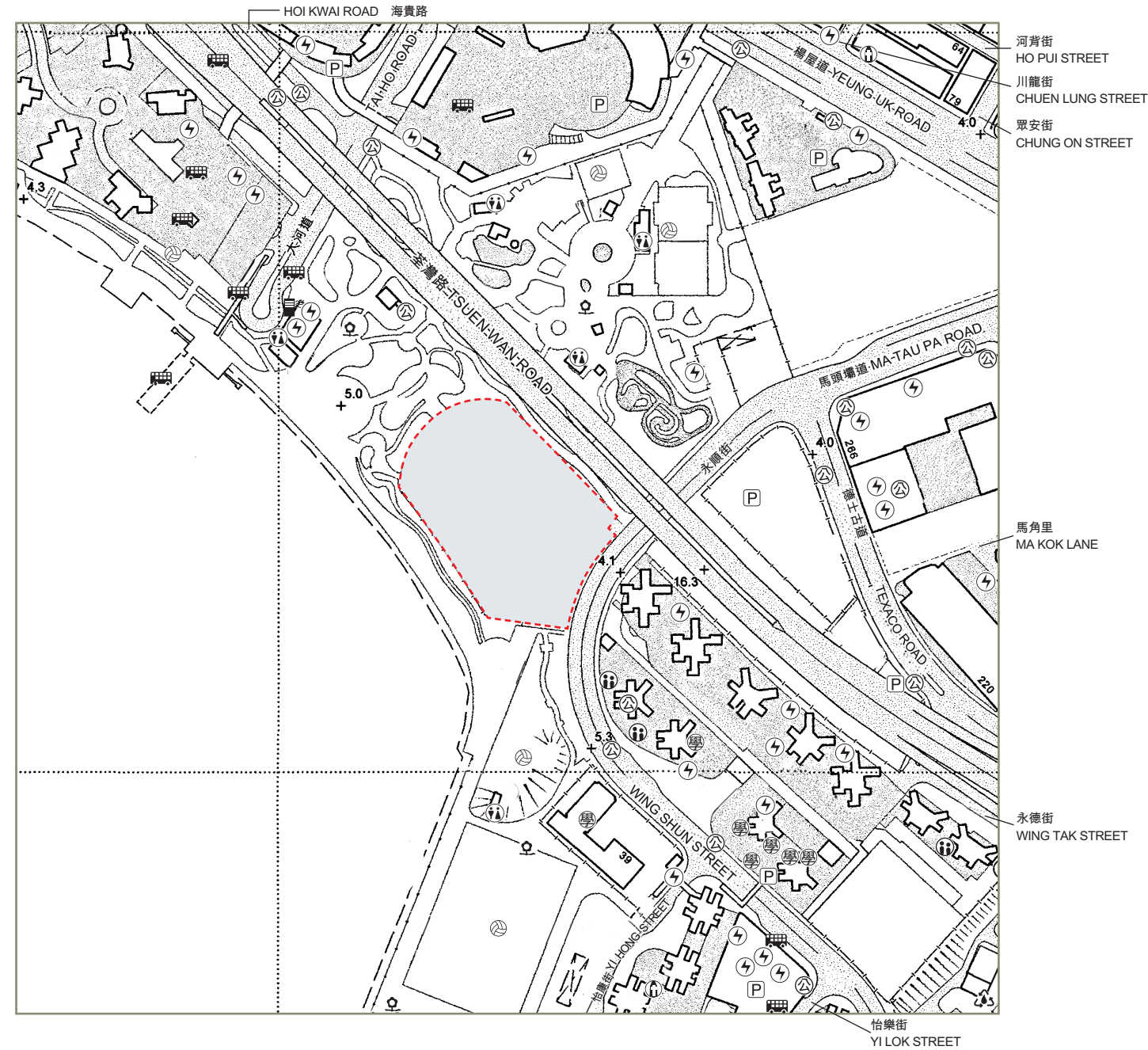







所在位置圖依據日期為2019年8月9日之測繪圖(編號6-SE-D)複印後擬備,有需要處經修正處理。



Scale 0 100 200 300 400 500M(米)  
比例

 Location of the Development  
發展項目的位置

### Legend 圖例

- |   |   |   |  |
|---|---|---|--|
|  | Ventilation shaft for the Mass Transit Railway<br>香港鐵路的通風井              |    | Public utility installation<br>公用事業設施裝置  |
|  | Sewage treatment works and facilities<br>污水處理廠及設施                       |    | Religious institution<br>(including church, temple and Tsz Tong)<br>宗教場所(包括教堂、廟宇及祠堂)                                 |
|  | Power plant (including electricity sub-stations)<br>發電廠(包括電力分站)         |    | School (including kindergarten)<br>學校(包括幼稚園)   |
|  | Public carpark (including lorry park)<br>公眾停車場(包括貨車停泊處)                 |    | Social welfare facilities (including elderly centre and<br>home for the mentally disabled)<br>社會福利設施(包括老人中心及弱智人士護理院) |
|  | Public convenience<br>公廁  |    | Sports facilities (including sports ground and<br>swimming pool)<br>體育設施(包括運動場及游泳池)                                  |
|  | Public transport terminal<br>(including rail station)<br>公共交通總站(包括鐵路車站) |  | Public park<br>公園  |

### Remarks :

1. Due to technical reasons as a result of the irregular boundary of the Development, the Location Plan has shown more than the area required under the Residential Properties (First-hand Sales) Ordinance.
2. The map reproduced with permission of the Director of Lands. © The Government of the Hong Kong SAR. Licence No. 49/2019.
3. The vendor advises prospective purchasers to conduct an on-site visit for a better understanding of the development site, its surrounding environment and the public facilities nearby.

### 備註:

1. 因發展項目的不規則界線引致的技術原因, 所在位置圖所顯示的範圍多於《一手住宅物業銷售條例》所要求。
2. 地圖版權屬香港特別行政區政府, 經地政總署准許複印, 版權特許編號49/2019。
3. 賣方建議準買方到該發展地盤作實地考察, 以對該發展地盤、其周邊地區環境及附近的公共設施有較佳了解。