

# Floor plans of residential properties in the development

## 發展項目的住宅物業的樓面平面圖

Remarks applicable to the floor plans in this section:

1. There are architectural features, aluminium cladding, metal grilles and/or exposed pipes on the external walls of some of the floors. For details, please refer to the latest approved building plans and/or approved drainage plans and/or other relevant plans.
2. Common pipes exposed and/or enclosed in cladding are located at/adjacent to the balcony and/or external wall of some residential properties and/or some of the flat roofs and/or air-conditioner platform of the Development. For details, please refer to the latest approved building plans and/or approved drainage plans and/or other relevant plans.
3. There are sunken slabs for mechanical and electrical services and/or ceiling/bulkheads for the air-conditioning fittings and/or mechanical and electrical services at some residential properties.
4. There are exposed pipes installed in some bathrooms.
5. Balconies and utility platforms are non-enclosed areas.
6. Symbols of fittings and fitments such as sink, water closet, shower area, sink counter and stove etc. in the floor plans are prepared based on the latest approved building plans and are for general indication only.

適用於本節之樓面平面圖之備註:

1. 部分樓層外牆範圍設有建築裝飾、鋁覆蓋板、金屬格柵及/或外露喉管，詳細資料請參考最新經批准的建築圖則及/或經批准的排水設施圖則及/或其他相關圖則。
2. 部分住宅物業的露台及/或外牆及/或發展項目的部份平台及/或空調機平台上/附近設有外露及/或外牆覆蓋板內藏之公用喉管，詳細資料請參考最新經批准的建築圖則及/或經批准的排水設施圖則及/或其他相關圖則。
3. 部分住宅物業有用以安裝機電設備的跌級樓板及/或用以裝置空調裝備及/或其他機電設備的天花板/裝飾橫樑。
4. 部分浴室內裝有外露喉管。
5. 露台及工作平台為不可封閉的地方。
6. 樓面平面圖上的裝置符號，如洗滌盆、坐廁、淋浴間、洗滌盆櫃及煮食爐等乃按最新的經批准的建築圖則繪製，只作一般示意用途。

## Legend for floor plans of residential properties in the Development

### 發展項目的住宅物業的樓面平面圖圖例

AF = Architectural Feature 建築裝飾

AP = Access Panel 檢修門

B = Bathroom 浴室

BAL = Balcony 露台

BR = Bedroom 睡房

D = Down 下

ED = Electric Cable Duct 電纜槽

EMC = Electric Meter Cabinet 電錶箱

EMR = Electric Meter Room 電錶房

EL ROOM = Electrical Room 電掣房

HR = Hose Reel 消防喉轆

LIV / DIN = Living / Dining Room 客/飯廳

MBR = Master Bedroom 主人睡房

OPEN KIT = Open Kitchen 開放式廚房

PW = Pipe Well 管道井

PD = Pipe Duct 管道槽

RSMRR = Refuse Storage and Material Recovery Room 垃圾及物料回收室

U = Up 上

UP = Utility Platform 工作平台

OW = Openable Window 可開啟式窗戶

WMC = Water Meter Cabinet 水錶箱

AB = Acoustic Balcony (Baffle Type) 減音露台 (擋音式)



AUP = Acoustic Utility Platform (Baffle Type) 減音工作平台 (擋音式)



AW = Acoustic Window (Baffle Type) 減音窗戶 (擋音式)

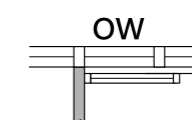

# Floor plans of residential properties in the development

## 發展項目的住宅物業的樓面平面圖

I/F  
1樓

Description 描述	Flat 單位						
	A1	A2	A5	A6	A7	A8	A9
Floor-to-floor height (refers to the height between the top surface of the structural slab of a floor and the top surface of the structural slab of its immediate upper floor) of each residential property (m) 每個住宅物業的層與層之間的高度(指該樓層之石屎地台面與上一層石屎地台面之高度距離)(米)	2.950		3.000	2.975	2.950	2.950	2.950
Thickness of the floor slabs (excluding plaster) of each residential property (mm) 每個住宅物業的樓板(不包括灰泥)厚度(毫米)	150		150, 175			150	

The internal areas of the residential properties on the upper floors will generally be slightly larger than those on the lower floors because of the reducing thickness of the structural walls on the upper floors. (This statement does not apply to the residential properties in the Development because the design of the Development is such that the reducing thickness of the structural walls of residential properties on the upper floors does not increase the internal areas of those residential properties.)

因住宅物業的較高樓層的結構牆的厚度遞減，較高樓層的內部面積，一般比較低樓層的內部面積稍大。(不適用於發展項目內的住宅物業，因為發展項目的設計是較高樓層的住宅物業的結構牆的厚度遞減不會增加該等住宅物業的內部面積。)

### Remarks :

- The dimensions in the floor plans are all structural dimensions in millimetre.
- For details of the noise mitigation measures, please refer to the Relevant Information section in this sales brochure.
- The floor-to-floor height (i.e. the height between the top surface of the surface of the structural slab of that floor (i.e. I/F) and the top surface of the structural slab of its immediate upper floor (i.e. 2/F)) includes, without limitation, a mass concrete fill with thickness of 250mm and 300mm located partly on top of the top surface of the structural slab of that floor (i.e. I/F).
- Please refer to Page 23 of this sales brochure for legend of the terms and abbreviations shown in the floor plan.

### 備註 :

- 樓面平面圖之尺規所列數字為以毫米標示之建築結構尺寸。
- 有關紓緩噪音措施之詳情，請參閱本售樓說明書的有關資料章節。
- 層與層之間的高度(指該樓層(即1樓)之石屎地台面與上一層石屎地台面(即2樓)之高度距離)包括但不限於厚度為250毫米及300毫米之混凝土填充層(該等混凝土填充層有部分位於該樓層(即1樓)之石屎地台面上)。
- 平面圖中顯示之名詞及簡稱之圖例請參閱本售樓說明書第23頁。

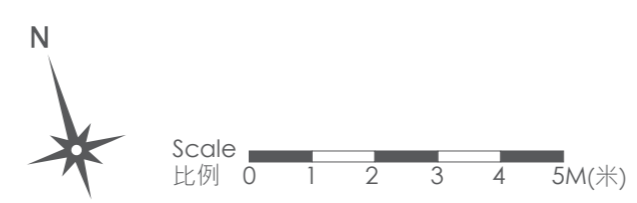
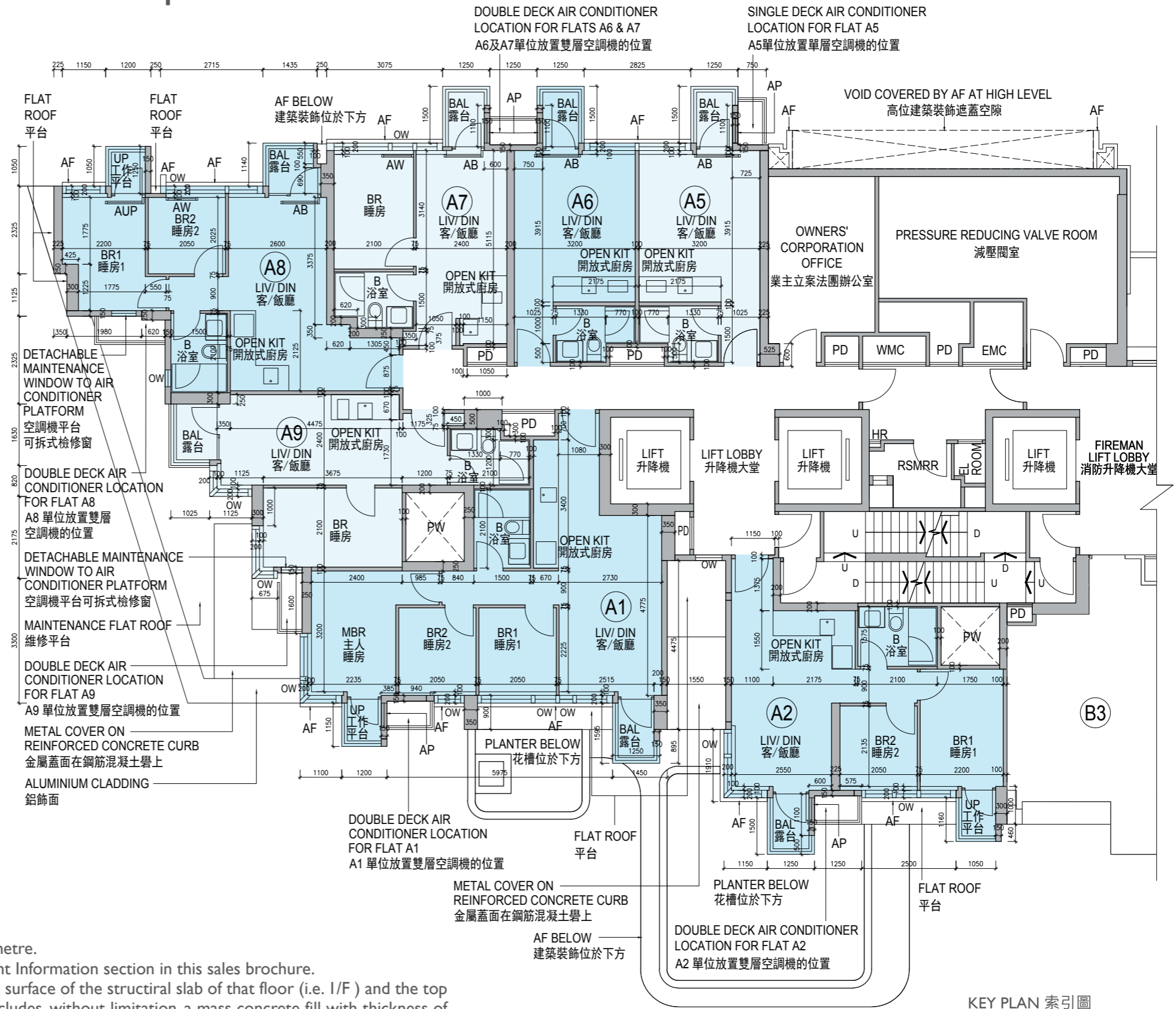

# Floor plans of residential properties in the development

## 發展項目的住宅物業的樓面平面圖

I/F  
1樓

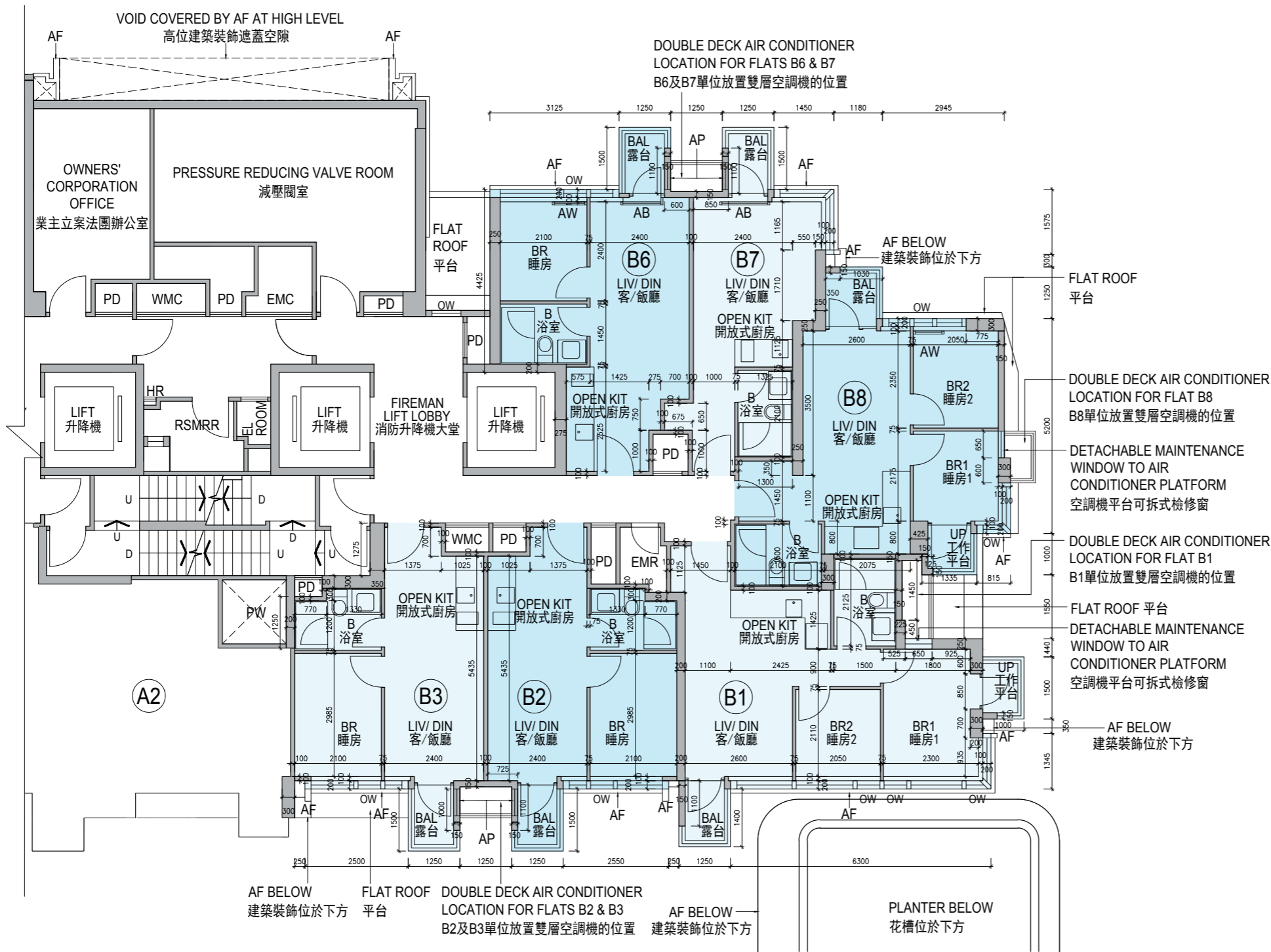

Description 描述	Flat 單位					
	B1	B2	B3	B6	B7	B8
Floor-to-floor height (refers to the height between the top surface of the structural slab of a floor and the top surface of the structural slab of its immediate upper floor) of each residential property (m) 每個住宅物業的層與層之間的高度(指該樓層之石屎地台面與上一層石屎地台面之高度距離)(米)					2.650	
	2.950				2.700	2.950
	3.250			3.000	2.950	3.000
	3.000			3.050	3.000	3.050
	3.300				3.050	3.300
Thickness of the floor slabs (excluding plaster) of each residential property (mm) 每個住宅物業的樓板(不包括灰泥)厚度(毫米)	150					

The internal areas of the residential properties on the upper floors will generally be slightly larger than those on the lower floors because of the reducing thickness of the structural walls on the upper floors. (This statement does not apply to the residential properties in the Development because the design of the Development is such that the reducing thickness of the structural walls of residential properties on the upper floors does not increase the internal areas of those residential properties.) 因住宅物業的較高樓層的結構牆的厚度遞減，較高樓層的內部面積，一般比較低樓層的內部面積稍大。(不適用於發展項目內的住宅物業，因為發展項目的設計是較高樓層的住宅物業的結構牆的厚度遞減不會增加該等住宅物業的內部面積。)

### Remarks :

- The dimensions in the floor plans are all structural dimensions in millimetre.
- For details of the noise mitigation measures, please refer to the Relevant Information section in this sales brochure.
- The floor-to-floor height (i.e. the height between the top surface of the surface of the structural slab of that floor (i.e. I/F) and the top surface of the structural slab of its immediate upper floor (i.e. 2/F)) includes, without limitation, a mass concrete fill with thickness of 250mm and 300mm located partly on top of the top surface of the structural slab of that floor (i.e. I/F).
- Please refer to Page 23 of this sales brochure for legend of the terms and abbreviations shown in the floor plan.

### 備註：

- 樓面平面圖之尺規所列數字為以毫米標示之建築結構尺寸。
- 有關紓緩噪音措施之詳情，請參閱本售樓說明書的有關資料章節。
- 層與層之間的高度(指該樓層(即1樓)之石屎地台面與上一層石屎地台面(即2樓)之高度距離)包括但不限於厚度為250毫米及300毫米之混凝土填充層(該等混凝土填充層有部分位於該樓層(即1樓)之石屎地台面上)。
- 平面圖中顯示之名詞及簡稱之圖例請參閱本售樓說明書第23頁。

KEY PLAN 索引圖

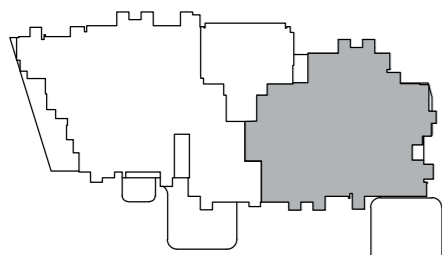

Scale 比例 0 1 2 3 4 5M(米)



# Floor plans of residential properties in the development

## 發展項目的住宅物業的樓面平面圖

2/F-3/F, 5/F-10/F (4/F is omitted)

2樓至3樓、5樓至10樓 (不設4樓)

Description 描述	Flat 單位							
	A1	A2	A3	A5	A6	A7	A8	A9
Floor-to-floor height (refers to the height between the top surface of the structural slab of a floor and the top surface of the structural slab of its immediate upper floor) of each residential property (m) 每個住宅物業的層與層之間的高度(指該樓層之石屎地台面與上一層石屎地台面之高度距離)(米)	3.000							
Thickness of the floor slabs (excluding plaster) of each residential property (mm) 每個住宅物業的樓板(不包括灰泥)厚度(毫米)	150	150, 175		150				

The internal areas of the residential properties on the upper floors will generally be slightly larger than those on the lower floors because of the reducing thickness of the structural walls on the upper floors. (This statement does not apply to the residential properties in the Development because the design of the Development is such that the reducing thickness of the structural walls of residential properties on the upper floors does not increase the internal areas of those residential properties.)

因住宅物業的較高樓層的結構牆的厚度遞減，較高樓層的內部面積，一般比較低樓層的內部面積稍大。(不適用於發展項目內的住宅物業，因為發展項目的設計是較高樓層的住宅物業的結構牆的厚度遞減不會增加該等住宅物業的內部面積。)

### Remarks :

- The dimensions in the floor plans are all structural dimensions in millimetre.
- For details of the noise mitigation measures, please refer to the Relevant Information section in this sales brochure.
- Please refer to Page 23 of this sales brochure for legend of the terms and abbreviations shown in the floor plan.

### 備註 :

- 樓面平面圖之尺規所列數字為以毫米標示之建築結構尺寸。
- 有關舒緩噪音措施之詳情，請參閱本售樓說明書的有關資料章節。
- 平面圖中顯示之名詞及簡稱之圖例請參閱本售樓說明書第23頁。

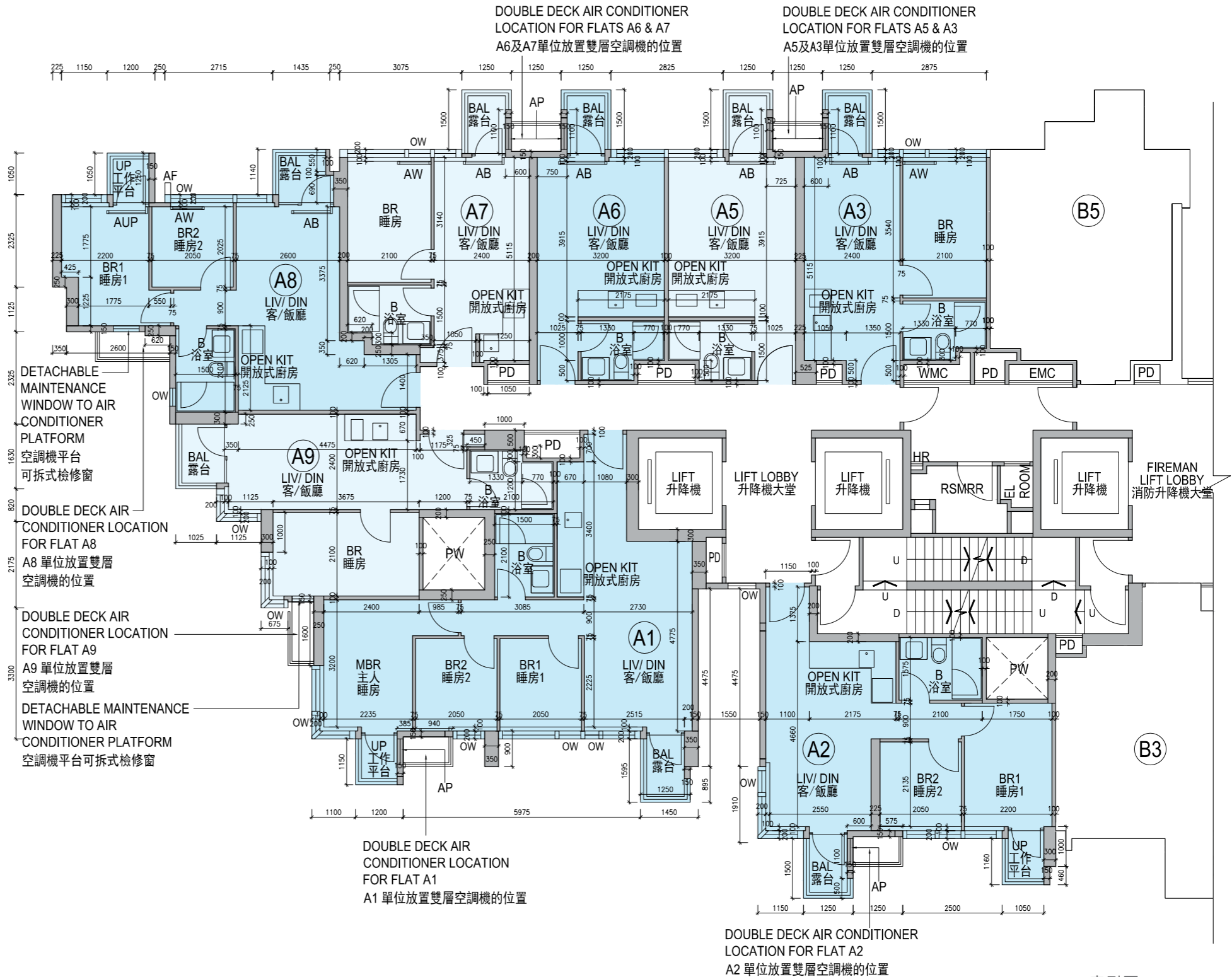

Scale 比例 0 1 2 3 4 5M(米)

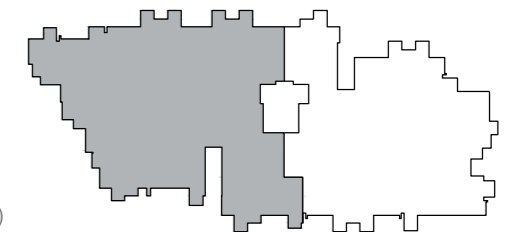

# Floor plans of residential properties in the development

## 發展項目的住宅物業的樓面平面圖

2/F-3/F, 5/F-10/F (4/F is omitted)  
2樓至3樓、5樓至10樓 (不設4樓)

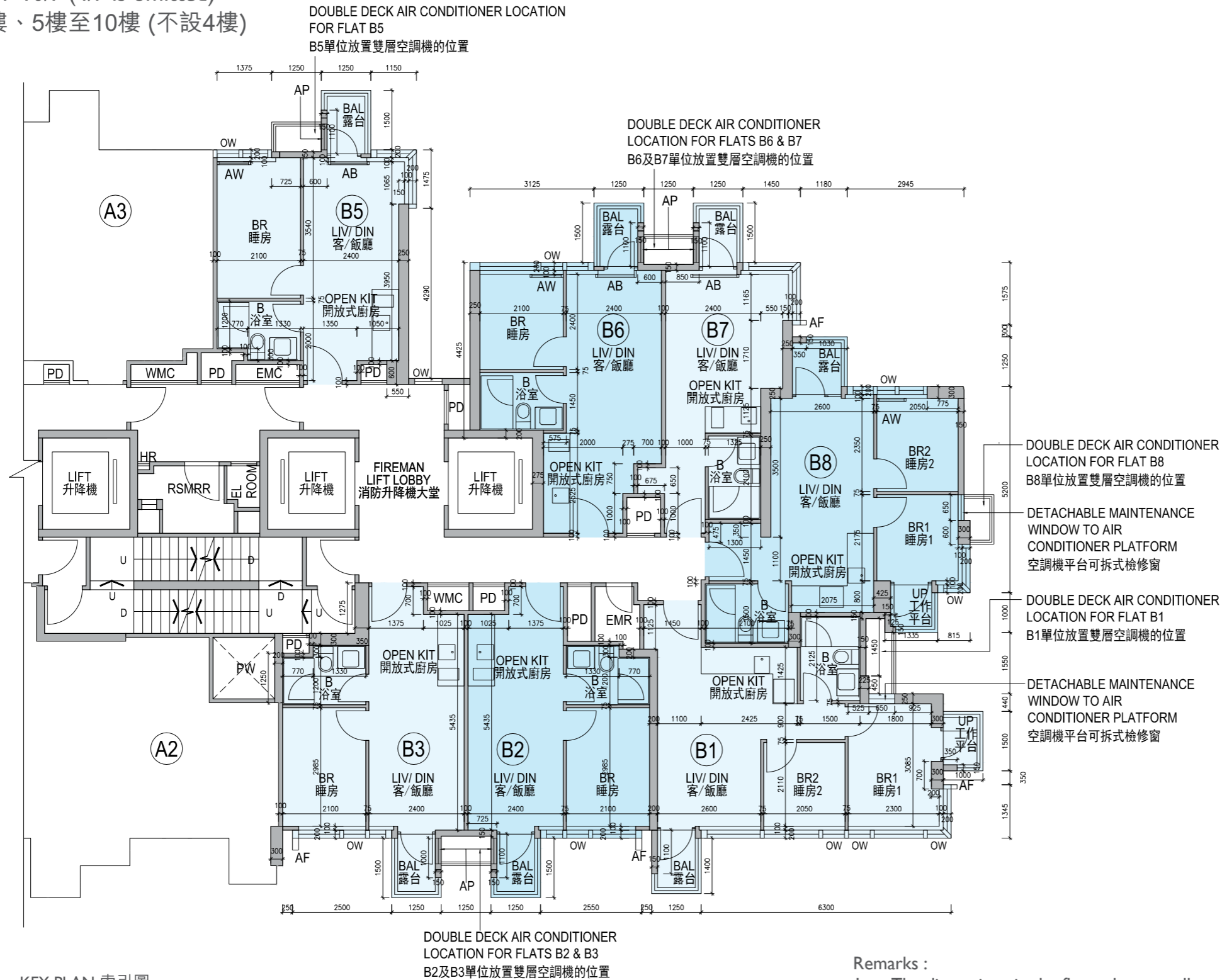

Description 描述	Flat 單位						
	B1	B2	B3	B5	B6	B7	B8
Floor-to-floor height (refers to the height between the top surface of the structural slab of a floor and the top surface of the structural slab of its immediate upper floor) of each residential property (m) 每個住宅物業的層與層之間的高度(指該樓層之石屎地台面與上一層石屎地台面之高度距離)(米)	3.000						
Thickness of the floor slabs (excluding plaster) of each residential property (mm) 每個住宅物業的樓板(不包括灰泥)厚度(毫米)	150						

The internal areas of the residential properties on the upper floors will generally be slightly larger than those on the lower floors because of the reducing thickness of the structural walls on the upper floors. (This statement does not apply to the residential properties in the Development because the design of the Development is such that the reducing thickness of the structural walls of residential properties on the upper floors does not increase the internal areas of those residential properties.)

因住宅物業的較高樓層的結構牆的厚度遞減，較高樓層的內部面積，一般比較低樓層的內部面積稍大。(不適用於發展項目內的住宅物業，因為發展項目的設計是較高樓層的住宅物業的結構牆的厚度遞減不會增加該等住宅物業的內部面積。)

### Remarks :

- The dimensions in the floor plans are all structural dimensions in millimetre.
- For details of the noise mitigation measures, please refer to the Relevant Information section in this sales brochure.
- Please refer to Page 23 of this sales brochure for legend of the terms and abbreviations shown in the floor plan.

### 備註 :

- 樓面平面圖之尺規所列數字為以毫米標示之建築結構尺寸。
- 有關紓緩噪音措施之詳情，請參閱本售樓說明書的有關資料章節。
- 平面圖中顯示之名詞及簡稱之圖例請參閱本售樓說明書第23頁。

# Floor plans of residential properties in the development

## 發展項目的住宅物業的樓面平面圖

11/F-12/F, 15/F-17/F (13/F & 14/F are omitted)

11樓至12樓、15樓至17樓 (不設13樓及14樓)

Description 描述	Flat 單位							
	A1	A2	A3	A5	A6	A7	A8	A9
Floor-to-floor height (refers to the height between the top surface of the structural slab of a floor and the top surface of the structural slab of its immediate upper floor) of each residential property (m) 每個住宅物業的層與層之間的高度(指該樓層之石屎地台面與上一層石屎地台面之高度距離)(米)	3.000							
Thickness of the floor slabs (excluding plaster) of each residential property (mm) 每個住宅物業的樓板(不包括灰泥)厚度(毫米)	150	150, 175					150	

The internal areas of the residential properties on the upper floors will generally be slightly larger than those on the lower floors because of the reducing thickness of the structural walls on the upper floors. (This statement does not apply to the residential properties in the Development because the design of the Development is such that the reducing thickness of the structural walls of residential properties on the upper floors does not increase the internal areas of those residential properties.)

因住宅物業的較高樓層的結構牆的厚度遞減，較高樓層的內部面積，一般比較低樓層的內部面積稍大。(不適用於發展項目內的住宅物業，因為發展項目的設計是較高樓層的住宅物業的結構牆的厚度遞減不會增加該等住宅物業的內部面積。)

### Remarks :

- The dimensions in the floor plans are all structural dimensions in millimetre.
- For details of the noise mitigation measures, please refer to the Relevant Information section in this sales brochure.
- Please refer to Page 23 of this sales brochure for legend of the terms and abbreviations shown in the floor plan.

### 備註：

- 樓面平面圖之尺規所列數字為以毫米標示之建築結構尺寸。
- 有關紓緩噪音措施之詳情，請參閱本售樓說明書的有關資料章節。
- 平面圖中顯示之名詞及簡稱之圖例請參閱本售樓說明書第23頁。

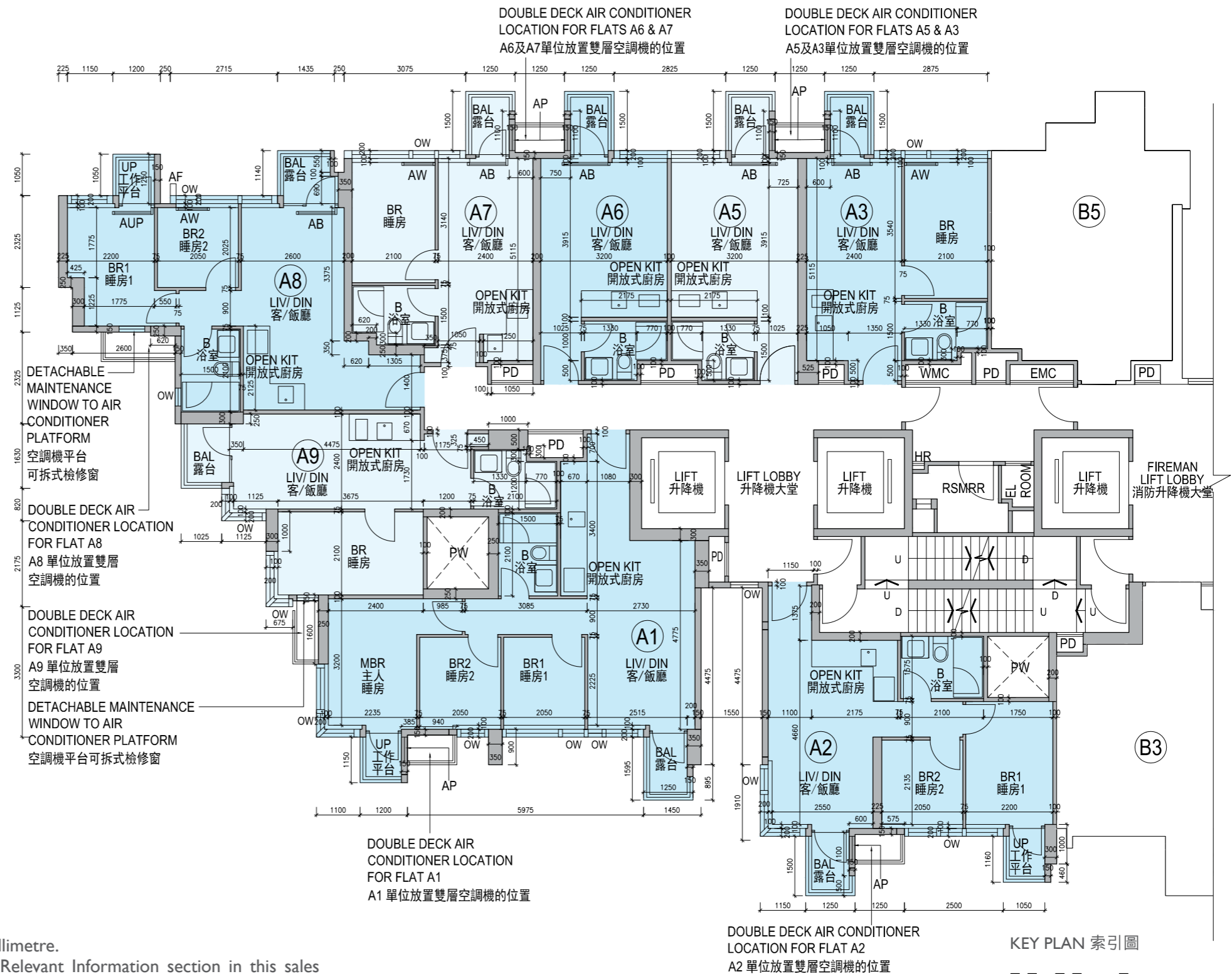

# Floor plans of residential properties in the development

## 發展項目的住宅物業的樓面平面圖

11/F-12/F, 15/F-17/F (13/F & 14/F are omitted)

11樓至12樓、15樓至17樓 (不設13樓及14樓)

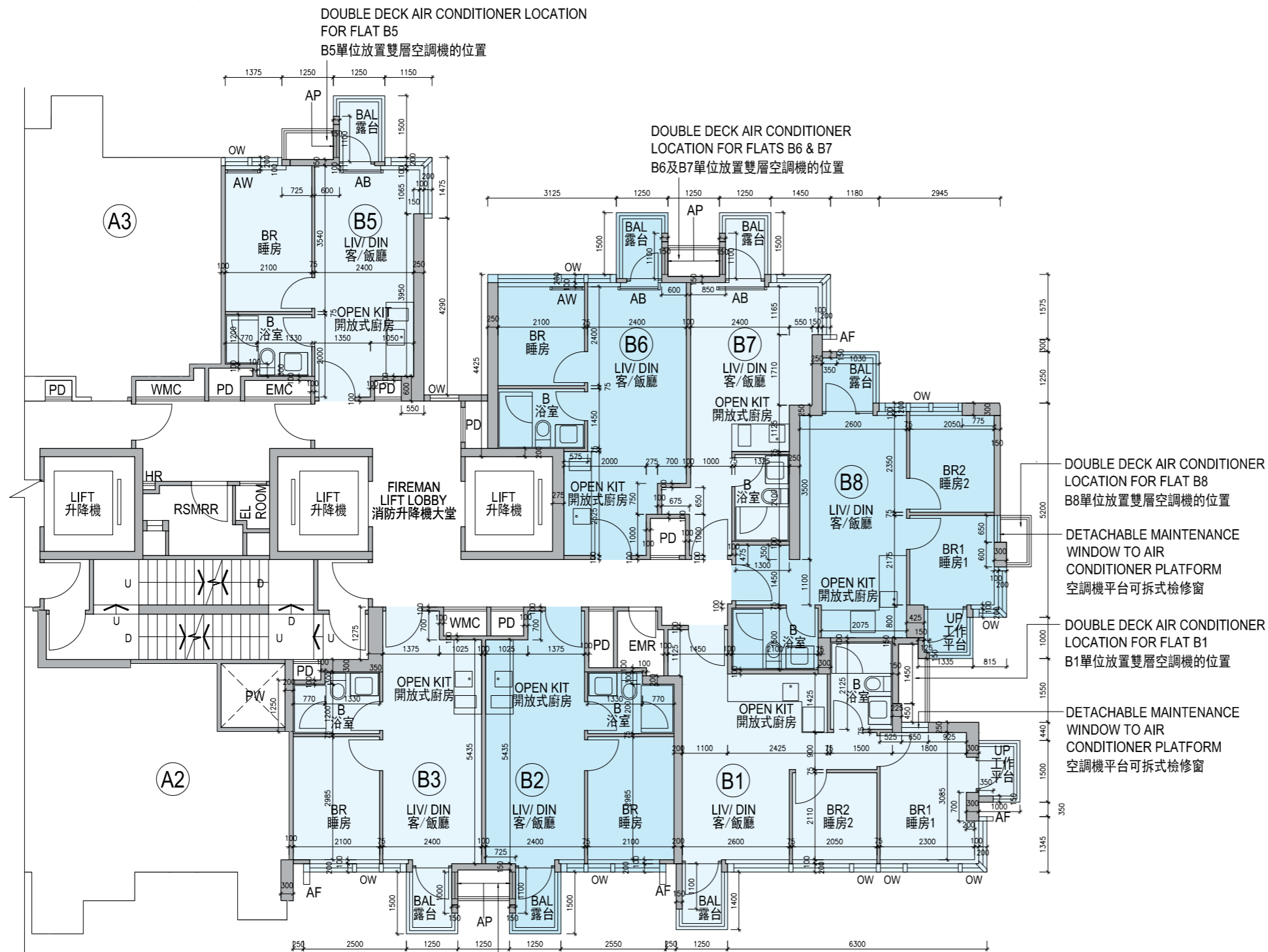

KEY PLAN 索引圖

DOUBLE DECK AIR CONDITIONER LOCATION FOR FLATS B2 & B3  
B2及B3單位放置雙層空調機的位置

Remarks :

- The dimensions in the floor plans are all structural dimensions in millimetre.
- For details of the noise mitigation measures, please refer to the Relevant Information section in this sales brochure.
- Please refer to Page 23 of this sales brochure for legend of the terms and abbreviations shown in the floor plan.

備註 :

- 樓面平面圖之尺規所列數字為以毫米標示之建築結構尺寸。
- 有關紓緩噪音措施之詳情，請參閱本售樓說明書的有關資料章節。
- 平面圖中顯示之名詞及簡稱之圖例請參閱本售樓說明書第23頁。

Description 描述	Flat 單位						
	B1	B2	B3	B5	B6	B7	B8
Floor-to-floor height (refers to the height between the top surface of the structural slab of a floor and the top surface of the structural slab of its immediate upper floor) of each residential property (m) 每個住宅物業的層與層之間的高度(指該樓層之石屎地台面與上一層石屎地台面之高度距離) (米)	3.000						
Thickness of the floor slabs (excluding plaster) of each residential property (mm) 每個住宅物業的樓板(不包括灰泥)厚度 (毫米)	150						

The internal areas of the residential properties on the upper floors will generally be slightly larger than those on the lower floors because of the reducing thickness of the structural walls on the upper floors. (This statement does not apply to the residential properties in the Development because the design of the Development is such that the reducing thickness of the structural walls of residential properties on the upper floors does not increase the internal areas of those residential properties.)

因住宅物業的較高樓層的結構牆的厚度遞減，較高樓層的內部面積，一般比較低樓層的內部面積稍大。(不適用於發展項目內的住宅物業，因為發展項目的設計是較高樓層的住宅物業的結構牆的厚度遞減不會增加該等住宅物業的內部面積。)

# Floor plans of residential properties in the development

## 發展項目的住宅物業的樓面平面圖

18/F  
18樓

Description 描述	Flat 單位							
	A1	A2	A3	A5	A6	A7	A8	A9
Floor-to-floor height (refers to the height between the top surface of the structural slab of a floor and the top surface of the structural slab of its immediate upper floor) of each residential property (m) 每個住宅物業的層與層之間的高度(指該樓層之石屎地台面與上一層石屎地台面之高度距離)(米)	3.000							
Thickness of the floor slabs (excluding plaster) of each residential property (mm) 每個住宅物業的樓板(不包括灰泥)厚度(毫米)	150	150	175	150	150	150	150	150

The internal areas of the residential properties on the upper floors will generally be slightly larger than those on the lower floors because of the reducing thickness of the structural walls on the upper floors. (This statement does not apply to the residential properties in the Development because the design of the Development is such that the reducing thickness of the structural walls of residential properties on the upper floors does not increase the internal areas of those residential properties.)

因住宅物業的較高樓層的結構牆的厚度遞減，較高樓層的內部面積，一般比較低樓層的內部面積稍大。(不適用於發展項目內的住宅物業，因為發展項目的設計是較高樓層的住宅物業的結構牆的厚度遞減不會增加該等住宅物業的內部面積。)

### Remarks :

- The dimensions in the floor plans are all structural dimensions in millimetre.
- For details of the noise mitigation measures, please refer to the Relevant Information section in this sales brochure.
- Please refer to Page 23 of this sales brochure for legend of the terms and abbreviations shown in the floor plan.

### 備註 :

- 樓面平面圖之尺規所列數字為以毫米標示之建築結構尺寸。
- 有關舒緩噪音措施之詳情，請參閱本售樓說明書的有關資料章節。
- 平面圖中顯示之名詞及簡稱之圖例請參閱本售樓說明書第23頁。

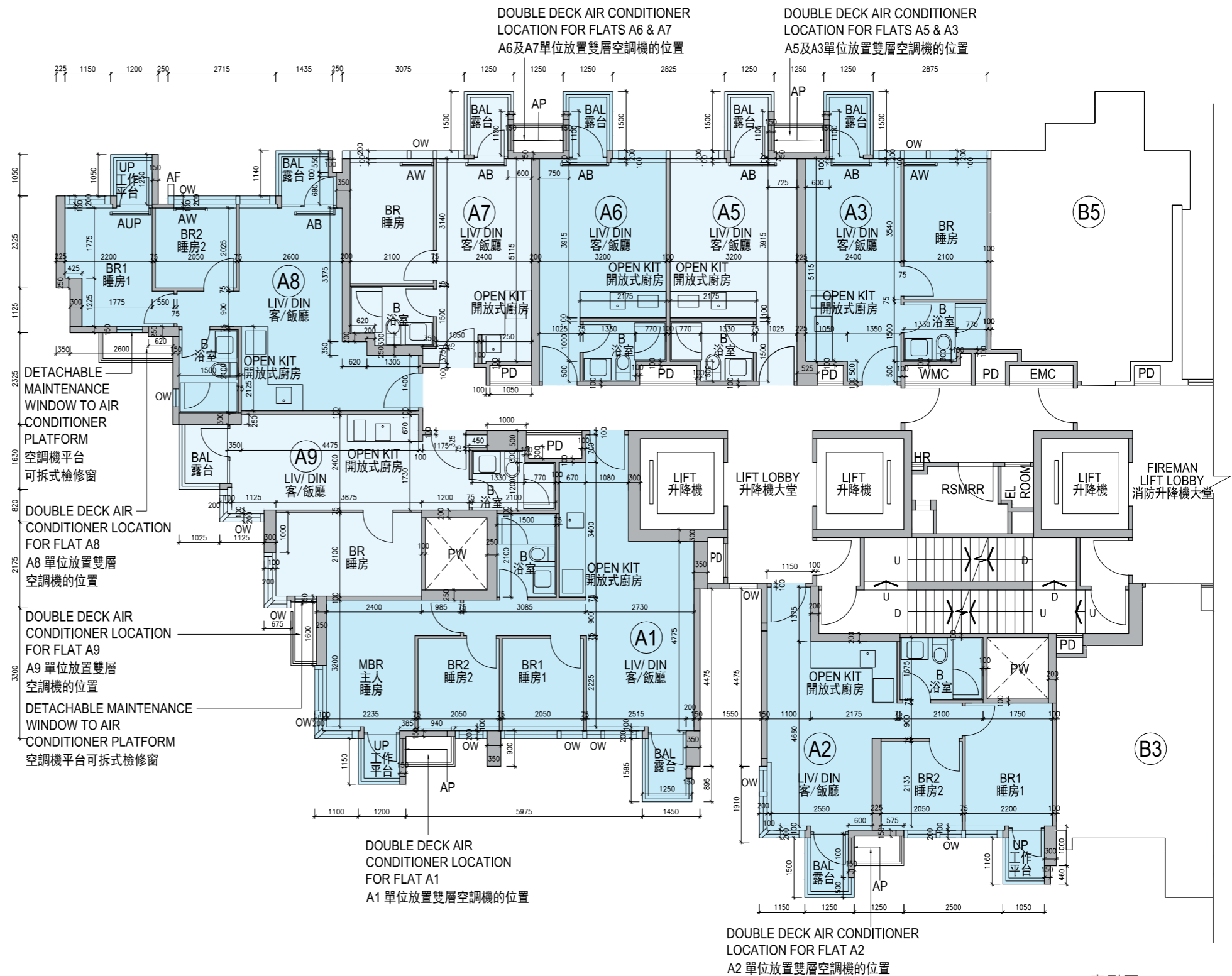

Scale 比例 0 1 2 3 4 5M(米)

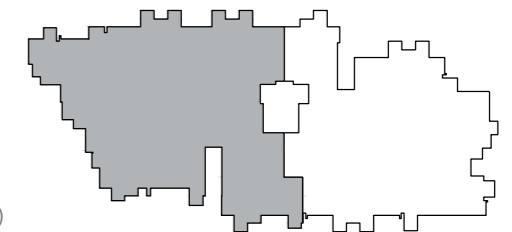



# Floor plans of residential properties in the development

## 發展項目的住宅物業的樓面平面圖

18/F  
18樓

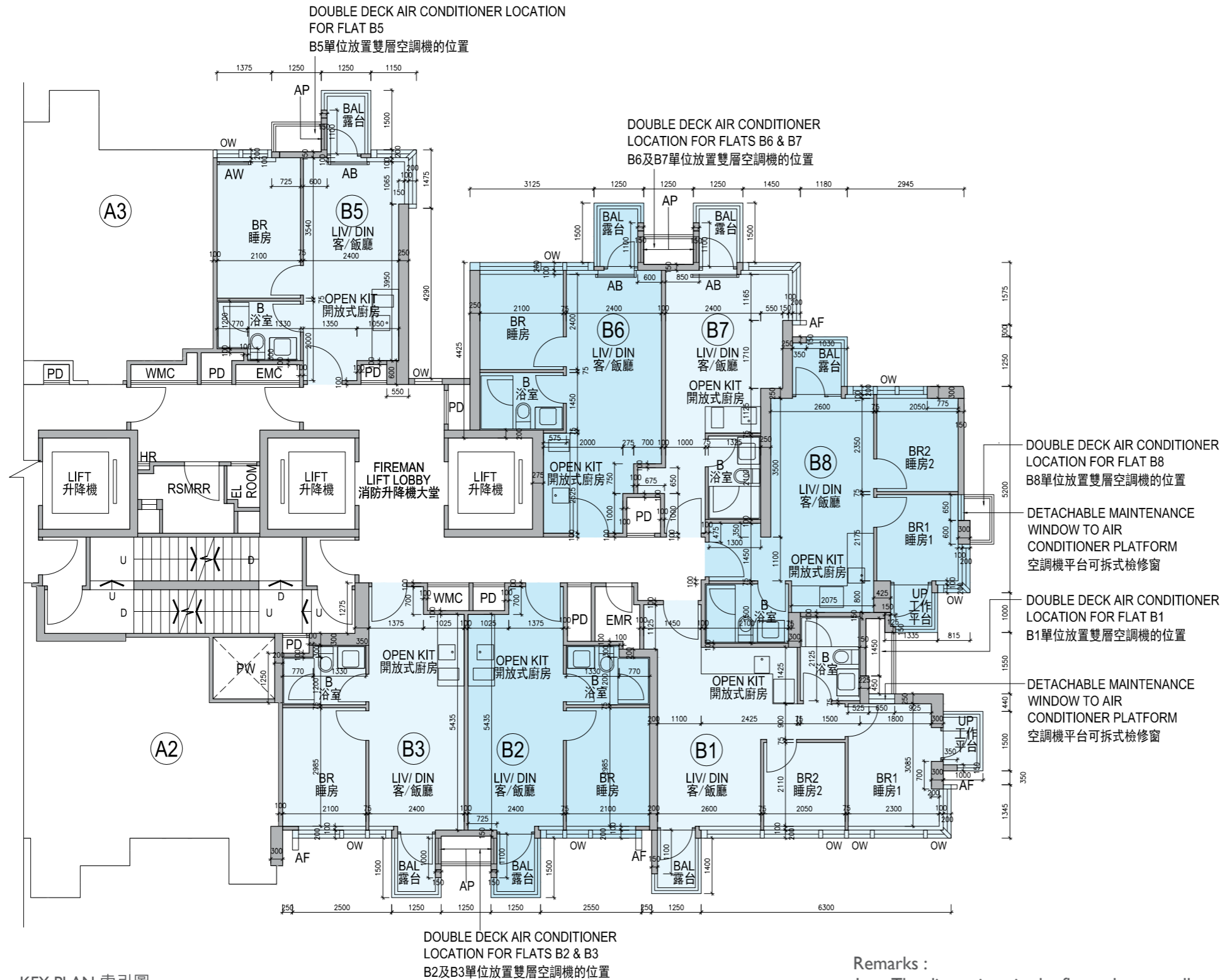

Description 描述	Flat 單位						
	B1	B2	B3	B5	B6	B7	B8
Floor-to-floor height (refers to the height between the top surface of the structural slab of a floor and the top surface of the structural slab of its immediate upper floor) of each residential property (m) 每個住宅物業的層與層之間的高度(指該樓層之石屎地台面與上一層石屎地台面之高度距離)(米)	3.000						
Thickness of the floor slabs (excluding plaster) of each residential property (mm) 每個住宅物業的樓板(不包括灰泥)厚度(毫米)	150						

The internal areas of the residential properties on the upper floors will generally be slightly larger than those on the lower floors because of the reducing thickness of the structural walls on the upper floors. (This statement does not apply to the residential properties in the Development because the design of the Development is such that the reducing thickness of the structural walls of residential properties on the upper floors does not increase the internal areas of those residential properties.)

因住宅物業的較高樓層的結構牆的厚度遞減，較高樓層的內部面積，一般比較低樓層的內部面積稍大。(不適用於發展項目內的住宅物業，因為發展項目的設計是較高樓層的住宅物業的結構牆的厚度遞減不會增加該等住宅物業的內部面積。)

### Remarks :

- The dimensions in the floor plans are all structural dimensions in millimetre.
- For details of the noise mitigation measures, please refer to the Relevant Information section in this sales brochure.
- Please refer to Page 23 of this sales brochure for legend of the terms and abbreviations shown in the floor plan.

### 備註 :

- 樓面平面圖之尺規所列數字為以毫米標示之建築結構尺寸。
- 有關紓緩噪音措施之詳情，請參閱本售樓說明書的有關資料章節。
- 平面圖中顯示之名詞及簡稱之圖例請參閱本售樓說明書第23頁。

# Floor plans of residential properties in the development

## 發展項目的住宅物業的樓面平面圖

19/F  
19樓

Description 描述	Flat 單位							
	A1	A2	A3	A5	A6	A7	A8	A9
Floor-to-floor height (refers to the height between the top surface of the structural slab of a floor and the top surface of the structural slab of its immediate upper floor) of each residential property (m) 每個住宅物業的層與層之間的高度(指該樓層之石屎地台面與上一層石屎地台面之高度距離)(米)	3.000							
Thickness of the floor slabs (excluding plaster) of each residential property (mm) 每個住宅物業的樓板(不包括灰泥)厚度(毫米)	150			150, 175			150	

The internal areas of the residential properties on the upper floors will generally be slightly larger than those on the lower floors because of the reducing thickness of the structural walls on the upper floors. (This statement does not apply to the residential properties in the Development because the design of the Development is such that the reducing thickness of the structural walls of residential properties on the upper floors does not increase the internal areas of those residential properties.)

因住宅物業的較高樓層的結構牆的厚度遞減，較高樓層的內部面積，一般比較低樓層的內部面積稍大。(不適用於發展項目內的住宅物業，因為發展項目的設計是較高樓層的住宅物業的結構牆的厚度遞減不會增加該等住宅物業的內部面積。)

### Remarks :

- The dimensions in the floor plans are all structural dimensions in millimetre.
- For details of the noise mitigation measures, please refer to the Relevant Information section in this sales brochure.
- Please refer to Page 23 of this sales brochure for legend of the terms and abbreviations shown in the floor plan.

### 備註 :

- 樓面平面圖之尺規所列數字為以毫米標示之建築結構尺寸。
- 有關舒緩噪音措施之詳情，請參閱本售樓說明書的有關資料章節。
- 平面圖中顯示之名詞及簡稱之圖例請參閱本售樓說明書第23頁。

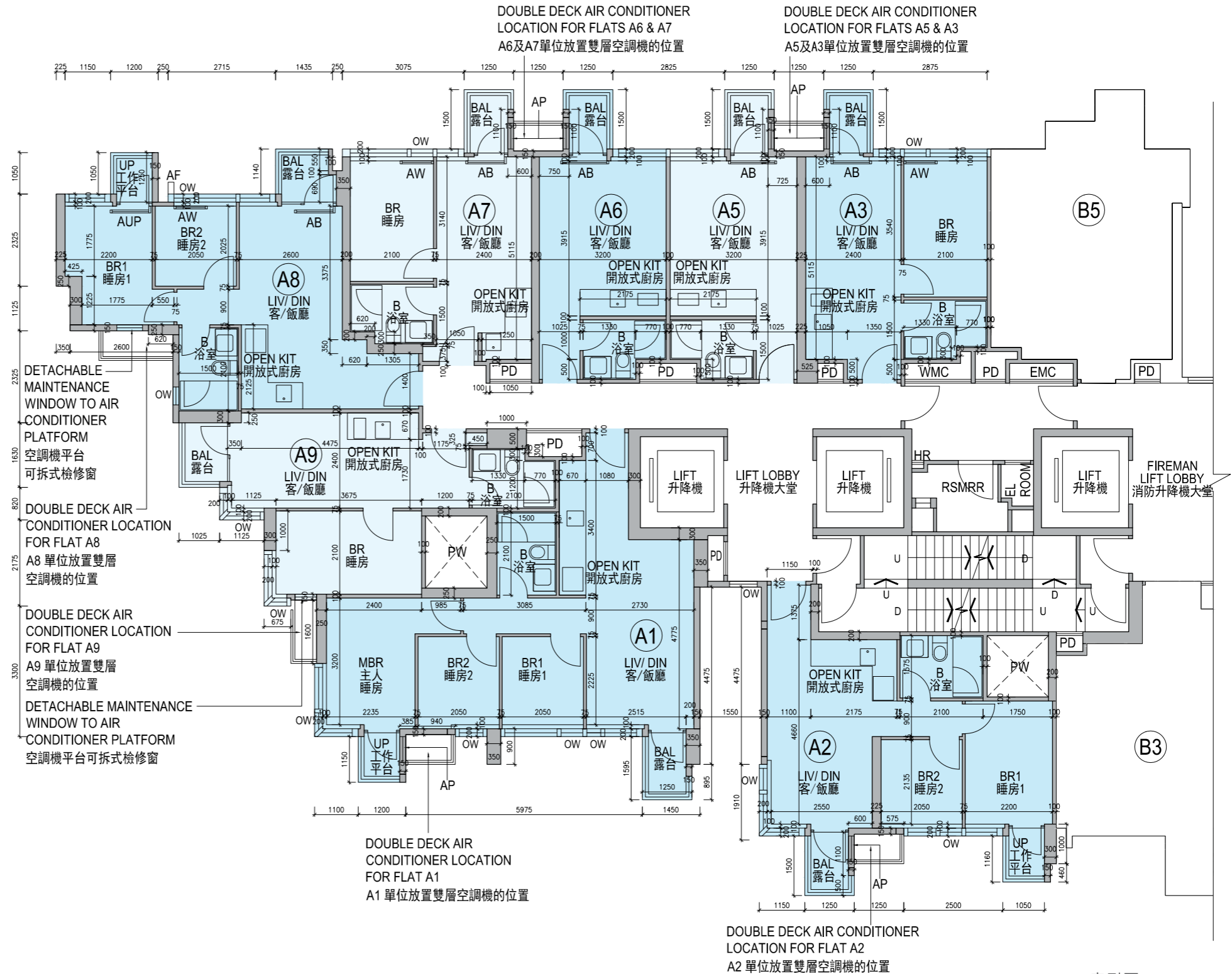

Scale 比例 0 1 2 3 4 5M(米)

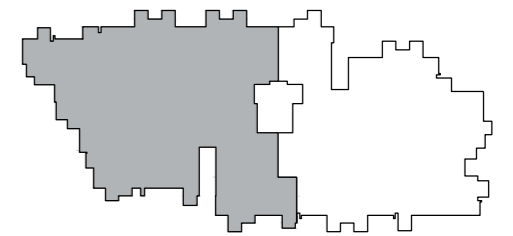

# Floor plans of residential properties in the development

## 發展項目的住宅物業的樓面平面圖

19/F  
19樓

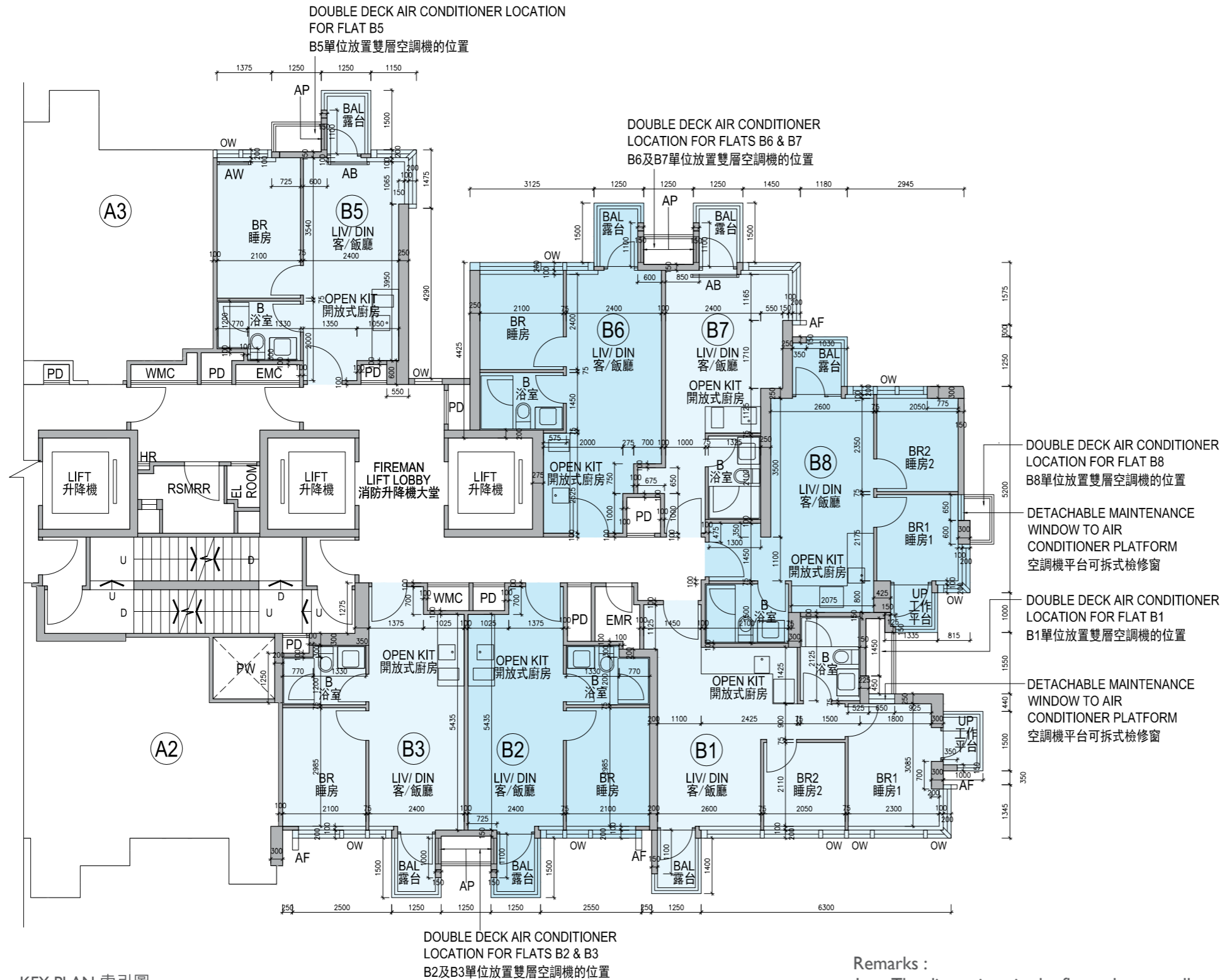

Description 描述	Flat 單位						
	B1	B2	B3	B5	B6	B7	B8
Floor-to-floor height (refers to the height between the top surface of the structural slab of a floor and the top surface of the structural slab of its immediate upper floor) of each residential property (m) 每個住宅物業的層與層之間的高度(指該樓層之石屎地台面與上一層石屎地台面之高度距離)(米)	3.000						
Thickness of the floor slabs (excluding plaster) of each residential property (mm) 每個住宅物業的樓板(不包括灰泥)厚度(毫米)	150						

The internal areas of the residential properties on the upper floors will generally be slightly larger than those on the lower floors because of the reducing thickness of the structural walls on the upper floors. (This statement does not apply to the residential properties in the Development because the design of the Development is such that the reducing thickness of the structural walls of residential properties on the upper floors does not increase the internal areas of those residential properties.)

因住宅物業的較高樓層的結構牆的厚度遞減，較高樓層的內部面積，一般比較低樓層的內部面積稍大。(不適用於發展項目內的住宅物業，因為發展項目的設計是較高樓層的住宅物業的結構牆的厚度遞減不會增加該等住宅物業的內部面積。)

Remarks :

- The dimensions in the floor plans are all structural dimensions in millimetre.
- For details of the noise mitigation measures, please refer to the Relevant Information section in this sales brochure.
- Please refer to Page 23 of this sales brochure for legend of the terms and abbreviations shown in the floor plan.

備註：

- 樓面平面圖之尺規所列數字為以毫米標示之建築結構尺寸。
- 有關紓緩噪音措施之詳情，請參閱本售樓說明書的有關資料章節。
- 平面圖中顯示之名詞及簡稱之圖例請參閱本售樓說明書第23頁。

# Floor plans of residential properties in the development

## 發展項目的住宅物業的樓面平面圖

20/F  
20樓

Description 描述	Flat 單位							
	A1	A2	A3	A5	A6	A7	A8	A9
Floor-to-floor height (refers to the height between the top surface of the structural slab of a floor and the top surface of the structural slab of its immediate upper floor) of each residential property (m) 每個住宅物業的層與層之間的高度(指該樓層之石屎地台面與上一層石屎地台面之高度距離)(米)	3.000							
Thickness of the floor slabs (excluding plaster) of each residential property (mm) 每個住宅物業的樓板(不包括灰泥)厚度(毫米)	150	150, 175						150

The internal areas of the residential properties on the upper floors will generally be slightly larger than those on the lower floors because of the reducing thickness of the structural walls on the upper floors. (This statement does not apply to the residential properties in the Development because the design of the Development is such that the reducing thickness of the structural walls of residential properties on the upper floors does not increase the internal areas of those residential properties.)

因住宅物業的較高樓層的結構牆的厚度遞減，較高樓層的內部面積，一般比較低樓層的內部面積稍大。(不適用於發展項目內的住宅物業，因為發展項目的設計是較高樓層的住宅物業的結構牆的厚度遞減不會增加該等住宅物業的內部面積。)

### Remarks :

- The dimensions in the floor plans are all structural dimensions in millimetre.
- For details of the noise mitigation measures, please refer to the Relevant Information section in this sales brochure.
- Please refer to Page 23 of this sales brochure for legend of the terms and abbreviations shown in the floor plan.

### 備註 :

- 樓面平面圖之尺規所列數字為以毫米標示之建築結構尺寸。
- 有關舒緩噪音措施之詳情，請參閱本售樓說明書的有關資料章節。
- 平面圖中顯示之名詞及簡稱之圖例請參閱本售樓說明書第23頁。

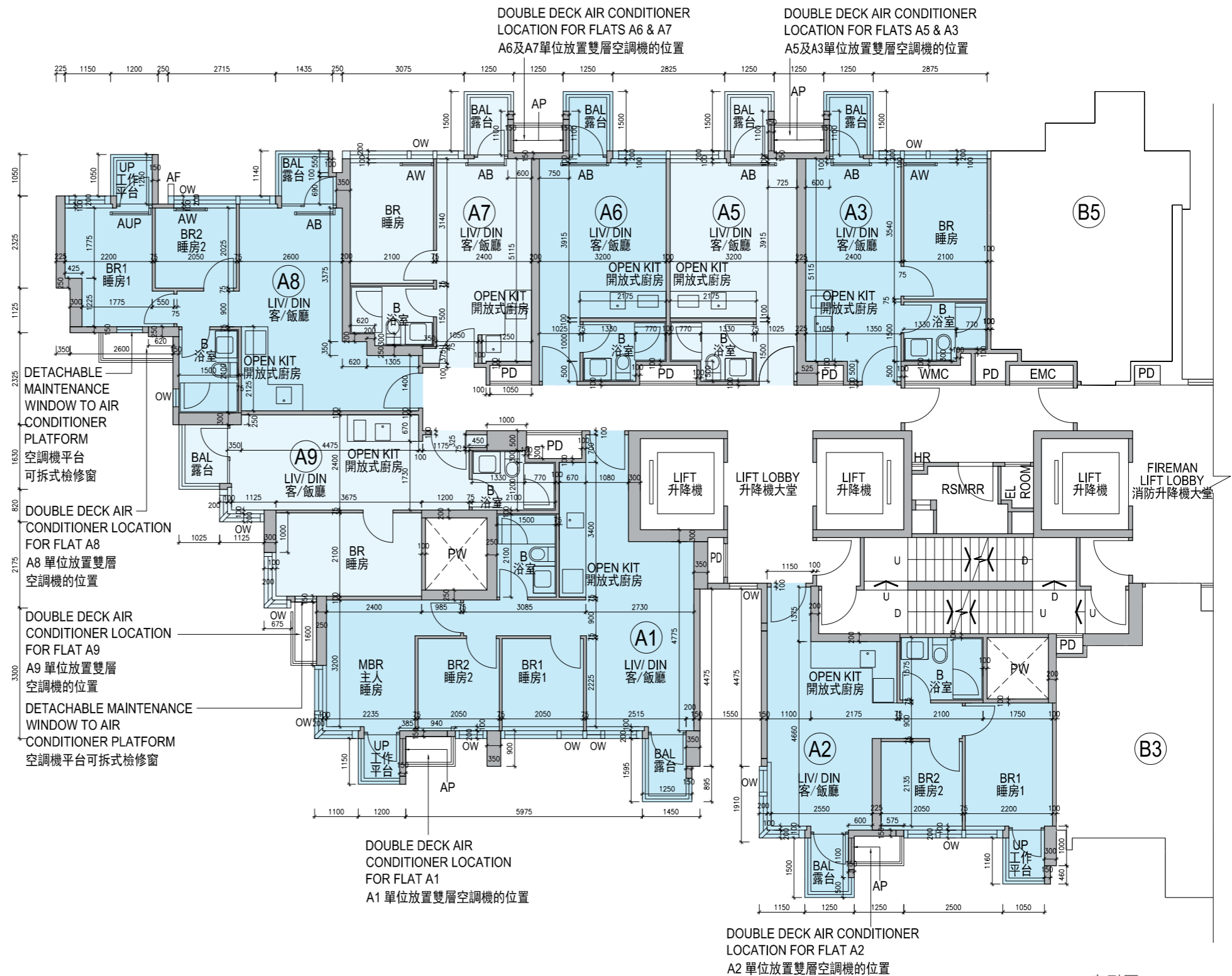

Scale 比例 0 1 2 3 4 5M(米)

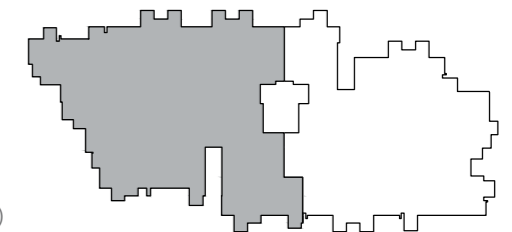

# Floor plans of residential properties in the development

## 發展項目的住宅物業的樓面平面圖

20/F  
20樓

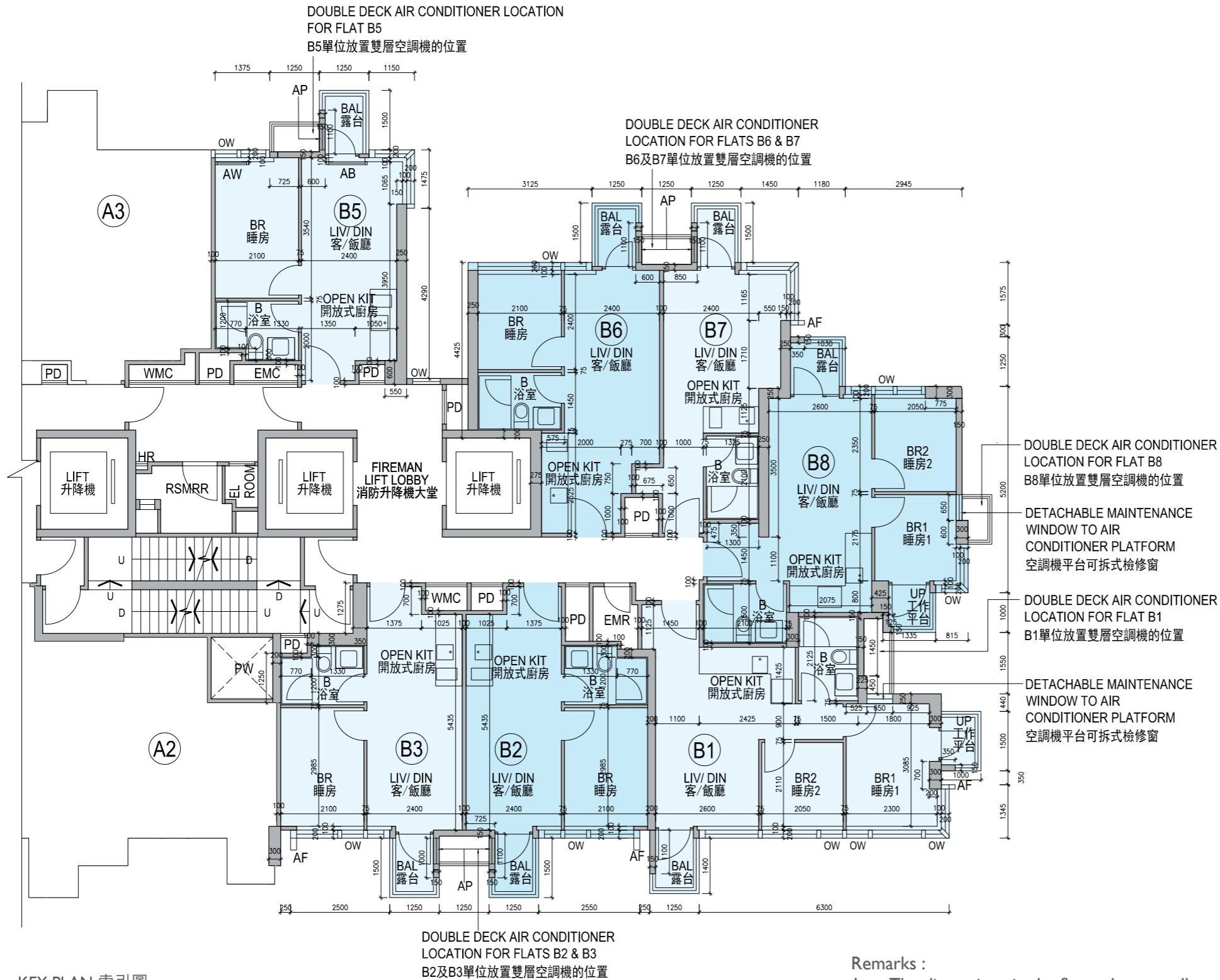

Description 描述	Flat 單位						
	B1	B2	B3	B5	B6	B7	B8
Floor-to-floor height (refers to the height between the top surface of the structural slab of a floor and the top surface of the structural slab of its immediate upper floor) of each residential property (m) 每個住宅物業的層與層之間的高度(指該樓層之石屎地台面與上一層石屎地台面之高度距離)(米)	3.000						
Thickness of the floor slabs (excluding plaster) of each residential property (mm) 每個住宅物業的樓板(不包括灰泥)厚度(毫米)	150						

The internal areas of the residential properties on the upper floors will generally be slightly larger than those on the lower floors because of the reducing thickness of the structural walls on the upper floors. (This statement does not apply to the residential properties in the Development because the design of the Development is such that the reducing thickness of the structural walls of residential properties on the upper floors does not increase the internal areas of those residential properties.)

因住宅物業的較高樓層的結構牆的厚度遞減，較高樓層的內部面積，一般比較低樓層的內部面積稍大。(不適用於發展項目內的住宅物業，因為發展項目的設計是較高樓層的住宅物業的結構牆的厚度遞減不會增加該等住宅物業的內部面積。)

### Remarks :

- The dimensions in the floor plans are all structural dimensions in millimetre.
- For details of the noise mitigation measures, please refer to the Relevant Information section in this sales brochure.
- Please refer to Page 23 of this sales brochure for legend of the terms and abbreviations shown in the floor plan.

### 備註 :

- 樓面平面圖之尺規所列數字為以毫米標示之建築結構尺寸。
- 有關紓緩噪音措施之詳情，請參閱本售樓說明書的有關資料章節。
- 平面圖中顯示之名詞及簡稱之圖例請參閱本售樓說明書第23頁。

# Floor plans of residential properties in the development

## 發展項目的住宅物業的樓面平面圖

21/F-22/F

21樓至22樓

Description 描述	Flat 單位							
	A1	A2	A3	A5	A6	A7	A8	A9
Floor-to-floor height (refers to the height between the top surface of the structural slab of a floor and the top surface of the structural slab of its immediate upper floor) of each residential property (m) 每個住宅物業的層與層之間的高度(指該樓層之石屎地台面與上一層石屎地台面之高度距離)(米)	3.000							
Thickness of the floor slabs (excluding plaster) of each residential property (mm) 每個住宅物業的樓板(不包括灰泥)厚度(毫米)	150	150, 175						150

The internal areas of the residential properties on the upper floors will generally be slightly larger than those on the lower floors because of the reducing thickness of the structural walls on the upper floors. (This statement does not apply to the residential properties in the Development because the design of the Development is such that the reducing thickness of the structural walls of residential properties on the upper floors does not increase the internal areas of those residential properties.)

因住宅物業的較高樓層的結構牆的厚度遞減，較高樓層的內部面積，一般比較低樓層的內部面積稍大。(不適用於發展項目內的住宅物業，因為發展項目的設計是較高樓層的住宅物業的結構牆的厚度遞減不會增加該等住宅物業的內部面積。)

### Remarks :

- The dimensions in the floor plans are all structural dimensions in millimetre.
- For details of the noise mitigation measures, please refer to the Relevant Information section in this sales brochure.
- Please refer to Page 23 of this sales brochure for legend of the terms and abbreviations shown in the floor plan.

### 備註 :

- 樓面平面圖之尺規所列數字為以毫米標示之建築結構尺寸。
- 有關舒緩噪音措施之詳情，請參閱本售樓說明書的有關資料章節。
- 平面圖中顯示之名詞及簡稱之圖例請參閱本售樓說明書第23頁。

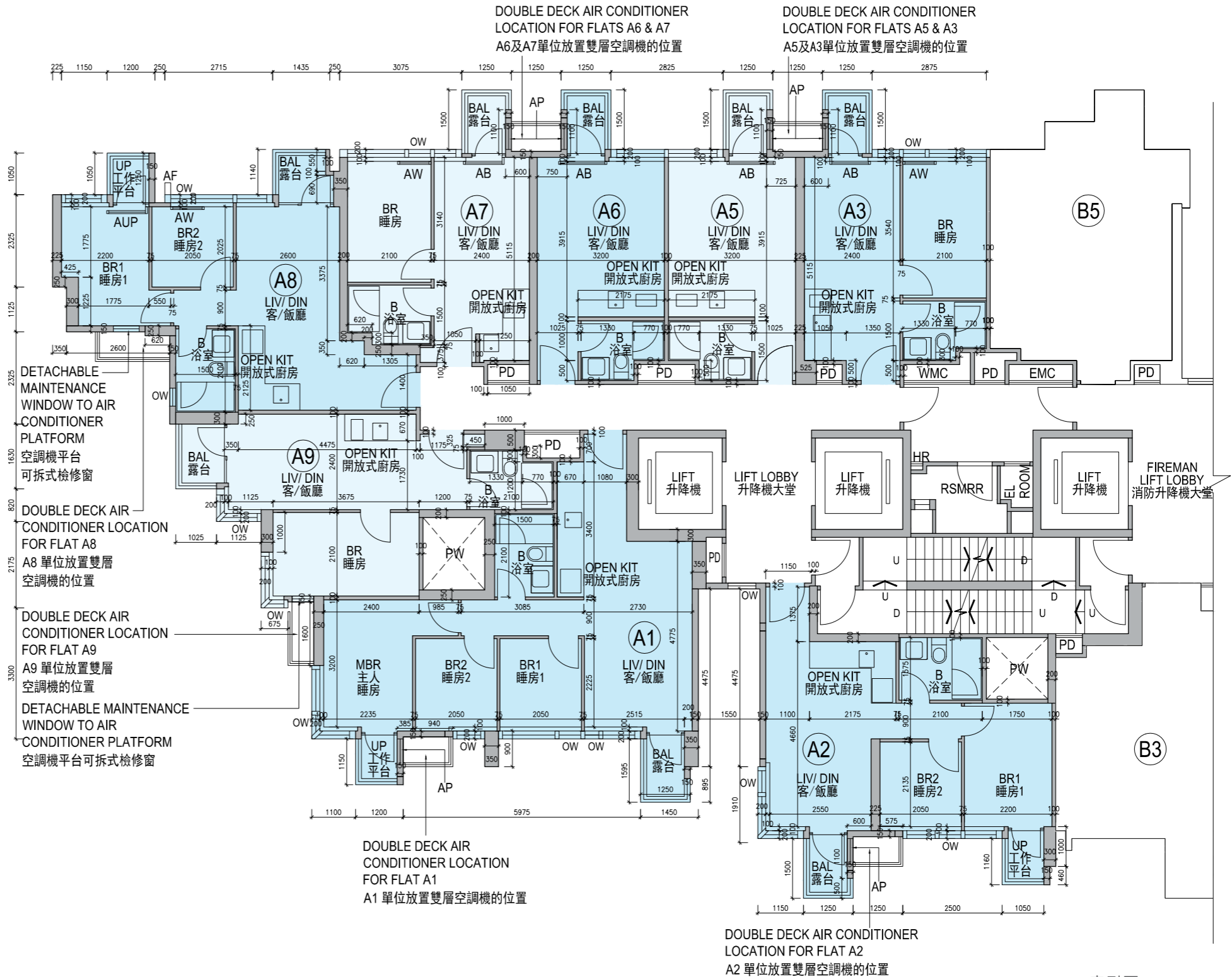

Scale 比例 0 1 2 3 4 5M(米)

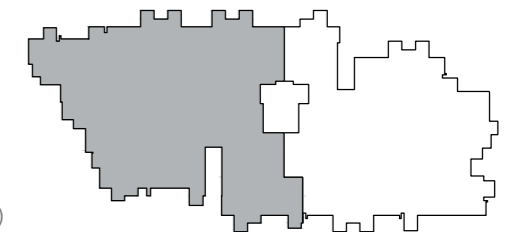

# Floor plans of residential properties in the development

## 發展項目的住宅物業的樓面平面圖

21/F-22/F

21樓至22樓

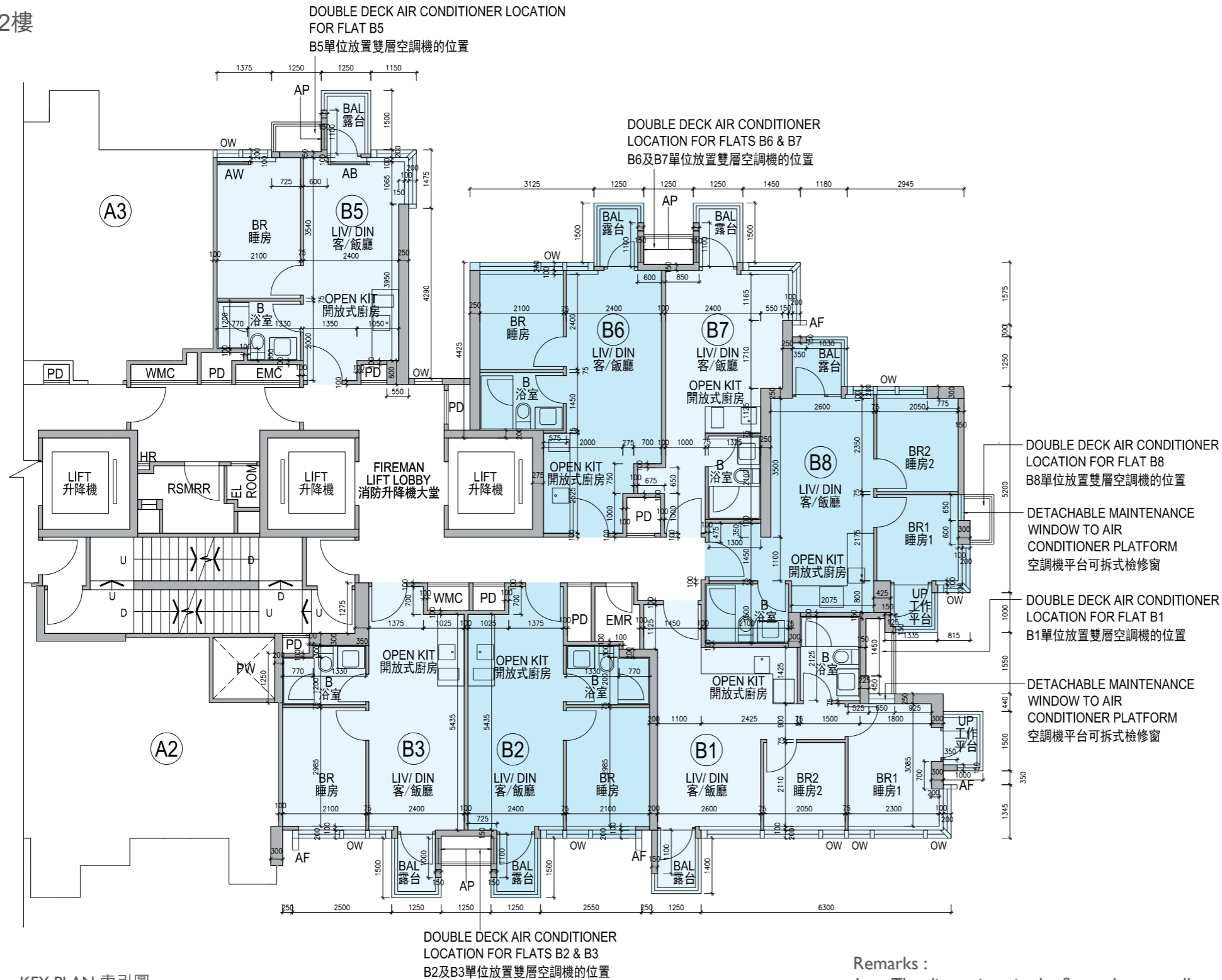

Description 描述	Flat 單位						
	B1	B2	B3	B5	B6	B7	B8
Floor-to-floor height (refers to the height between the top surface of the structural slab of a floor and the top surface of the structural slab of its immediate upper floor) of each residential property (m) 每個住宅物業的層與層之間的高度(指該樓層之石屎地台面與上一層石屎地台面之高度距離)(米)	3.000						
Thickness of the floor slabs (excluding plaster) of each residential property (mm) 每個住宅物業的樓板(不包括灰泥)厚度(毫米)	150						

The internal areas of the residential properties on the upper floors will generally be slightly larger than those on the lower floors because of the reducing thickness of the structural walls on the upper floors. (This statement does not apply to the residential properties in the Development because the design of the Development is such that the reducing thickness of the structural walls of residential properties on the upper floors does not increase the internal areas of those residential properties.)

因住宅物業的較高樓層的結構牆的厚度遞減，較高樓層的內部面積，一般比較低樓層的內部面積稍大。(不適用於發展項目內的住宅物業，因為發展項目的設計是較高樓層的住宅物業的結構牆的厚度遞減不會增加該等住宅物業的內部面積。)

### Remarks :

- The dimensions in the floor plans are all structural dimensions in millimetre.
- For details of the noise mitigation measures, please refer to the Relevant Information section in this sales brochure.
- Please refer to Page 23 of this sales brochure for legend of the terms and abbreviations shown in the floor plan.

### 備註 :

- 樓面平面圖之尺規所列數字為以毫米標示之建築結構尺寸。
- 有關紓緩噪音措施之詳情，請參閱本售樓說明書的有關資料章節。
- 平面圖中顯示之名詞及簡稱之圖例請參閱本售樓說明書第23頁。

# Floor plans of residential properties in the development

## 發展項目的住宅物業的樓面平面圖

23/F  
23樓

Description 描述	Flat 單位							
	A1	A2	A3	A5	A6	A7	A8	A9
Floor-to-floor height (refers to the height between the top surface of the structural slab of a floor and the top surface of the structural slab of its immediate upper floor) of each residential property (m) 每個住宅物業的層與層之間的高度(指該樓層之石屎地台面與上一層石屎地台面之高度距離)(米)	3.000							
Thickness of the floor slabs (excluding plaster) of each residential property (mm) 每個住宅物業的樓板(不包括灰泥)厚度(毫米)	150	150	175	150	150	150	150	150

The internal areas of the residential properties on the upper floors will generally be slightly larger than those on the lower floors because of the reducing thickness of the structural walls on the upper floors. (This statement does not apply to the residential properties in the Development because the design of the Development is such that the reducing thickness of the structural walls of residential properties on the upper floors does not increase the internal areas of those residential properties.)

因住宅物業的較高樓層的結構牆的厚度遞減，較高樓層的內部面積，一般比較低樓層的內部面積稍大。(不適用於發展項目內的住宅物業，因為發展項目的設計是較高樓層的住宅物業的結構牆的厚度遞減不會增加該等住宅物業的內部面積。)

### Remarks :

- The dimensions in the floor plans are all structural dimensions in millimetre.
- For details of the noise mitigation measures, please refer to the Relevant Information section in this sales brochure.
- Please refer to Page 23 of this sales brochure for legend of the terms and abbreviations shown in the floor plan.

### 備註 :

- 樓面平面圖之尺規所列數字為以毫米標示之建築結構尺寸。
- 有關舒緩噪音措施之詳情，請參閱本售樓說明書的有關資料章節。
- 平面圖中顯示之名詞及簡稱之圖例請參閱本售樓說明書第23頁。

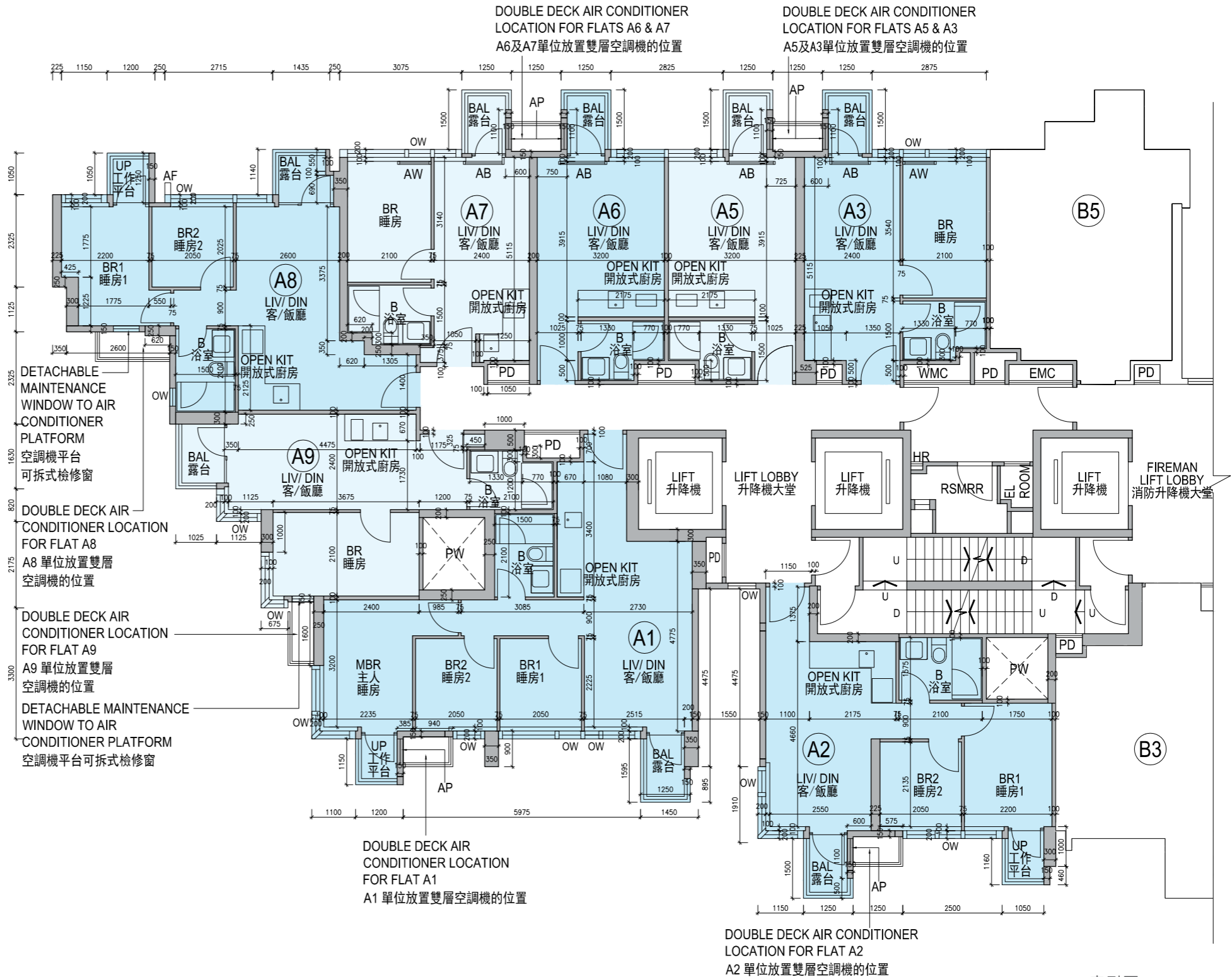

Scale 比例 0 1 2 3 4 5M(米)

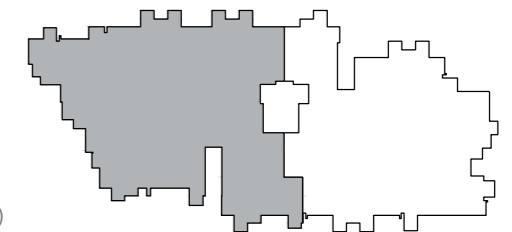



# Floor plans of residential properties in the development

## 發展項目的住宅物業的樓面平面圖

23/F  
23樓

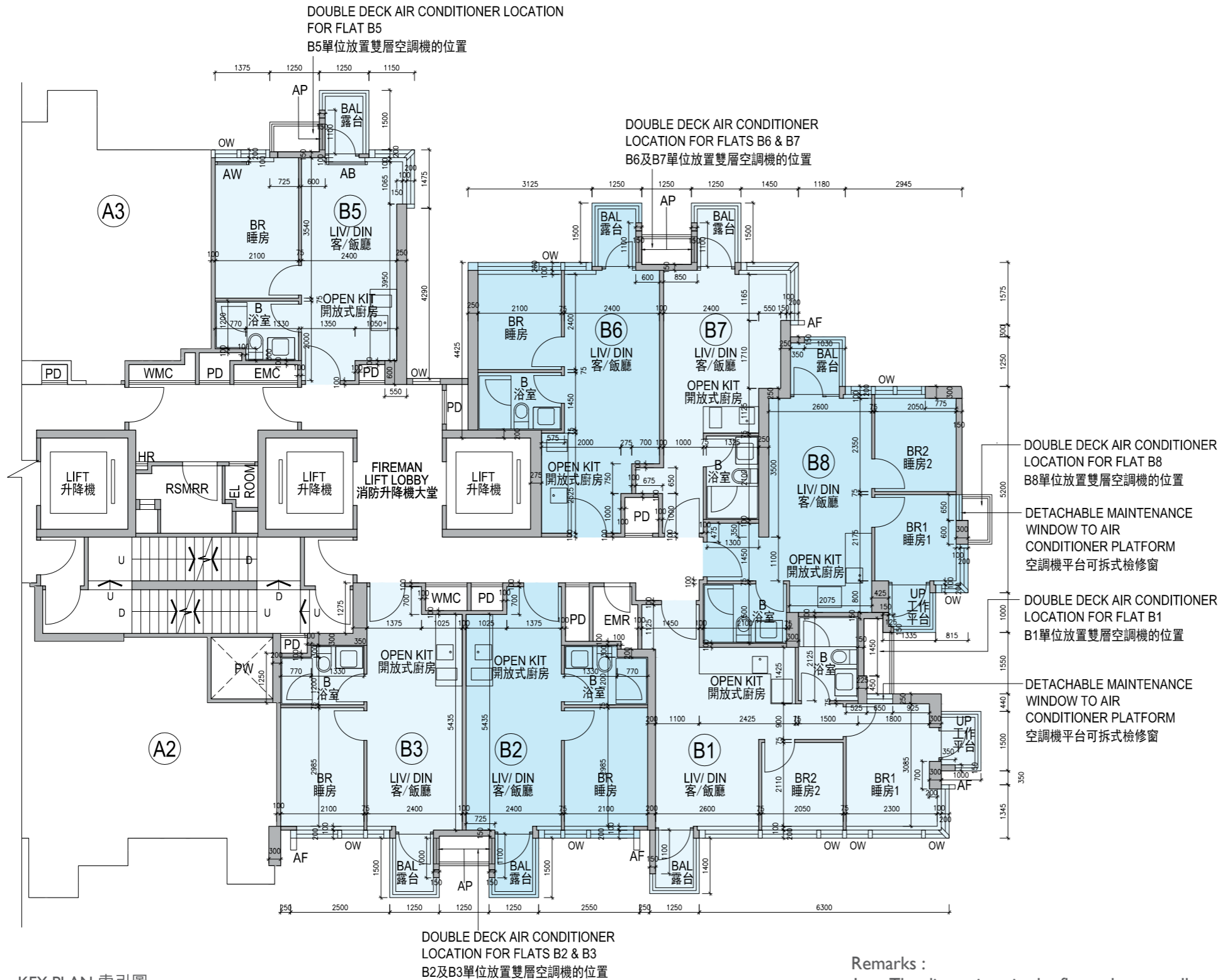

Description 描述	Flat 單位						
	B1	B2	B3	B5	B6	B7	B8
Floor-to-floor height (refers to the height between the top surface of the structural slab of a floor and the top surface of the structural slab of its immediate upper floor) of each residential property (m) 每個住宅物業的層與層之間的高度(指該樓層之石屎地台面與上一層石屎地台面之高度距離)(米)	3.000						
Thickness of the floor slabs (excluding plaster) of each residential property (mm) 每個住宅物業的樓板(不包括灰泥)厚度(毫米)	150						

The internal areas of the residential properties on the upper floors will generally be slightly larger than those on the lower floors because of the reducing thickness of the structural walls on the upper floors. (This statement does not apply to the residential properties in the Development because the design of the Development is such that the reducing thickness of the structural walls of residential properties on the upper floors does not increase the internal areas of those residential properties.)

因住宅物業的較高樓層的結構牆的厚度遞減，較高樓層的內部面積，一般比較低樓層的內部面積稍大。(不適用於發展項目內的住宅物業，因為發展項目的設計是較高樓層的住宅物業的結構牆的厚度遞減不會增加該等住宅物業的內部面積。)

### Remarks :

- The dimensions in the floor plans are all structural dimensions in millimetre.
- For details of the noise mitigation measures, please refer to the Relevant Information section in this sales brochure.
- Please refer to Page 23 of this sales brochure for legend of the terms and abbreviations shown in the floor plan.

### 備註 :

- 樓面平面圖之尺規所列數字為以毫米標示之建築結構尺寸。
- 有關紓緩噪音措施之詳情，請參閱本售樓說明書的有關資料章節。
- 平面圖中顯示之名詞及簡稱之圖例請參閱本售樓說明書第23頁。

KEY PLAN 索引圖

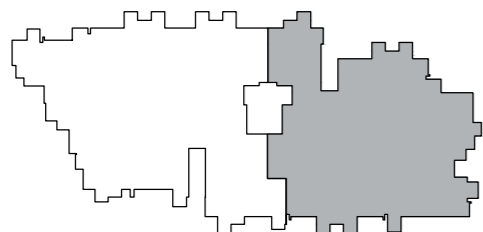

Scale 比例 0 1 2 3 4 5M(米)



# Floor plans of residential properties in the development

## 發展項目的住宅物業的樓面平面圖

25/F  
25樓

Description 描述	Flat 單位							
	A1	A2	A3	A5	A6	A7	A8	A9
Floor-to-floor height (refers to the height between the top surface of the structural slab of a floor and the top surface of the structural slab of its immediate upper floor) of each residential property (m) 每個住宅物業的層與層之間的高度(指該樓層之石屎地台面與上一層石屎地台面之高度距離)(米)	3.050							
Thickness of the floor slabs (excluding plaster) of each residential property (mm) 每個住宅物業的樓板(不包括灰泥)厚度(毫米)	200	200	225					200

The internal areas of the residential properties on the upper floors will generally be slightly larger than those on the lower floors because of the reducing thickness of the structural walls on the upper floors. (This statement does not apply to the residential properties in the Development because the design of the Development is such that the reducing thickness of the structural walls of residential properties on the upper floors does not increase the internal areas of those residential properties.)

因住宅物業的較高樓層的結構牆的厚度遞減，較高樓層的內部面積，一般比較低樓層的內部面積稍大。(不適用於發展項目內的住宅物業，因為發展項目的設計是較高樓層的住宅物業的結構牆的厚度遞減不會增加該等住宅物業的內部面積。)

### Remarks :

- The dimensions in the floor plans are all structural dimensions in millimetre.
- For details of the noise mitigation measures, please refer to the Relevant Information section in this sales brochure.
- Please refer to Page 23 of this sales brochure for legend of the terms and abbreviations shown in the floor plan.

### 備註：

- 樓面平面圖之尺規所列數字為以毫米標示之建築結構尺寸。
- 有關紓緩噪音措施之詳情，請參閱本售樓說明書的有關資料章節。
- 平面圖中顯示之名詞及簡稱之圖例請參閱本售樓說明書第23頁。

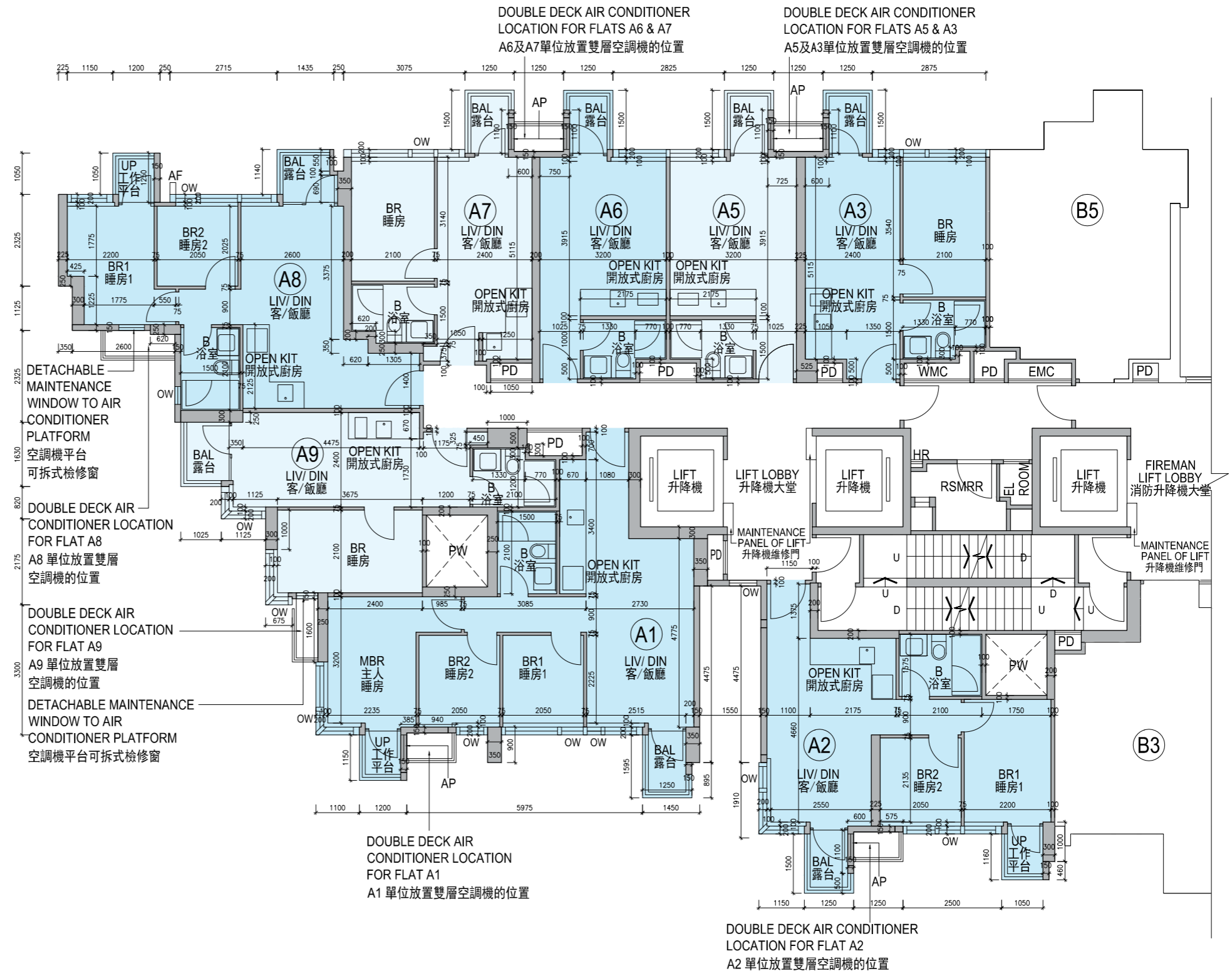

### KEY PLAN 索引圖

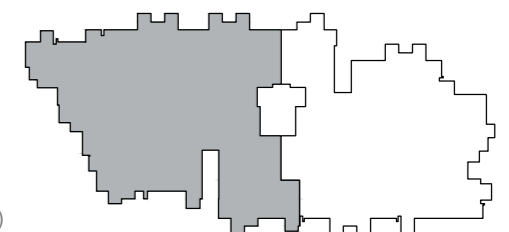

# Floor plans of residential properties in the development

## 發展項目的住宅物業的樓面平面圖

25/F  
25樓

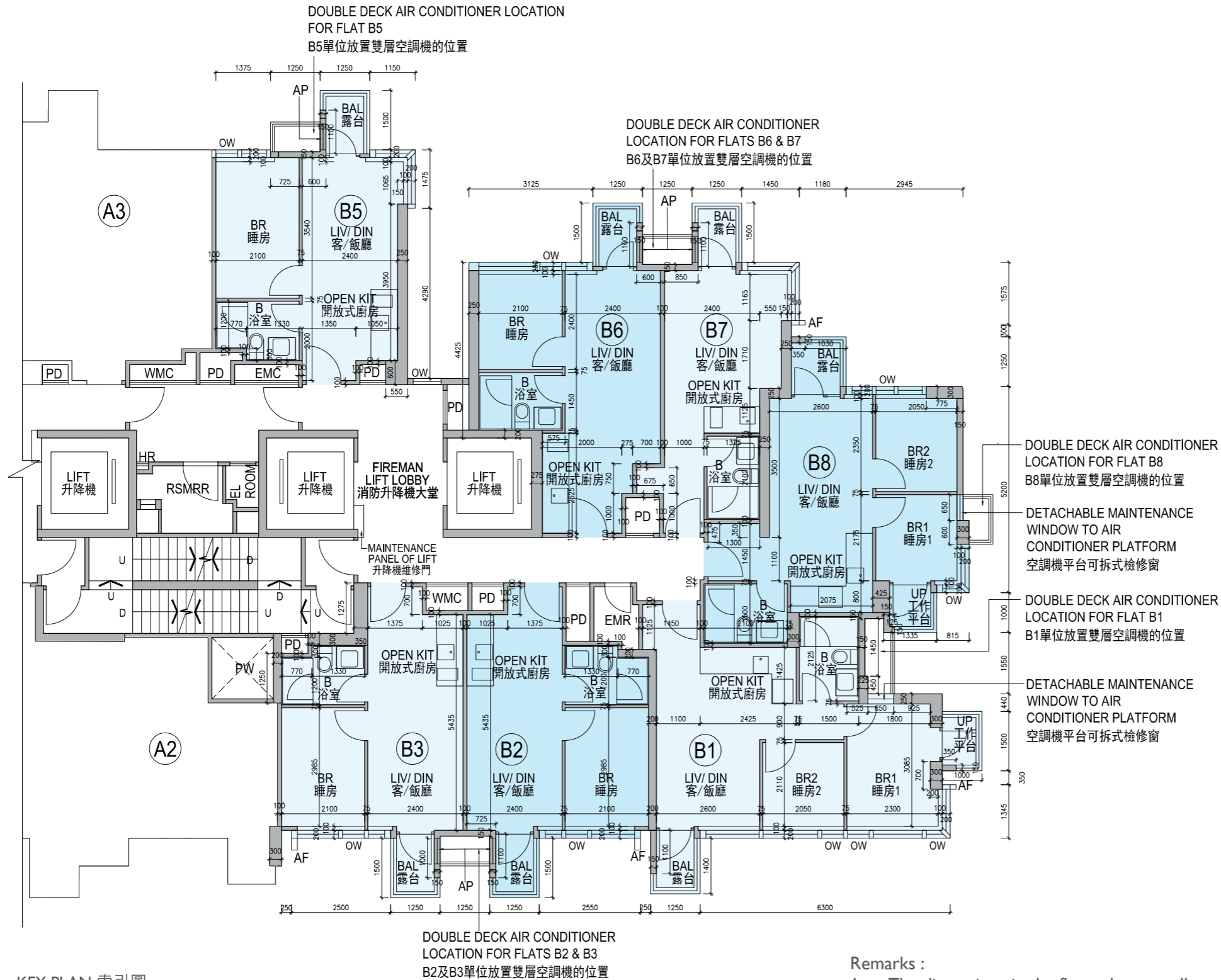

Description 描述	Flat 單位						
	B1	B2	B3	B5	B6	B7	B8
Floor-to-floor height (refers to the height between the top surface of the structural slab of a floor and the top surface of the structural slab of its immediate upper floor) of each residential property (m) 每個住宅物業的層與層之間的高度(指該樓層之石屎地台面與上一層石屎地台面之高度距離)(米)	3.050						
Thickness of the floor slabs (excluding plaster) of each residential property (mm) 每個住宅物業的樓板(不包括灰泥)厚度(毫米)	200						

The internal areas of the residential properties on the upper floors will generally be slightly larger than those on the lower floors because of the reducing thickness of the structural walls on the upper floors. (This statement does not apply to the residential properties in the Development because the design of the Development is such that the reducing thickness of the structural walls of residential properties on the upper floors does not increase the internal areas of those residential properties.)

因住宅物業的較高樓層的結構牆的厚度遞減，較高樓層的內部面積，一般比較低樓層的內部面積稍大。(不適用於發展項目內的住宅物業，因為發展項目的設計是較高樓層的住宅物業的結構牆的厚度遞減不會增加該等住宅物業的內部面積。)

### Remarks:

- The dimensions in the floor plans are all structural dimensions in millimetre.
- For details of the noise mitigation measures, please refer to the Relevant Information section in this sales brochure.
- Please refer to Page 23 of this sales brochure for legend of the terms and abbreviations shown in the floor plan.

### 備註:

- 樓面平面圖之尺規所列數字為以毫米標示之建築結構尺寸。
- 有關紓緩噪音措施之詳情，請參閱本售樓說明書的有關資料章節。
- 平面圖中顯示之名詞及簡稱之圖例請參閱本售樓說明書第23頁。

# Floor plans of residential properties in the development

## 發展項目的住宅物業的樓面平面圖

### ROOF 天台

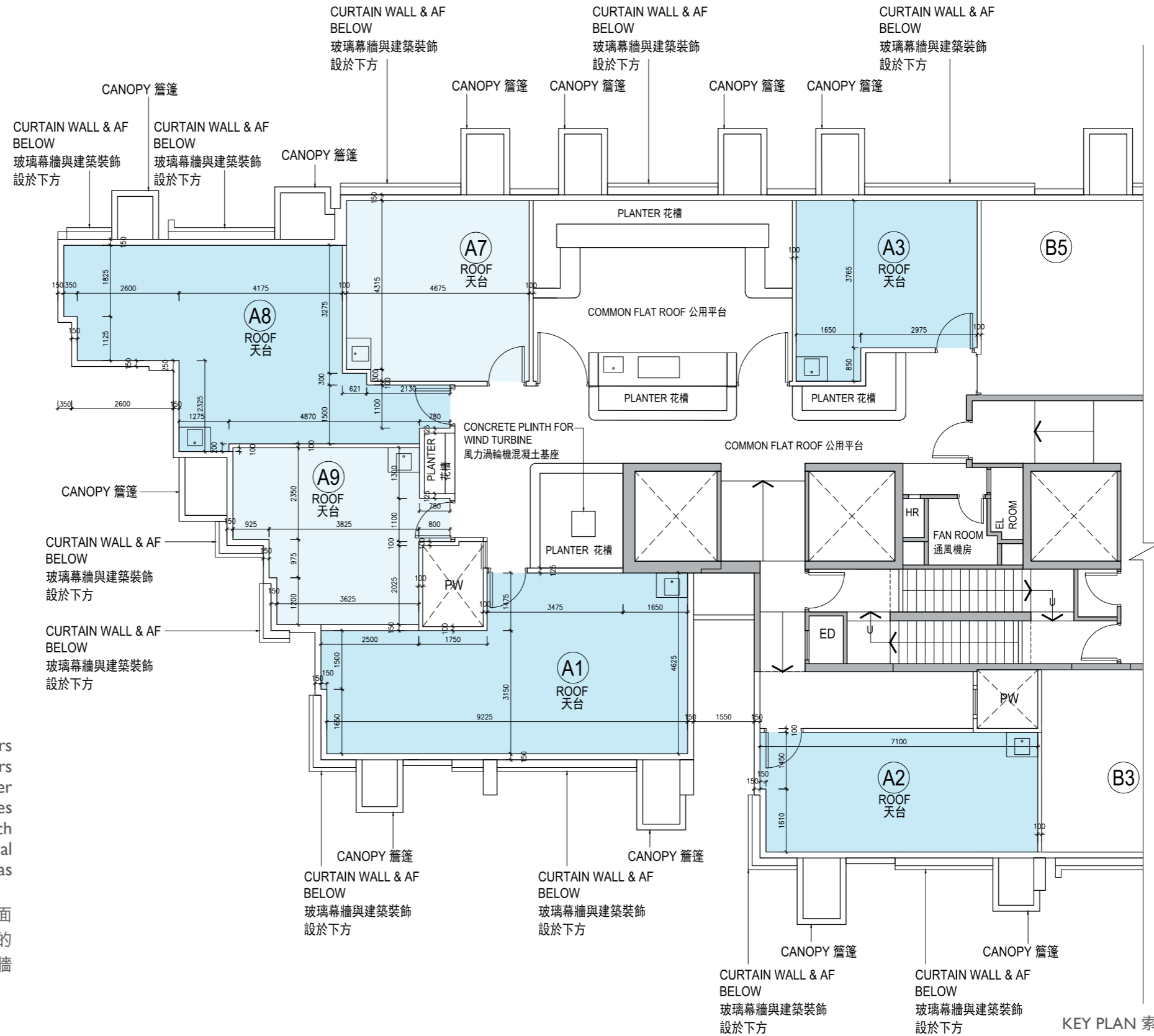

The internal areas of the residential properties on the upper floors will generally be slightly larger than those on the lower floors because of the reducing thickness of the structural walls on the upper floors. (This statement does not apply to the residential properties in the Development because the design of the Development is such that the reducing thickness of the structural walls of residential properties on the upper floors does not increase the internal areas of those residential properties.)

因住宅物業的較高樓層的結構牆的厚度遞減，較高樓層的內部面積，一般比較低樓層的內部面積稍大。(不適用於發展項目內的住宅物業，因為發展項目的設計是較高樓層的住宅物業的結構牆的厚度遞減不會增加該等住宅物業的內部面積。)

#### Remarks :

1. The dimensions in the floor plans are all structural dimensions in millimetre.
2. Please refer to Page 23 of this sales brochure for legend of the terms and abbreviations shown in the floor plan.

#### 備註：

1. 樓面平面圖之尺規所列數字為以毫米標示之建築結構尺寸。
2. 平面圖中顯示之名詞及簡稱之圖例請參閱本售樓說明書第23頁。



Scale  
比例 0 1 2 3 4 5M(米)

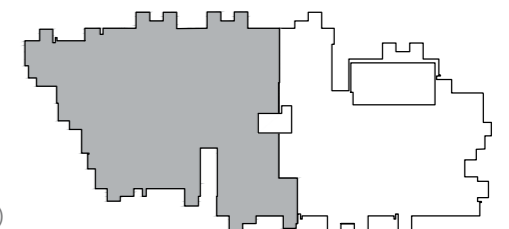

# Floor plans of residential properties in the development

## 發展項目的住宅物業的樓面平面圖

ROOF  
天台

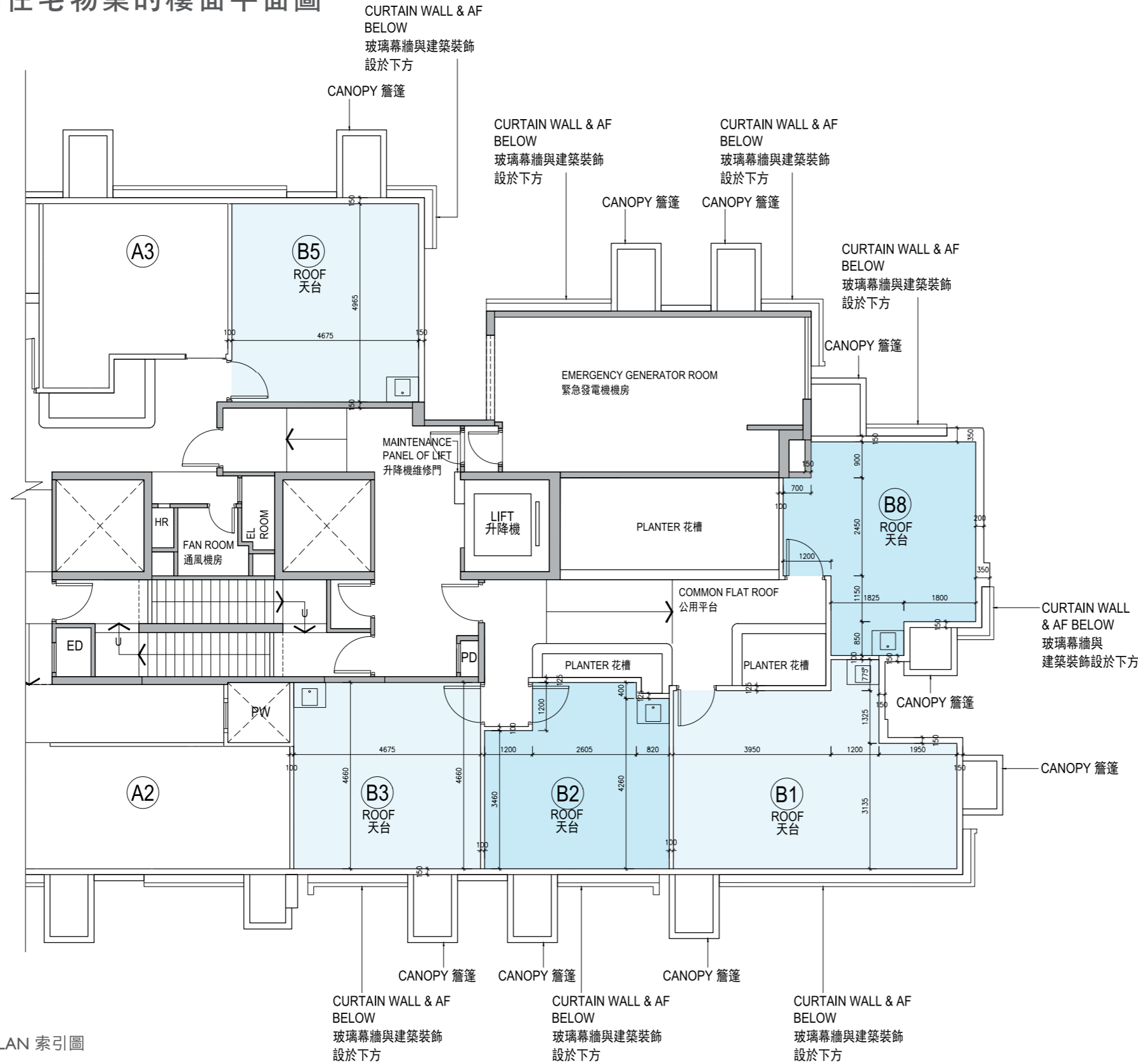

The internal areas of the residential properties on the upper floors will generally be slightly larger than those on the lower floors because of the reducing thickness of the structural walls on the upper floors. (This statement does not apply to the residential properties in the Development because the design of the Development is such that the reducing thickness of the structural walls of residential properties on the upper floors does not increase the internal areas of those residential properties.)

因住宅物業的較高樓層的結構牆的厚度遞減，較高樓層的內部面積，一般比較低樓層的內部面積稍大。(不適用於發展項目內的住宅物業，因為發展項目的設計是較高樓層的住宅物業的結構牆的厚度遞減不會增加該等住宅物業的內部面積。)

KEY PLAN 索引圖

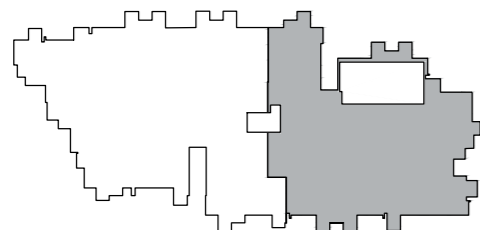

Scale  
比例 0 1 2 3 4 5M(米)



Remarks :

1. The dimensions in the floor plans are all structural dimensions in millimetre.
2. Please refer to Page 23 of this sales brochure for legend of the terms and abbreviations shown in the floor plan.

備註：

1. 樓面平面圖之尺規所列數字為以毫米標示之建築結構尺寸。
2. 平面圖中顯示之名詞及簡稱之圖例請參閱本售樓說明書第23頁。