

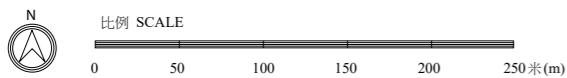

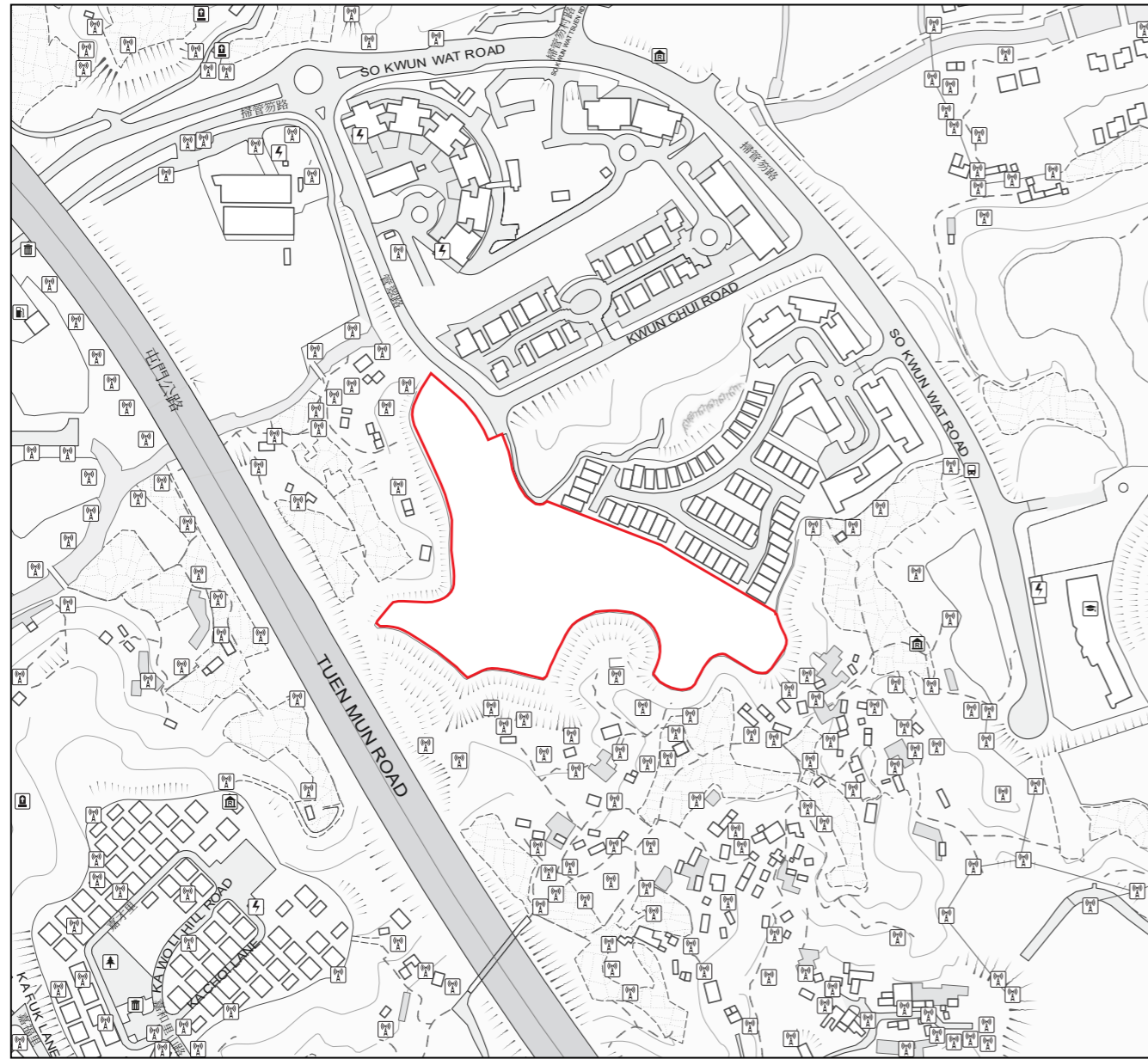

# 06 發展項目的所在位置圖

## LOCATION PLAN OF THE DEVELOPMENT



 發展項目的位置  
Location of the Development

地圖版權屬香港特區政府，經地政總署准許複印，版權特許編號80/2019。  
The Plan is reproduced with permission of the Director of Lands.  
© The Government of Hong Kong SAR. License No. 80/2019.

此位置圖是由賣方擬備並參考於2019年11月10日出版之地政總署測繪處之測繪圖，圖幅編號T6-SW-C，有需要處經修正處理。

This location plan is prepared by the vendor with reference to the Survey Sheet No. T6-SW-C dated 10 November 2019 from Survey and Mapping Office of the Lands Department, with adjustments where necessary.

### 圖例 Notation

-  油站  
Petrol Filling Station
-  公用事業設施裝置  
Public Utility Installation
-  發電廠 (包括電力分站)  
Power Plant (including Electricity Sub-stations)
-  宗教場所 (包括教堂、廟宇及祠堂)  
Religious Institution (including Church, Temple and Tsz Tong)
-  墳場  
Cemetery
-  學校 (包括幼稚園)  
School (including Kindergarten)
-  垃圾收集站  
Refuse Collection Point
-  公園  
Public Park
-  公共交通總站 (包括鐵路車站)  
Public Transport Terminal (including Rail Station)

#### 備註：

1. 賣方建議準買家到有關發展地盤作實地考察，以對該發展地盤、其周邊地區環境及附近的公共設施有較佳了解。
2. 由於發展項目的邊界不規則的技術原因，此位置圖所顯示的範圍可能超過《一手住宅物業銷售條例》所規定的範圍。

#### Notes:

1. The vendor advises prospective purchasers to conduct an on-site visit for a better understanding of the development site, its surrounding environment and the public facilities nearby.
2. The location plan may show more than the area required under the Residential Properties (First-hand Sales) Ordinance due to the technical reason that the boundary of the Development is irregular.