

# Floor plans of residential properties in the development 發展項目的住宅物業的樓面平面圖

Tower 1 6/F  
第1座 6樓

Description 描述	Residential Unit 住宅單位									
	A	B	C	D	E	F	G	H	J	
Floor-to-floor height (refers to the height between the top surface of the structural slab of a floor and the top surface of the structural slab of its immediate upper floor) of each residential property (m) 每個住宅物業的層與層之間的高度 (指該樓層之石屎地台面與上一層石屎地台面之高度距離)(米)					3.15 3.25 3.50					
Thickness of the floor slabs (excluding plaster) of each residential property (mm) 每個住宅物業的樓板 (不包括灰泥)厚度(毫米)					150					

## Legend 圖例

A/C PLATFORM = Air-conditioner Platform 空調機平台  
AD = AIR DUCT = 通風槽  
BAL = Balcony 露台  
B = Bathroom 浴室  
BR = Bedroom 睡房  
BW = Bay Window 窗台  
CW = Curtain Wall 幕牆  
CANOPY = 簷蓬  
D = Down 下  
DIN = Dining Room 飯廳  
DOG HOUSE = Mechanical & Electrical Services Duct  
Connecting to the Floor Below  
連接下層的機電設施管道  
EMC = Electricity Meter Cabinet 電錶箱  
EMR = Electricity Meter Room 電錶房  
ELV = Extra Low Voltage Duct/Cabinet 低電壓槽/箱  
FAMILY = Family Area 家庭廳  
FLAT ROOF = 平台  
INACCESSIBLE FLAT ROOF = 不能直達平台  
HR = Hose Reel 消防喉轆  
KIT = Kitchen 廚房  
LIFT = 升降機  
LIFT LOBBY = 升降機大堂  
LIV = Living Room 客廳  
MBR = Master Bedroom 主人睡房  
OPEN PIPE WELL = 管道井  
PD = Pipe Duct 管道槽  
POOL DECK = 日光曬台  
POOL = Swimming Pool 泳池  
RS/MRR = Refuse Storage and Material Recovery Room  
垃圾儲存及物料回收室  
SPACE FOR FILTRATION PLANT = 濾水機房位置  
STO = Store 儲物房  
T = Toilet 洗手間  
U = Up 上  
UP = Utility Platform 工作平台  
VOID ABOVE = 上層中空  
VOID = 中空  
WALK-IN CLOSET = 衣帽間  
WMC = Water Meter Cabinet 水錶箱

The internal areas of the residential properties on the upper floors will generally be slightly larger than those on the lower floors because of the reducing thickness of the structural walls on the upper floors.

### Remarks :

- The dimensions in the floor plans are all structural dimensions in millimetre.
- The floor-to-floor height (i.e. the height between the top surface of the structural slab of that floor (i.e. 6/F) and the top surface of the structural slab of its immediate upper floor (i.e. 7/F)) includes, without limitation, a mass concrete fill with thickness of 500mm, 350mm, 250mm and 150mm located partly on top of the top surface of the structural slab of that floor (i.e. 6/F).

因住宅物業的較高樓層的結構牆的厚度遞減，較高樓層的內部面積，一般比較低樓層的內部面積稍大。

### 備註：

- 樓面平面圖之尺規所列數字為以毫米標示之建築結構尺寸。
- 層與層之間的高度(指該樓層(即6樓)之石屎地台面與上一層石屎地台面(即7樓)之高度距離)包括但不限於厚度為500毫米、350毫米、250毫米及150毫米之混凝土填充層(該等混凝土填充層有部分位於該樓層(即6樓)之石屎地台面之上)。

# Floor plans of residential properties in the development 發展項目的住宅物業的樓面平面圖

Tower 1 6/F  
第1座 6樓

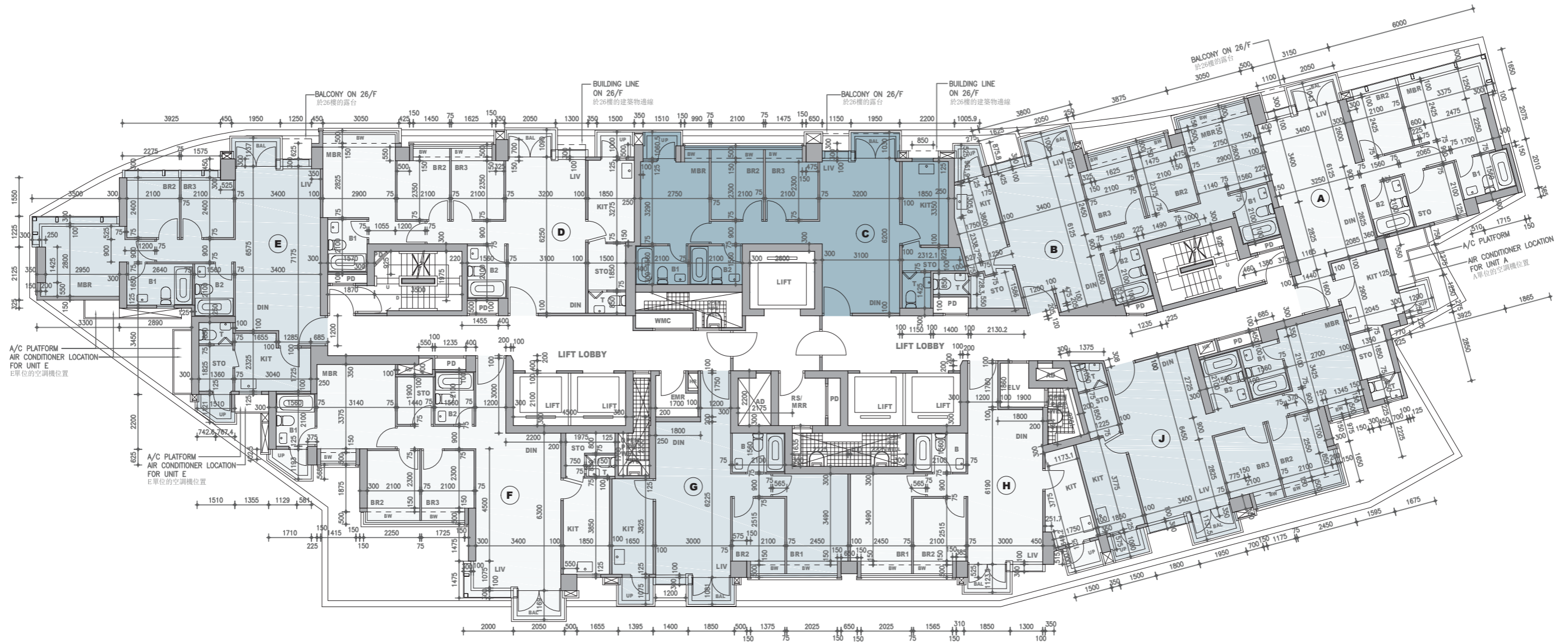

Scale 0 1 2 3 4 5M(米)  
比例

# Floor plans of residential properties in the development

## 發展項目的住宅物業的樓面平面圖

Tower 1 7/F - 12/F, 15/F - 23/F & 25/F (13/F, 14/F & 24/F are omitted)  
 第1座 7樓 - 12樓、15樓 - 23樓及25樓(不設13樓、14樓及24樓)

### Legend 圖例

A/C PLATFORM = Air-conditioner Platform 空調機平台  
 AD = AIR DUCT = 通風槽  
 BAL = Balcony 露台  
 B = Bathroom 浴室  
 BR = Bedroom 睡房  
 BW = Bay Window 窗台  
 CW = Curtain Wall 幕牆  
 CANOPY = 簷蓬  
 D = Down 下  
 DIN = Dining Room 飯廳  
 DOG HOUSE = Mechanical & Electrical Services Duct Connecting to the Floor Below 連接下層的機電設施管道  
 EMC = Electricity Meter Cabinet 電錶箱  
 EMR = Electricity Meter Room 電錶房  
 ELV = Extra Low Voltage Duct/Cabinet 低電壓槽/箱  
 FAMILY = Family Area 家庭廳  
 FLAT ROOF = 平台  
 INACCESSIBLE FLAT ROOF = 不能直達平台  
 HR = Hose Reel 消防喉轆  
 KIT = Kitchen 廚房  
 LIFT = 升降機  
 LIFT LOBBY = 升降機大堂  
 LIV = Living Room 客廳  
 MBR = Master Bedroom 主人睡房  
 OPEN PIPE WELL = 管道井  
 PD = Pipe Duct 管道槽  
 POOL DECK = 日光曬台  
 POOL = Swimming Pool 泳池  
 RS/MRR = Refuse Storage and Material Recovery Room 垃圾儲存及物料回收室  
 SPACE FOR FILTRATION PLANT = 濾水機房位置  
 STO = Store 儲物房  
 T = Toilet 洗手間  
 U = Up 上  
 UP = Utility Platform 工作平台  
 VOID ABOVE = 上層中空  
 VOID = 中空  
 WALK-IN CLOSET = 衣帽間  
 WMC = Water Meter Cabinet 水錶箱

Description 描述		Residential Unit 住宅單位									
		A	B	C	D	E	F	G	H	J	
Floor-to-floor height (refers to the height between the top surface of the structural slab of a floor and the top surface of the structural slab of its immediate upper floor) of each residential property (m) 每個住宅物業的層與層之間的高度(指該樓層之石屎地台面與上一層石屎地台面之高度距離)(米)	7/F - 12/F & 15/F - 23/F 7樓 - 12樓及15樓 - 23樓	3.00									
	25/F 25樓	3.50 3.60 3.80 3.85 4.10 4.15 4.20	3.50 3.60 3.85 4.10 4.20	3.80 3.85 4.10 4.20	3.45 3.50 3.75 3.70 3.85 4.10 4.20	3.45 3.50 3.60 3.75 3.80 3.85 4.10 4.15 4.20	3.50 3.60 3.85 4.10			3.60 3.85	
Thickness of the floor slabs (excluding plaster) of each residential property (mm) 每個住宅物業的樓板(不包括灰泥)厚度(毫米)	7/F - 12/F & 15/F - 23/F 7樓至12樓及15樓 - 23樓	150									
	25/F 25樓	150	150	200	150						

The internal areas of the residential properties on the upper floors will generally be slightly larger than those on the lower floors because of the reducing thickness of the structural walls on the upper floors.

#### Remarks :

- The dimensions in the floor plans are all structural dimensions in millimetre.
- There is/are a void(s) in between the double structural floor slabs of various thickness (namely, (i) 150mm and 150mm, and (ii) 200mm and 150mm respectively), which slabs are located in between 25/F and 26/F. The floor-to-floor height of residential units on 25/F (i.e. the height between the top surface of the structural slab of that floor (i.e. 25/F) and the top surface of the structural slab of its immediate upper floor (i.e. 26/F)) includes, without limitation, the height of void(s) of 700mm, 650mm, 450mm, 350mm and 300mm in between the double structural slabs.
- There is a structure of maximum 1000mm thick located in between 25/F and 26/F. The floor-to-floor height of residential unit(s) on 25/F (i.e. the height between the top surface of the structural slab of that floor (i.e. 25/F) and the top surface of the structural slab of its immediate upper floor (i.e. 26/F)) includes, without limitation, the thickness of the structure.

因住宅物業的較高樓層的結構牆的厚度遞減，較高樓層的內部面積，一般比較低樓層的內部面積稍大。

#### 備註：

- 樓面平面圖之尺規所列數字為以毫米標示之建築結構尺寸。
- 雙層石屎樓層地台(其厚度各有不同，分別為(i)150毫米及150毫米及(ii)200毫米及150毫米)之間存有空心位置，該等地台位於25樓及26樓之間。25樓的住宅單位的層與層之間的高度(指該樓層(即25樓)之石屎地台面與上一層石屎地台面(即26樓)之高度距離)包括但不限於雙層石屎地台之間之空心位置的高度(高度為700毫米、650毫米、450毫米、350毫米及300毫米)。
- 厚度不多於1000毫米的結構位於25樓及26樓之間。25樓的住宅單位層與層之間的高度(指該樓層(即25樓)之石屎地台面與上一層石屎地台面(即26樓)之高度距離)包括但不限於該結構的厚度。



# Floor plans of residential properties in the development 發展項目的住宅物業的樓面平面圖

Tower 1 7/F - 12/F, 15/F - 23/F & 25/F (13/F, 14/F & 24/F are omitted)  
第1座 7樓 - 12樓、15樓 - 23樓及25樓(不設13樓、14樓及24樓)

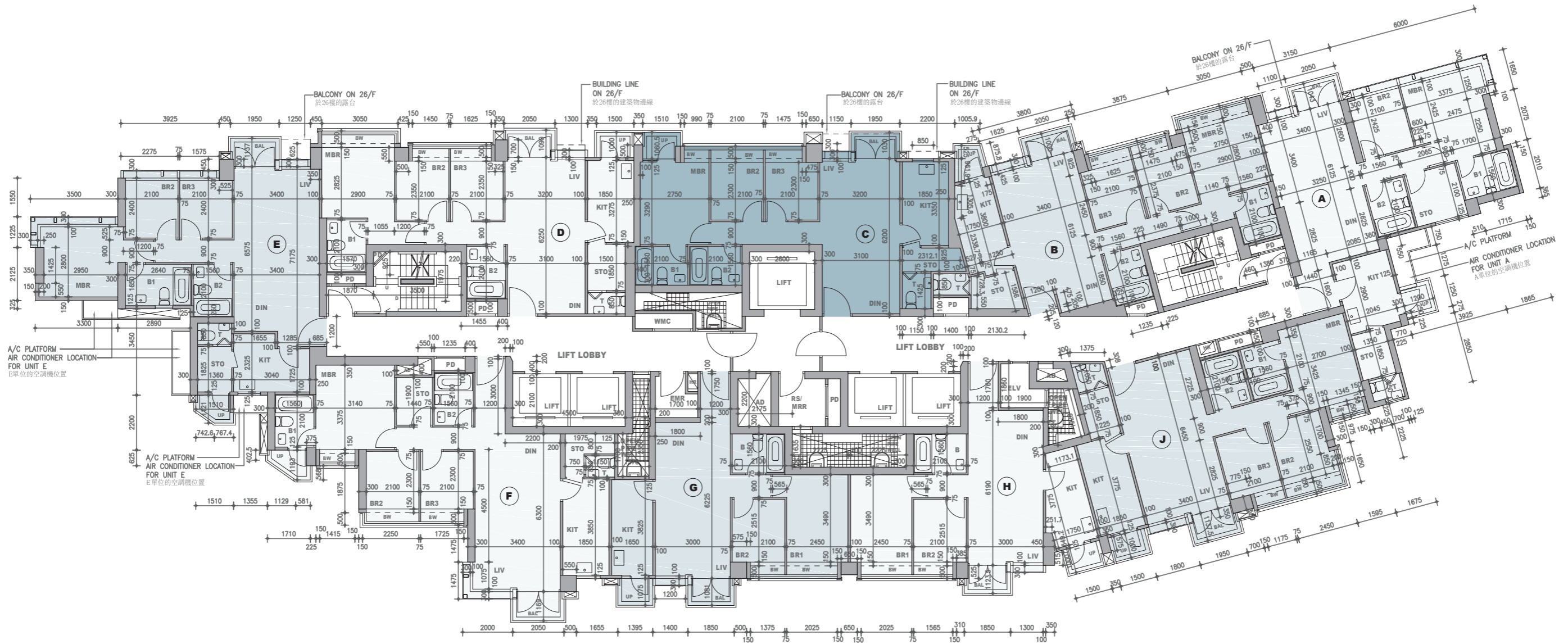

Scale 0 1 2 3 4 5M(米)  
比例



# Floor plans of residential properties in the development 發展項目的住宅物業的樓面平面圖

Tower 1 26/F - 32/F  
第1座 26樓 - 32樓

Description 描述		Residential Unit 住宅單位					
		A	B	C	F	G	H
Floor-to-floor height (refers to the height between the top surface of the structural slab of a floor and the top surface of the structural slab of its immediate upper floor) of each residential property (m) 每個住宅物業的層與層之間的高度 (指該樓層之石屎地台面與上一層石屎地台面之高度距離)(米)	26/F - 31/F 26樓 - 31樓	3.10					
	32/F 32樓	3.10 3.15 3.35 3.45	3.00 3.10 3.15 3.20 3.35 3.45 3.50 3.55	3.10 3.15 3.45 3.50	3.10 3.15 3.45 3.50	3.10 3.15 3.40 3.45 3.50	3.10 3.15 3.40 3.45 3.50
Thickness of the floor slabs (excluding plaster) of each residential property (mm) 每個住宅物業的樓板 (不包括灰泥)厚度(毫米)	26/F - 31/F 26樓 - 31樓	150 200		150			
	32/F 32樓	150 200	150 200 300	150 200 250	200		

## Legend 圖例

A/C PLATFORM = Air-conditioner Platform 空調機平台  
AD = AIR DUCT = 通風槽  
BAL = Balcony 露台  
B = Bathroom 浴室  
BR = Bedroom 睡房  
BW = Bay Window 窗台  
CW = Curtain Wall 幕牆  
CANOPY = 簷蓬  
D = Down 下  
DIN = Dining Room 飯廳  
DOG HOUSE = Mechanical & Electrical Services Duct  
Connecting to the Floor Below  
連接下層的機電設施管道  
EMC = Electricity Meter Cabinet 電錶箱  
EMR = Electricity Meter Room 電錶房  
ELV = Extra Low Voltage Duct/Cabinet 低電壓槽/箱  
FAMILY = Family Area 家庭廳  
FLAT ROOF = 平台  
INACCESSIBLE FLAT ROOF = 不能直達平台  
HR = Hose Reel 消防喉轆  
KIT = Kitchen 廚房  
LIFT = 升降機  
LIFT LOBBY = 升降機大堂  
LIV = Living Room 客廳  
MBR = Master Bedroom 主人睡房  
OPEN PIPE WELL = 管道井  
PD = Pipe Duct 管道槽  
POOL DECK = 日光曬台  
POOL = Swimming Pool 泳池  
RS/MRR = Refuse Storage and Material Recovery Room  
垃圾儲存及物料回收室  
SPACE FOR FILTRATION PLANT = 濾水機房位置  
STO = Store 儲物房  
T = Toilet 洗手間  
U = Up 上  
UP = Utility Platform 工作平台  
VOID ABOVE = 上層中空  
VOID = 中空  
WALK-IN CLOSET = 衣帽間  
WMC = Water Meter Cabinet 水錶箱

The internal areas of the residential properties on the upper floors will generally be slightly larger than those on the lower floors because of the reducing thickness of the structural walls on the upper floors.

Remark :  
The dimensions in the floor plans are all structural dimensions in millimetre.

因住宅物業的較高樓層的結構牆的厚度遞減，較高樓層的內部面積，一般比較低樓層的內部面積稍大。

備註：  
樓面平面圖之尺規所列數字為以毫米標示之建築結構尺寸。

# Floor plans of residential properties in the development 發展項目的住宅物業的樓面平面圖

Tower 1 26/F - 32/F  
第1座 26樓 - 32樓

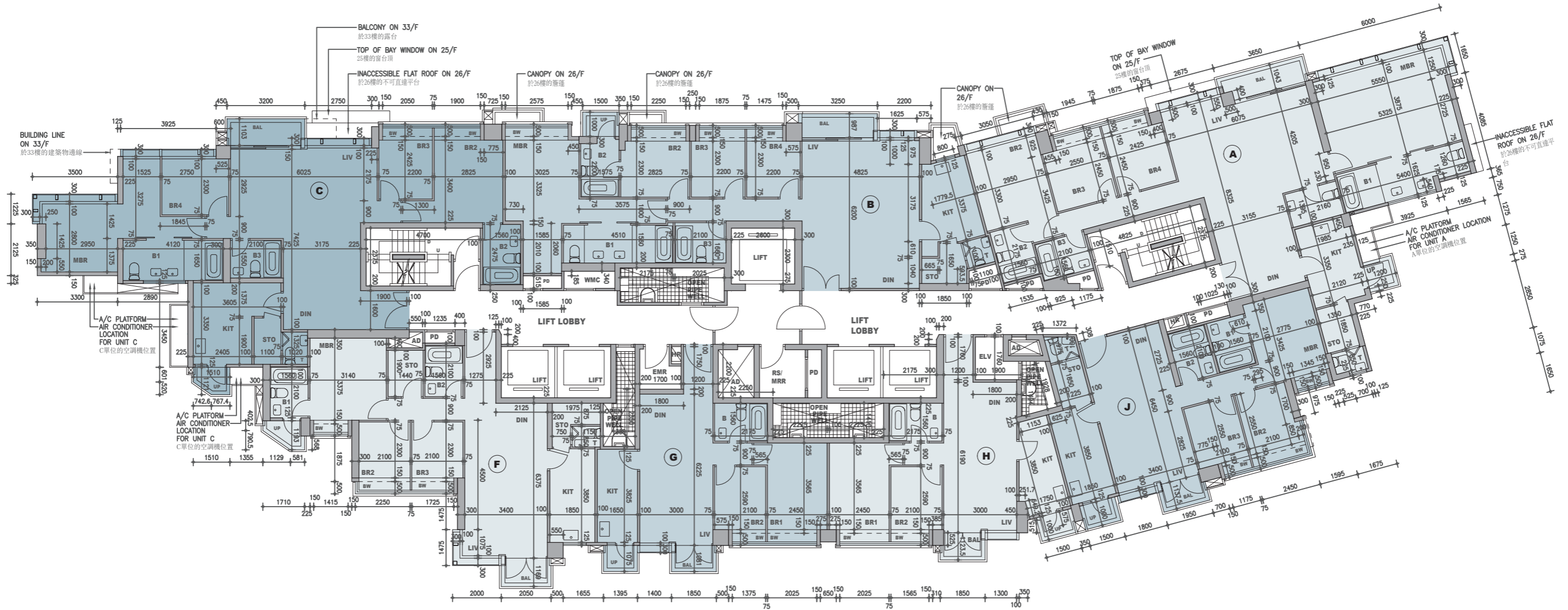

Scale 0 1 2 3 4 5M(米)  
比例

# Floor plans of residential properties in the development 發展項目的住宅物業的樓面平面圖

Tower 1 33/F  
第1座 33樓

Description 描述	Residential Unit 住宅單位					
	A	B	C	F	G	H
Floor-to-floor height (refers to the height between the top surface of the structural slab of a floor and the top surface of the structural slab of its immediate upper floor) of each residential property (m) 每個住宅物業的層與層之間的高度 (指該樓層之石屎地台面與上一層石屎地台面之高度距離)(米)	3.05 3.10 3.15 3.20 3.50 6.60*	3.10 3.20 3.30 3.50 3.55 3.65	3.20 3.50 3.55		3.20 3.25 3.50 3.55	
Thickness of the floor slabs (excluding plaster) of each residential property (mm) 每個住宅物業的樓板 (不包括灰泥)厚度(毫米)		150 200			150	

## Legend 圖例

A/C PLATFORM = Air-conditioner Platform 空調機平台  
AD = AIR DUCT = 通風槽  
BAL = Balcony 露台  
B = Bathroom 浴室  
BR = Bedroom 睡房  
BW = Bay Window 窗台  
CW = Curtain Wall 幕牆  
CANOPY = 簷蓬  
D = Down 下  
DIN = Dining Room 飯廳  
DOG HOUSE = Mechanical & Electrical Services Duct  
Connecting to the Floor Below  
連接下層的機電設施管道  
EMC = Electricity Meter Cabinet 電錶箱  
EMR = Electricity Meter Room 電錶房  
ELV = Extra Low Voltage Duct/Cabinet 低電壓槽/箱  
FAMILY = Family Area 家庭廳  
FLAT ROOF = 平台  
INACCESSIBLE FLAT ROOF = 不能直達平台  
HR = Hose Reel 消防喉轆  
KIT = Kitchen 廚房  
LIFT = 升降機  
LIFT LOBBY = 升降機大堂  
LIV = Living Room 客廳  
MBR = Master Bedroom 主人睡房  
OPEN PIPE WELL = 管道井  
PD = Pipe Duct 管道槽  
POOL DECK = 日光曬台  
POOL = Swimming Pool 泳池  
RS/MRR = Refuse Storage and Material Recovery Room  
垃圾儲存及物料回收室  
SPACE FOR FILTRATION PLANT = 濾水機房位置  
STO = Store 儲物房  
T = Toilet 洗手間  
U = Up 上  
UP = Utility Platform 工作平台  
VOID ABOVE = 上層中空  
VOID = 中空  
WALK-IN CLOSET = 衣帽間  
WMC = Water Meter Cabinet 水錶箱

The internal areas of the residential properties on the upper floors will generally be slightly larger than those on the lower floors because of the reducing thickness of the structural walls on the upper floors.

### Remarks :

- The dimensions in the floor plans are all structural dimensions in millimetre.
- The floor-to-floor height (i.e. the height between the top surface of the structural slab of that floor (i.e. 33/F) and the top surface of the structural slab of its immediate upper floor (i.e. 35/F) includes, without limitation, a mass concrete fill with thickness of 400mm, 350mm, 300mm and 100mm located partly on top of the top surface of the structural slab of that floor (i.e. 33/F).
- "\*" denotes the floor-to-floor height between the top surface of the structural slab of 33/F to the top surface of the structural slab of roof.

因住宅物業的較高樓層的結構牆的厚度遞減，較高樓層的內部面積，一般比較低樓層的內部面積稍大。

### 備註：

- 樓面平面圖之尺規所列數字為以毫米標示之建築結構尺寸。
- 層與層之間的高度(指該樓層(即33樓)之石屎地台面與上一層石屎地台面(即35樓)之高度距離)包括但不限於厚度為400毫米、350毫米、300毫米及100毫米之混凝土填充層(該等混凝土填充層有部分位於該樓層(即33樓)之石屎地台面上)。
- "\*"表示33樓之石屎地台面與天面之石屎地台面之高度。



# Floor plans of residential properties in the development 發展項目的住宅物業的樓面平面圖

Tower 1 33/F  
第1座 33樓

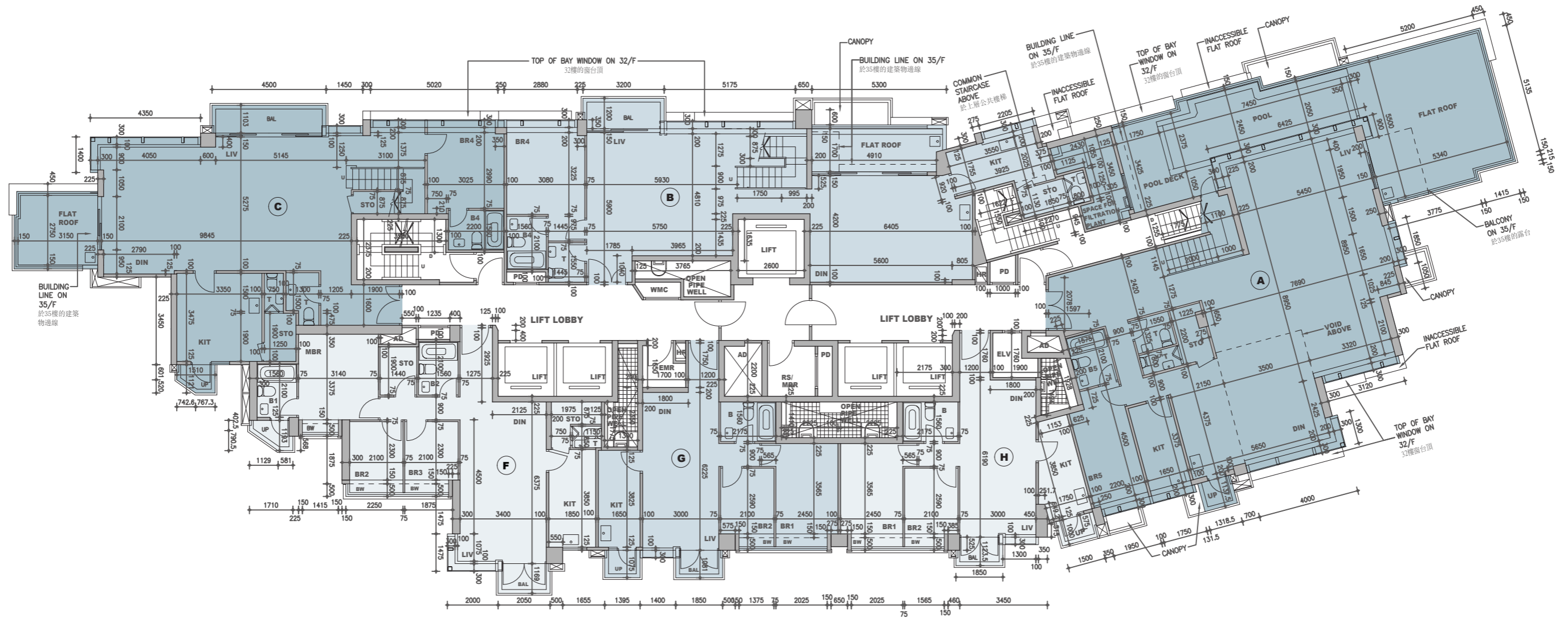

# Floor plans of residential properties in the development 發展項目的住宅物業的樓面平面圖

Tower 1 35/F  
第1座 35樓

Description 描述	Residential Unit 住宅單位					
	A	B	C	F	G	H
Floor-to-floor height (refers to the height between the top surface of the structural slab of a floor and the top surface of the structural slab of its immediate upper floor) of each residential property (m) 每個住宅物業的層與層之間的高度 (指該樓層之石屎地台面與上一層石屎地台面之高度距離)(米)	3.10 3.15 3.45 3.55		3.10 3.15 3.45		3.10 3.35 3.45	
Thickness of the floor slabs (excluding plaster) of each residential property (mm) 每個住宅物業的樓板 (不包括灰泥)厚度(毫米)		150 200			150	

## Legend 圖例

A/C PLATFORM = Air-conditioner Platform 空調機平台  
AD = AIR DUCT = 通風槽  
BAL = Balcony 露台  
B = Bathroom 浴室  
BR = Bedroom 睡房  
BW = Bay Window 窗台  
CW = Curtain Wall 幕牆  
CANOPY = 簷蓬  
D = Down 下  
DIN = Dining Room 飯廳  
DOG HOUSE = Mechanical & Electrical Services Duct  
Connecting to the Floor Below  
連接下層的機電設施管道  
EMC = Electricity Meter Cabinet 電錶箱  
EMR = Electricity Meter Room 電錶房  
ELV = Extra Low Voltage Duct/Cabinet 低電壓槽/箱  
FAMILY = Family Area 家庭廳  
FLAT ROOF = 平台  
INACCESSIBLE FLAT ROOF = 不能直達平台  
HR = Hose Reel 消防喉轆  
KIT = Kitchen 廚房  
LIFT = 升降機  
LIFT LOBBY = 升降機大堂  
LIV = Living Room 客廳  
MBR = Master Bedroom 主人睡房  
OPEN PIPE WELL = 管道井  
PD = Pipe Duct 管道槽  
POOL DECK = 日光曬台  
POOL = Swimming Pool 泳池  
RS/MRR = Refuse Storage and Material Recovery Room  
垃圾儲存及物料回收室  
SPACE FOR FILTRATION PLANT = 濾水機房位置  
STO = Store 儲物房  
T = Toilet 洗手間  
U = Up 上  
UP = Utility Platform 工作平台  
VOID ABOVE = 上層中空  
VOID = 中空  
WALK-IN CLOSET = 衣帽間  
WMC = Water Meter Cabinet 水錶箱

The internal areas of the residential properties on the upper floors will generally be slightly larger than those on the lower floors because of the reducing thickness of the structural walls on the upper floors.

Remark :  
The dimensions in the floor plans are all structural dimensions in millimetre.

因住宅物業的較高樓層的結構牆的厚度遞減，較高樓層的內部面積，一般比較低樓層的內部面積稍大。

備註：  
樓面平面圖之尺規所列數字為以毫米標示之建築結構尺寸。

# Floor plans of residential properties in the development 發展項目的住宅物業的樓面平面圖

Tower 1  
第1座 35/F  
35樓

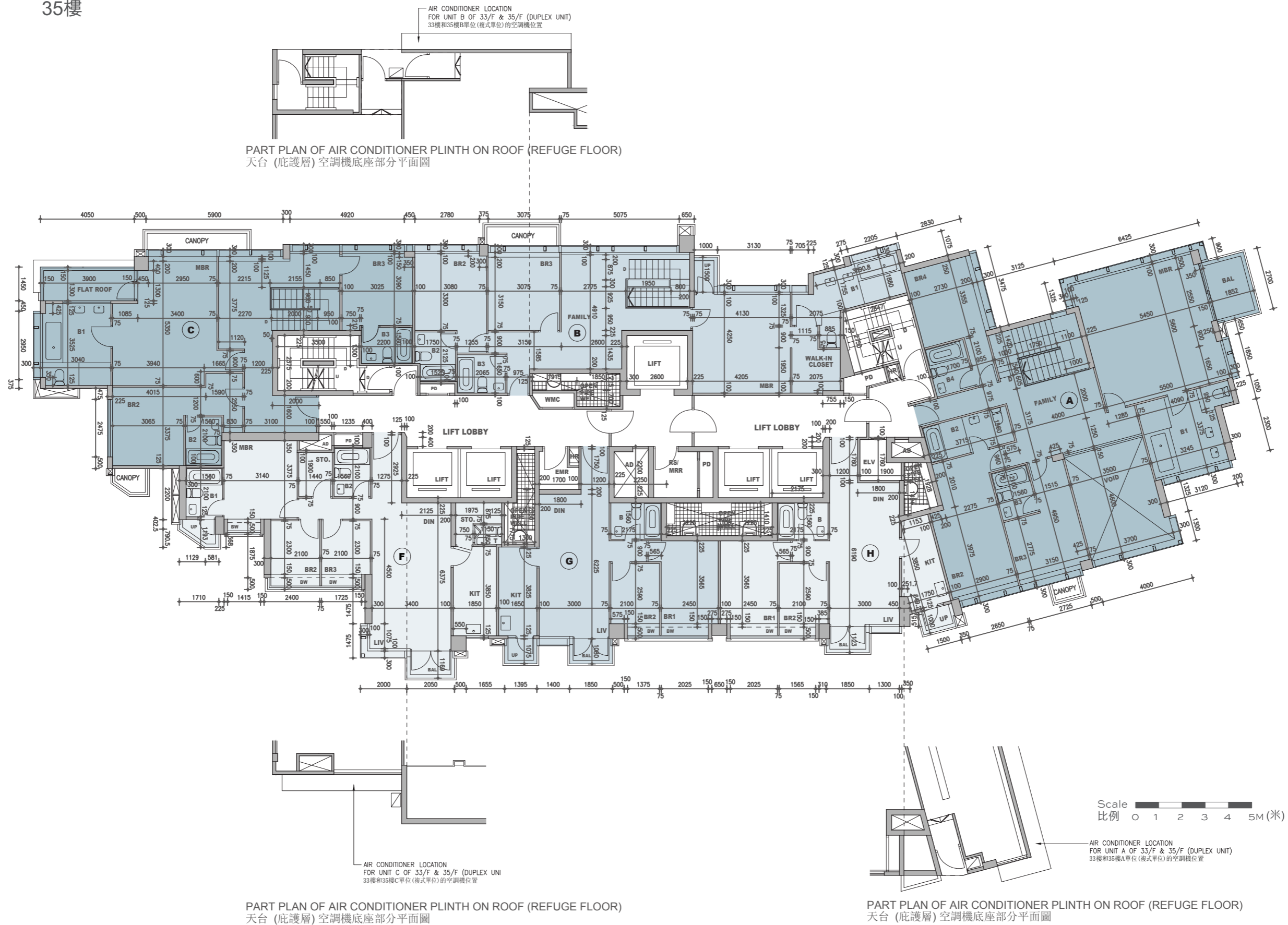



# Floor plans of residential properties in the development 發展項目的住宅物業的樓面平面圖

Tower 2 6/F  
第2座 6樓

Description 描述	Residential Unit 住宅單位							
	A	B	C	D	E	F	G	H
Floor-to-floor height (refers to the height between the top surface of the structural slab of a floor and the top surface of the structural slab of its immediate upper floor) of each residential property (m) 每個住宅物業的層與層之間的高度 (指該樓層之石屎地台面與上一層石屎地台面之高度距離)(米)					3.15 3.25 3.50			
Thickness of the floor slabs (excluding plaster) of each residential property (mm) 每個住宅物業的樓板 (不包括灰泥)厚度(毫米)					150			

## Legend 圖例

A/C PLATFORM = Air-conditioner Platform 空調機平台  
 AD = AIR DUCT = 通風槽  
 BAL = Balcony 露台  
 B = Bathroom 浴室  
 BR = Bedroom 睡房  
 BW = Bay Window 窗台  
 CW = Curtain Wall 幕牆  
 CANOPY = 簷蓬  
 D = Down 下  
 DIN = Dining Room 飯廳  
 DOG HOUSE = Mechanical & Electrical Services Duct  
 Connecting to the Floor Below  
 連接下層的機電設施管道  
 EMC = Electricity Meter Cabinet 電錶箱  
 EMR = Electricity Meter Room 電錶房  
 ELV = Extra Low Voltage Duct/Cabinet 低電壓槽/箱  
 FAMILY = Family Area 家庭廳  
 FLAT ROOF = 平台  
 INACCESSIBLE FLAT ROOF = 不能直達平台  
 HR = Hose Reel 消防喉轆  
 KIT = Kitchen 廚房  
 LIFT = 升降機  
 LIFT LOBBY = 升降機大堂  
 LIV = Living Room 客廳  
 MBR = Master Bedroom 主人睡房  
 OPEN PIPE WELL = 管道井  
 PD = Pipe Duct 管道槽  
 POOL DECK = 日光曬台  
 POOL = Swimming Pool 泳池  
 RS/MRR = Refuse Storage and Material Recovery Room  
 垃圾儲存及物料回收室  
 SPACE FOR FILTRATION PLANT = 濾水機房位置  
 STO = Store 儲物房  
 T = Toilet 洗手間  
 U = Up 上  
 UP = Utility Platform 工作平台  
 VOID ABOVE = 上層中空  
 VOID = 中空  
 WALK-IN CLOSET = 衣帽間  
 WMC = Water Meter Cabinet 水錶箱

The internal areas of the residential properties on the upper floors will generally be slightly larger than those on the lower floors because of the reducing thickness of the structural walls on the upper floors.

### Remarks :

- The dimensions in the floor plans are all structural dimensions in millimetre.
- The floor-to-floor height (i.e. the height between the top surface of the structural slab of that floor (i.e. 6/F) and the top surface of the structural slab of its immediate upper floor (i.e. 7/F)) includes, without limitation, a mass concrete fill with thickness of 500mm, 350mm, 250mm and 150mm located partly on top of the top surface of the structural slab of that floor (i.e. 6/F).

因住宅物業的較高樓層的結構牆的厚度遞減，較高樓層的內部面積，一般比較低樓層的內部面積稍大。

### 備註：

- 樓面平面圖之尺規所列數字為以毫米標示之建築結構尺寸。
- 層與層之間的高度(指該樓層(即6樓)之石屎地台面與上一層石屎地台面(即7樓)之高度距離)包括但不限於厚度為500毫米、350毫米、250毫米及150毫米之混凝土填充層(該等混凝土填充層有部分位於該樓層(即6樓)之石屎地台面之上)。

# Floor plans of residential properties in the development 發展項目的住宅物業的樓面平面圖

Tower 2 第2座  
6/F 6樓

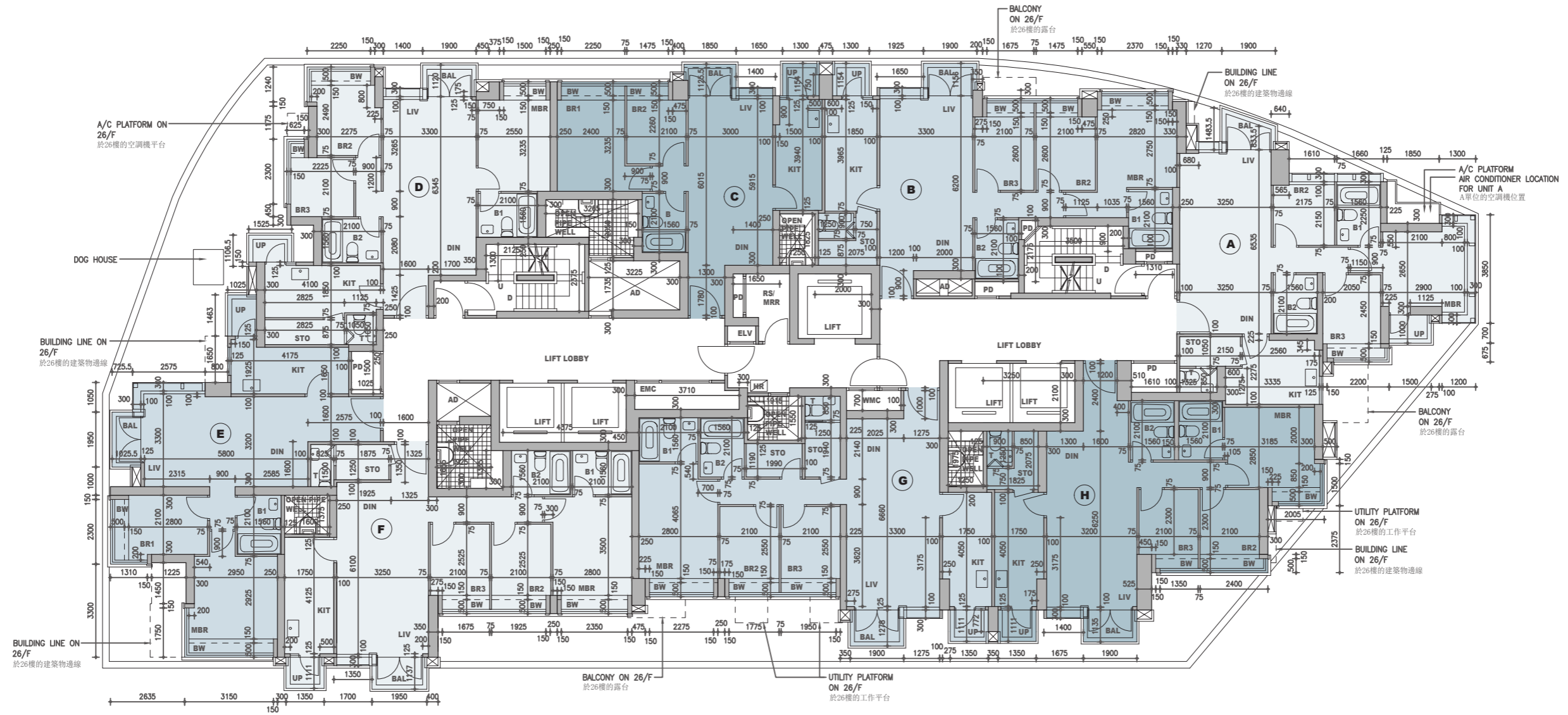

Scale 比例 0 1 2 3 4 5M(米)

# Floor plans of residential properties in the development 發展項目的住宅物業的樓面平面圖

Tower 2 7/F - 12/F, 15/F - 23/F & 25/F (13/F, 14/F & 24/F are omitted)  
第2座 7樓 - 12樓、15樓 - 23樓及25樓(不設13樓、14樓及24樓)

Description 描述		Residential Unit 住宅單位							
		A	B	C	D	E	F	G	H
Floor-to-floor height (refers to the height between the top surface of the structural slab of a floor and the top surface of the structural slab of its immediate upper floor) of each residential property (m) 每個住宅物業的層與層之間的高度(指該樓層之石屎地台面與上一層石屎地台面之高度距離)(米)	7/F - 12/F & 15/F - 23/F 7樓 - 12樓及15樓 - 23樓	3.00							
	25/F 25樓	3.45	3.50	3.50	3.50	3.50	3.50	3.50	3.50
Thickness of the floor slabs (excluding plaster) of each residential property (mm) 每個住宅物業的樓板(不包括灰泥)厚度(毫米)	7/F - 12/F & 15/F - 23/F 7樓 - 12樓及15樓 - 23樓	150							
	25/F 25樓	150		150	175	150			

## Legend 圖例

A/C PLATFORM = Air-conditioner Platform 空調機平台  
AD = AIR DUCT = 通風槽  
BAL = Balcony 露台  
B = Bathroom 浴室  
BR = Bedroom 睡房  
BW = Bay Window 窗台  
CW = Curtain Wall 幕牆  
CANOPY = 簷蓬  
D = Down 下  
DIN = Dining Room 飯廳  
DOG HOUSE = Mechanical & Electrical Services Duct Connecting to the Floor Below  
連接下層的機電設施管道  
EMC = Electricity Meter Cabinet 電錶箱  
EMR = Electricity Meter Room 電錶房  
ELV = Extra Low Voltage Duct/Cabinet 低電壓槽/箱  
FAMILY = Family Area 家庭廳  
FLAT ROOF = 平台  
INACCESSIBLE FLAT ROOF = 不能直達平台  
HR = Hose Reel 消防喉轆  
KIT = Kitchen 廚房  
LIFT = 升降機  
LIFT LOBBY = 升降機大堂  
LIV = Living Room 客廳  
MBR = Master Bedroom 主人睡房  
OPEN PIPE WELL = 管道井  
PD = Pipe Duct 管道槽  
POOL DECK = 日光曬台  
POOL = Swimming Pool 泳池  
RS/MRR = Refuse Storage and Material Recovery Room  
垃圾儲存及物料回收室  
SPACE FOR FILTRATION PLANT = 濾水機房位置  
STO = Store 儲物房  
T = Toilet 洗手間  
U = Up 上  
UP = Utility Platform 工作平台  
VOID ABOVE = 上層中空  
VOID = 中空  
WALK-IN CLOSET = 衣帽間  
WMC = Water Meter Cabinet 水錶箱

The internal areas of the residential properties on the upper floors will generally be slightly larger than those on the lower floors because of the reducing thickness of the structural walls on the upper floors.

### Remarks :

- The dimensions in the floor plans are all structural dimensions in millimetre.
- There is/are a void(s) in between the double structural floor slabs of various thickness (namely, (i) 150mm and 150mm, and (ii) 175mm and 175mm respectively), which slabs are located in between 25/F and 26/F. The floor-to-floor height of residential units on 25/F (i.e. the height between the top surface of the structural slab of that floor (i.e. 25/F) and the top surface of the structural slab of its immediate upper floor (i.e. 26/F)) includes, without limitation, the height of void(s) of 700mm, 650mm, 450mm, 350mm and 300mm in between the double structural slabs.
- There is a structure of maximum 1000mm thick located in between 25/F and 26/F. The floor-to-floor height of residential unit(s) on 25/F (i.e. the height between the top surface of the structural slab of that floor (i.e. 25/F) and the top surface of the structural slab of its immediate upper floor (i.e. 26/F)) includes, without limitation, the thickness of the structure.

因住宅物業的較高樓層的結構牆的厚度遞減，較高樓層的內部面積，一般比較低樓層的內部面積稍大。

### 備註：

- 樓面平面圖之尺規所列數字為以毫米標示之建築結構尺寸。
- 雙層石屎樓層地台(其厚度各有不同，分別為(i)150毫米及150毫米及(ii)175毫米及175毫米)之間存有空心位置，該等地台位於25樓及26樓之間。25樓的住宅單位的層與層之間的高度(指該樓層(即25樓)之石屎地台面與上一層石屎地台面(即26樓)之高度距離)包括但不限於雙層石屎地台之間之空心位置的高度(高度為700毫米、650毫米、450毫米、350毫米及300毫米)。
- 厚度不多於1000毫米的結構位於25樓及26樓之間。25樓的住宅單位層與層之間的高度(指該樓層(即25樓)之石屎地台面與上一層石屎地台面(即26樓)之高度距離)包括但不限於該結構的厚度。



# Floor plans of residential properties in the development 發展項目的住宅物業的樓面平面圖

Tower 2 第2座 7/F - 12/F, 15/F - 23/F & 25/F (13/F, 14/F & 24/F are omitted)  
7樓 - 12樓、15樓 - 23樓及25樓(不設13樓、14樓及24樓)

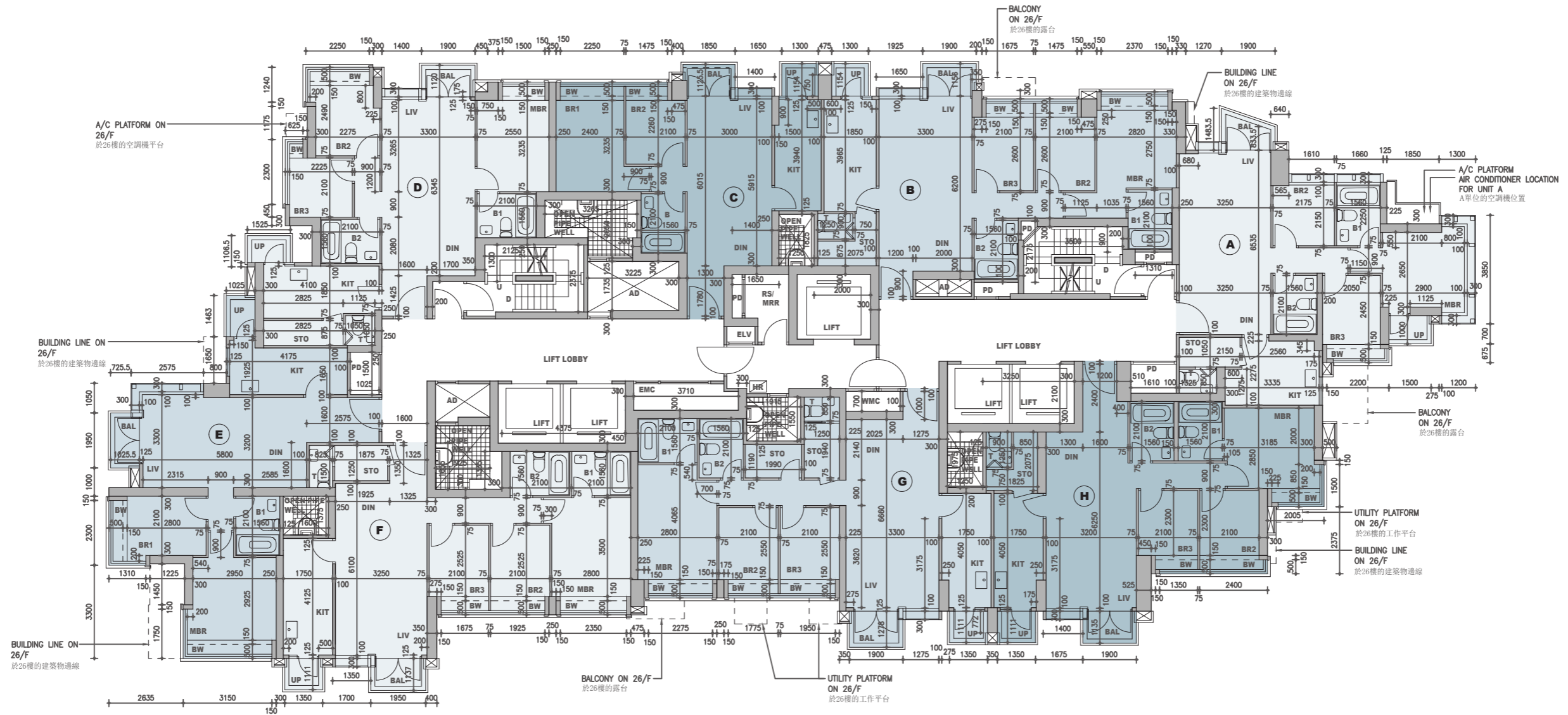

Scale 比例 0 1 2 3 4 5M(米)

# Floor plans of residential properties in the development 發展項目的住宅物業的樓面平面圖

Tower 2 26/F - 32/F  
第2座 26樓 - 32樓

Description 描述		Residential Unit 住宅單位					
		A	B	C	E	F	G
Floor-to-floor height (refers to the height between the top surface of the structural slab of a floor and the top surface of the structural slab of its immediate upper floor) of each residential property (m) 每個住宅物業的層與層之間的高度 (指該樓層之石屎地台面與上一層石屎地台面之高度距離)(米)	26/F - 31/F 26樓 - 31樓	3.10					
	32/F 32樓	3.10 3.15 3.45 3.50 3.55	3.10 3.15 3.20 3.35 3.45	3.10 3.15 3.35 3.40 3.45 3.50	3.00 3.10 3.15 3.25 3.45 3.50	3.10 3.15 3.20 3.35 3.45	3.10 3.15 3.35 3.45 3.50
Thickness of the floor slabs (excluding plaster) of each residential property (mm) 每個住宅物業的樓板 (不包括灰泥)厚度(毫米)	26/F - 31/F 26樓 - 31樓	150					
	32/F 32樓	150 200	200	150 200	200		

## Legend 圖例

A/C PLATFORM = Air-conditioner Platform 空調機平台  
AD = AIR DUCT = 通風槽  
BAL = Balcony 露台  
B = Bathroom 浴室  
BR = Bedroom 睡房  
BW = Bay Window 窗台  
CW = Curtain Wall 幕牆  
CANOPY = 簷蓬  
D = Down 下  
DIN = Dining Room 飯廳  
DOG HOUSE = Mechanical & Electrical Services Duct  
Connecting to the Floor Below  
連接下層的機電設施管道  
EMC = Electricity Meter Cabinet 電錶箱  
EMR = Electricity Meter Room 電錶房  
ELV = Extra Low Voltage Duct/Cabinet 低電壓槽/箱  
FAMILY = Family Area 家庭廳  
FLAT ROOF = 平台  
INACCESSIBLE FLAT ROOF = 不能直達平台  
HR = Hose Reel 消防喉轆  
KIT = Kitchen 廚房  
LIFT = 升降機  
LIFT LOBBY = 升降機大堂  
LIV = Living Room 客廳  
MBR = Master Bedroom 主人睡房  
OPEN PIPE WELL = 管道井  
PD = Pipe Duct 管道槽  
POOL DECK = 日光曬台  
POOL = Swimming Pool 泳池  
RS/MRR = Refuse Storage and Material Recovery Room  
垃圾儲存及物料回收室  
SPACE FOR FILTRATION PLANT = 濾水機房位置  
STO = Store 儲物房  
T = Toilet 洗手間  
U = Up 上  
UP = Utility Platform 工作平台  
VOID ABOVE = 上層中空  
VOID = 中空  
WALK-IN CLOSET = 衣帽間  
WMC = Water Meter Cabinet 水錶箱

The internal areas of the residential properties on the upper floors will generally be slightly larger than those on the lower floors because of the reducing thickness of the structural walls on the upper floors.

Remark :  
The dimensions in the floor plans are all structural dimensions in millimetre.

因住宅物業的較高樓層的結構牆的厚度遞減，較高樓層的內部面積，一般比較低樓層的內部面積稍大。

備註：  
樓面平面圖之尺規所列數字為以毫米標示之建築結構尺寸。

# Floor plans of residential properties in the development 發展項目的住宅物業的樓面平面圖

Tower 2 26/F - 32/F  
第2座 26樓 - 32樓

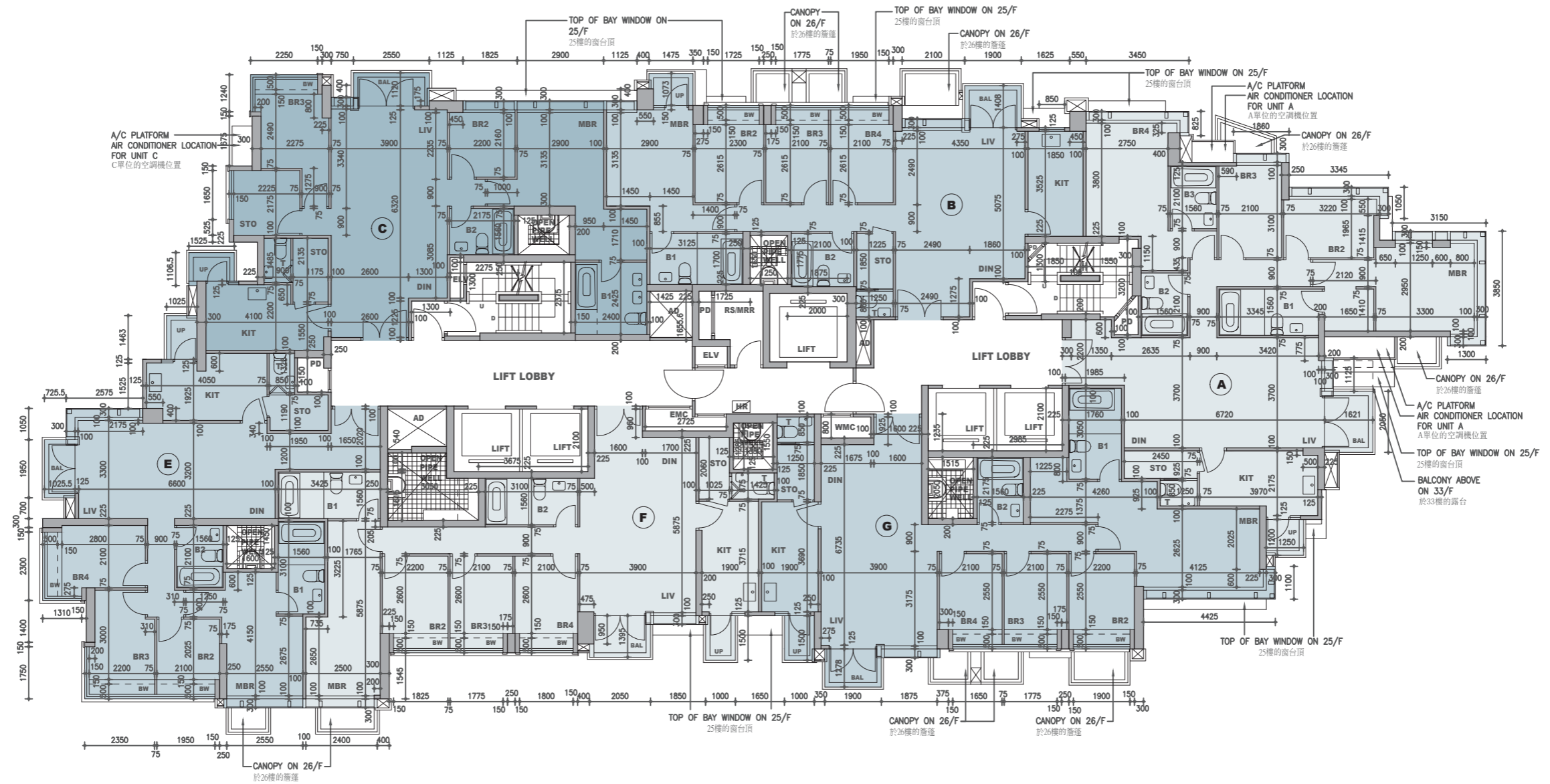

Scale 0 1 2 3 4 5M(米)  
比例



# Floor plans of residential properties in the development 發展項目的住宅物業的樓面平面圖

Tower 2 33/F  
第2座 33樓

Description 描述	Residential Unit 住宅單位					
	A	B	C	E	F	G
Floor-to-floor height (refers to the height between the top surface of the structural slab of a floor and the top surface of the structural slab of its immediate upper floor) of each residential property (m) 每個住宅物業的層與層之間的高度 (指該樓層之石屎地台面與上一層石屎地台面之高度距離)(米)				3.15		
	3.10	3.20	3.10	3.20	3.20	3.20
	3.20	3.30	3.15	3.45	3.25	3.25
	3.50	3.50	3.20	3.50	3.50	3.30
	3.55	3.55	3.50	3.55	3.55	3.50
Thickness of the floor slabs (excluding plaster) of each residential property (mm) 每個住宅物業的樓板 (不包括灰泥)厚度(毫米)	150		150			
	250		200		150	

## Legend 圖例

- A/C PLATFORM = Air-conditioner Platform 空調機平台
- AD = AIR DUCT = 通風槽
- BAL = Balcony 露台
- B = Bathroom 浴室
- BR = Bedroom 睡房
- BW = Bay Window 窗台
- CW = Curtain Wall 幕牆
- CANOPY = 簷蓬
- D = Down 下
- DIN = Dining Room 飯廳
- DOG HOUSE = Mechanical & Electrical Services Duct  
Connecting to the Floor Below  
連接下層的機電設施管道
- EMC = Electricity Meter Cabinet 電錶箱
- EMR = Electricity Meter Room 電錶房
- ELV = Extra Low Voltage Duct/Cabinet 低電壓槽/箱
- FAMILY = Family Area 家庭廳
- FLAT ROOF = 平台
- INACCESSIBLE FLAT ROOF = 不能直達平台
- HR = Hose Reel 消防喉轆
- KIT = Kitchen 廚房
- LIFT = 升降機
- LIFT LOBBY = 升降機大堂
- LIV = Living Room 客廳
- MBR = Master Bedroom 主人睡房
- OPEN PIPE WELL = 管道井
- PD = Pipe Duct 管道槽
- POOL DECK = 日光曬台
- POOL = Swimming Pool 泳池
- RS/MRR = Refuse Storage and Material Recovery Room  
垃圾儲存及物料回收室
- SPACE FOR FILTRATION PLANT = 濾水機房位置
- STO = Store 儲物房
- T = Toilet 洗手間
- U = Up 上
- UP = Utility Platform 工作平台
- VOID ABOVE = 上層中空
- VOID = 中空
- WALK-IN CLOSET = 衣帽間
- WMC = Water Meter Cabinet 水錶箱

The internal areas of the residential properties on the upper floors will generally be slightly larger than those on the lower floors because of the reducing thickness of the structural walls on the upper floors.

### Remarks :

1. The dimensions in the floor plans are all structural dimensions in millimetre.
2. The floor-to-floor height (i.e. the height between the top surface of the structural slab of that floor (i.e. 33/F) and the top surface of the structural slab of its immediate upper floor (i.e. 35/F) includes, without limitation, a mass concrete fill with thickness of 400mm, 350mm, 300mm and 100mm located partly on top of the top surface of the structural slab of that floor (i.e. 33/F).

因住宅物業的較高樓層的結構牆的厚度遞減，較高樓層的內部面積，一般比較低樓層的內部面積稍大。

### 備註：

1. 樓面平面圖之尺規所列數字為以毫米標示之建築結構尺寸。
2. 層與層之間的高度(指該樓層(即33樓)之石屎地台面與上一層石屎地台面(即35樓)之高度距離)包括但不限於厚度為400毫米、350毫米、300毫米及100毫米之混凝土填充層(該等混凝土填充層有部分位於該樓層(即33樓)之石屎地台面之上)。

# Floor plans of residential properties in the development 發展項目的住宅物業的樓面平面圖

Tower 2 33/F  
第2座 33樓

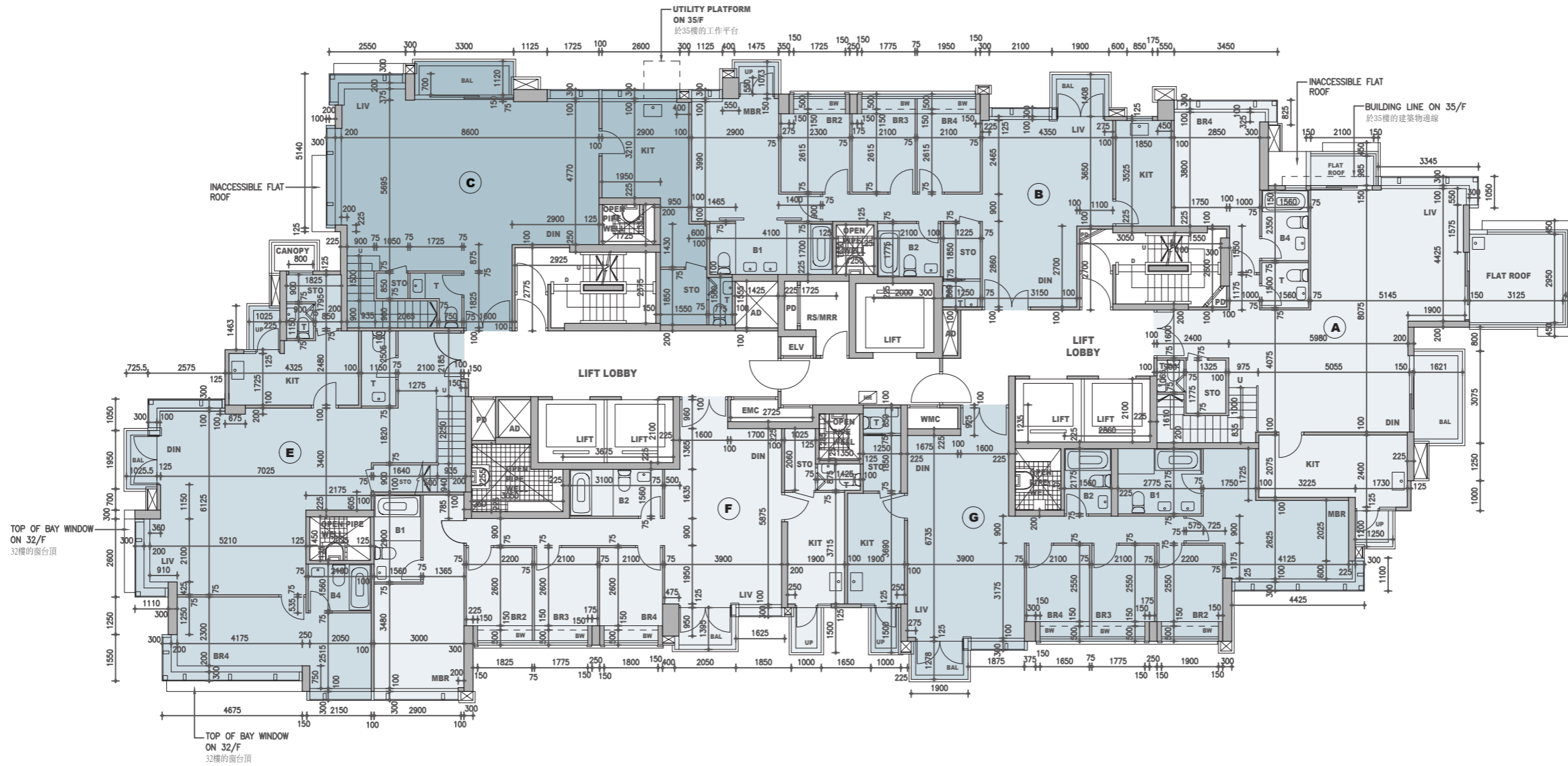

Scale 0 1 2 3 4 5M(米)  
比例

# Floor plans of residential properties in the development 發展項目的住宅物業的樓面平面圖

Tower 2 35/F  
第2座 35樓

Description 描述	Residential Unit 住宅單位					
	A	B	C	E	F	G
Floor-to-floor height (refers to the height between the top surface of the structural slab of a floor and the top surface of the structural slab of its immediate upper floor) of each residential property (m) 每個住宅物業的層與層之間的高度 (指該樓層之石屎地台面與上一層石屎地台面之高度距離)(米)	3.10 3.15 3.45 3.50 3.55	3.10 3.15 3.35 3.45	3.10 3.15 3.45 3.50	3.10 3.15 3.45	3.10 3.15 3.35 3.45	3.10 3.35 3.45
Thickness of the floor slabs (excluding plaster) of each residential property (mm) 每個住宅物業的樓板 (不包括灰泥)厚度(毫米)		150 200			150	150 200

## Legend 圖例

A/C PLATFORM = Air-conditioner Platform 空調機平台  
AD = AIR DUCT = 通風槽  
BAL = Balcony 露台  
B = Bathroom 浴室  
BR = Bedroom 睡房  
BW = Bay Window 窗台  
CW = Curtain Wall 幕牆  
CANOPY = 簷蓬  
D = Down 下  
DIN = Dining Room 飯廳  
DOG HOUSE = Mechanical & Electrical Services Duct  
Connecting to the Floor Below  
連接下層的機電設施管道  
EMC = Electricity Meter Cabinet 電錶箱  
EMR = Electricity Meter Room 電錶房  
ELV = Extra Low Voltage Duct/Cabinet 低電壓槽/箱  
FAMILY = Family Area 家庭廳  
FLAT ROOF = 平台  
INACCESSIBLE FLAT ROOF = 不能直達平台  
HR = Hose Reel 消防喉轆  
KIT = Kitchen 廚房  
LIFT = 升降機  
LIFT LOBBY = 升降機大堂  
LIV = Living Room 客廳  
MBR = Master Bedroom 主人睡房  
OPEN PIPE WELL = 管道井  
PD = Pipe Duct 管道槽  
POOL DECK = 日光曬台  
POOL = Swimming Pool 泳池  
RS/MRR = Refuse Storage and Material Recovery Room  
垃圾儲存及物料回收室  
SPACE FOR FILTRATION PLANT = 濾水機房位置  
STO = Store 儲物房  
T = Toilet 洗手間  
U = Up 上  
UP = Utility Platform 工作平台  
VOID ABOVE = 上層中空  
VOID = 中空  
WALK-IN CLOSET = 衣帽間  
WMC = Water Meter Cabinet 水錶箱

The internal areas of the residential properties on the upper floors will generally be slightly larger than those on the lower floors because of the reducing thickness of the structural walls on the upper floors.

Remark :  
The dimensions in the floor plans are all structural dimensions in millimetre.

因住宅物業的較高樓層的結構牆的厚度遞減，較高樓層的內部面積，一般比較低樓層的內部面積稍大。

備註：  
樓面平面圖之尺規所列數字為以毫米標示之建築結構尺寸。



# Floor plans of residential properties in the development 發展項目的住宅物業的樓面平面圖

Tower 2 35/F  
第2座 35樓

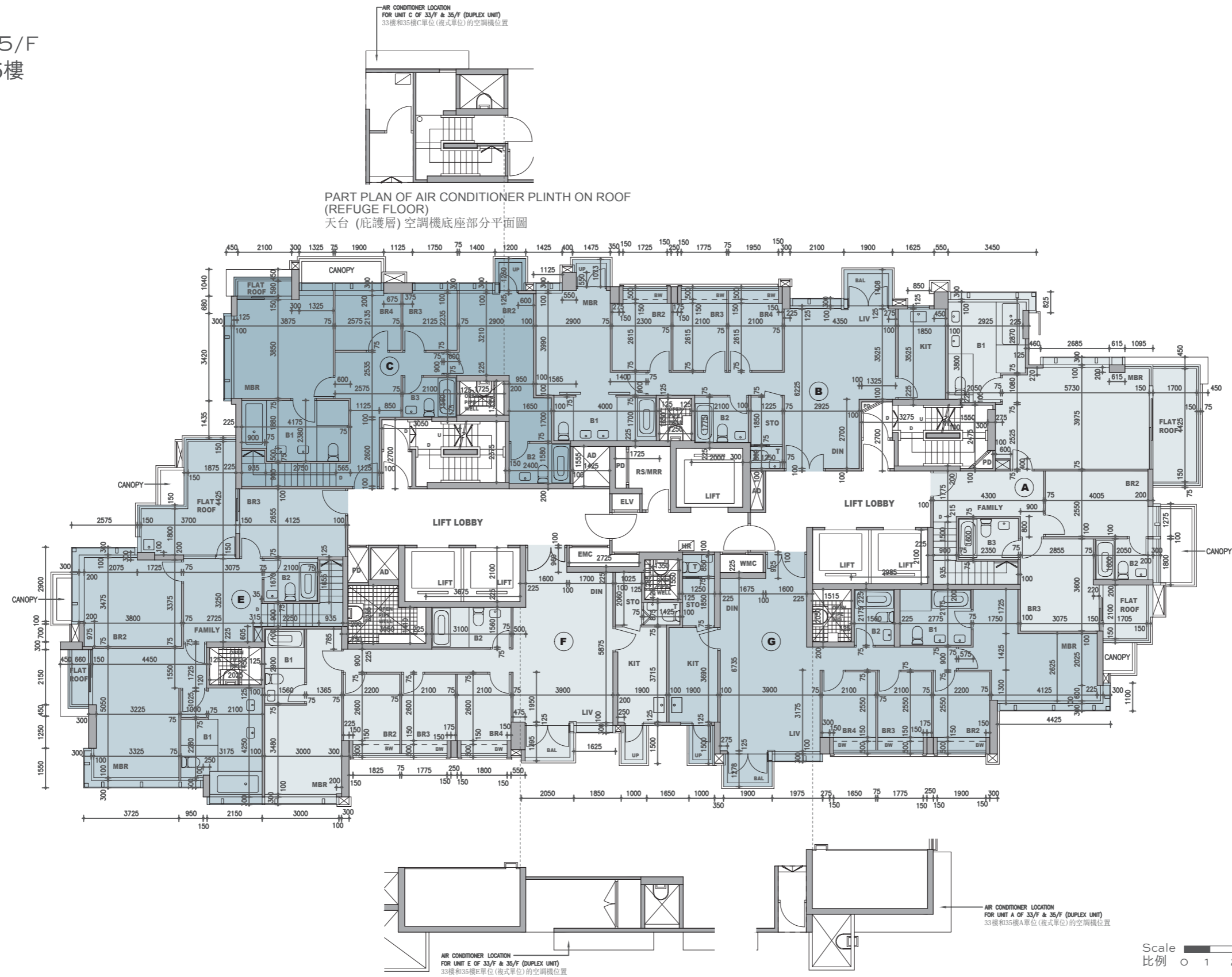

PART PLAN OF AIR CONDITIONER PLINTH ON ROOF (REFUGE FLOOR)  
天台(庇護層)空調機底座部分平面圖

PART PLAN OF AIR CONDITIONER PLINTH ON ROOF (REFUGE FLOOR)  
天台(庇護層)空調機底座部分平面圖

Scale 0 1 2 3 4 5M(米)  
比例

# Floor plans of residential properties in the development 發展項目的住宅物業的樓面平面圖

Tower 3 6/F  
第3座 6樓

Description 描述	Residential Unit 住宅單位									
	A	B	C	D	E	F	G	H	J	
Floor-to-floor height (refers to the height between the top surface of the structural slab of a floor and the top surface of the structural slab of its immediate upper floor) of each residential property (m) 每個住宅物業的層與層之間的高度 (指該樓層之石屎地台面與上一層石屎地台面之高度距離)(米)	3.15 3.25 3.50		3.15 3.25 3.45 3.50				3.15 3.25 3.50			
Thickness of the floor slabs (excluding plaster) of each residential property (mm) 每個住宅物業的樓板 (不包括灰泥)厚度(毫米)	150									

## Legend 圖例

A/C PLATFORM = Air-conditioner Platform 空調機平台  
 AD = AIR DUCT = 通風槽  
 BAL = Balcony 露台  
 B = Bathroom 浴室  
 BR = Bedroom 睡房  
 BW = Bay Window 窗台  
 CW = Curtain Wall 幕牆  
 CANOPY = 簷蓬  
 D = Down 下  
 DIN = Dining Room 飯廳  
 DOG HOUSE = Mechanical & Electrical Services Duct  
 Connecting to the Floor Below  
 連接下層的機電設施管道  
 EMC = Electricity Meter Cabinet 電錶箱  
 EMR = Electricity Meter Room 電錶房  
 ELV = Extra Low Voltage Duct/Cabinet 低電壓槽/箱  
 FAMILY = Family Area 家庭廳  
 FLAT ROOF = 平台  
 INACCESSIBLE FLAT ROOF = 不能直達平台  
 HR = Hose Reel 消防喉轆  
 KIT = Kitchen 廚房  
 LIFT = 升降機  
 LIFT LOBBY = 升降機大堂  
 LIV = Living Room 客廳  
 MBR = Master Bedroom 主人睡房  
 OPEN PIPE WELL = 管道井  
 PD = Pipe Duct 管道槽  
 POOL DECK = 日光曬台  
 POOL = Swimming Pool 泳池  
 RS/MRR = Refuse Storage and Material Recovery Room  
 垃圾儲存及物料回收室  
 SPACE FOR FILTRATION PLANT = 濾水機房位置  
 STO = Store 儲物房  
 T = Toilet 洗手間  
 U = Up 上  
 UP = Utility Platform 工作平台  
 VOID ABOVE = 上層中空  
 VOID = 中空  
 WALK-IN CLOSET = 衣帽間  
 WMC = Water Meter Cabinet 水錶箱

The internal areas of the residential properties on the upper floors will generally be slightly larger than those on the lower floors because of the reducing thickness of the structural walls on the upper floors.

### Remarks :

- The dimensions in the floor plans are all structural dimensions in millimetre.
- The floor-to-floor height (i.e. the height between the top surface of the structural slab of that floor (i.e. 6/F) and the top surface of the structural slab of its immediate upper floor (i.e. 7/F)) includes, without limitation, a mass concrete fill with thickness of 500mm, 350mm, 250mm and 150mm located partly on top of the top surface of the structural slab of that floor (i.e. 6/F).

因住宅物業的較高樓層的結構牆的厚度遞減，較高樓層的內部面積，一般比較低樓層的內部面積稍大。

### 備註：

- 樓面平面圖之尺規所列數字為以毫米標示之建築結構尺寸。
- 層與層之間的高度(指該樓層(即6樓)之石屎地台面與上一層石屎地台面(即7樓)之高度距離)包括但不限於厚度為500毫米、350毫米、250毫米及150毫米之混凝土填充層(該等混凝土填充層有部分位於該樓層(即6樓)之石屎地台面之上)。

# Floor plans of residential properties in the development 發展項目的住宅物業的樓面平面圖

Tower 3 第3座  
6/F 6樓

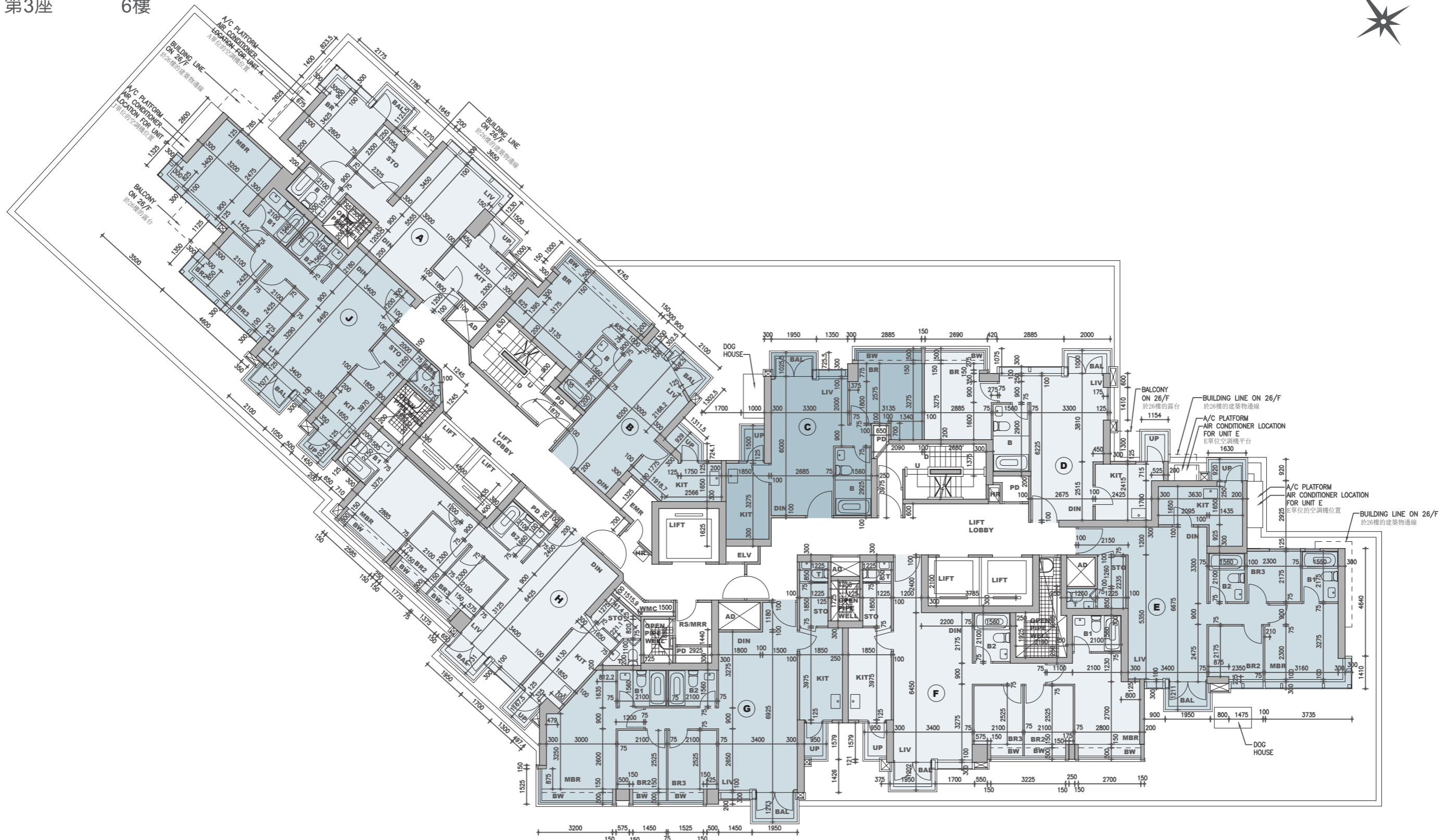
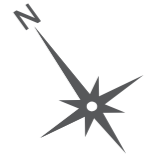

Scale 比例 0 1 2 3 4 5M(米)



# Floor plans of residential properties in the development 發展項目的住宅物業的樓面平面圖

Tower 3 7/F - 12/F, 15/F - 23/F & 25/F (13/F, 14/F & 24/F are omitted)  
第3座 7樓 - 12樓、15樓 - 23樓及25樓(不設13樓、14樓及24樓)

Description 描述		Residential Unit 住宅單位									
		A	B	C	D	E	F	G	H	J	
Floor-to-floor height (refers to the height between the top surface of the structural slab of a floor and the top surface of the structural slab of its immediate upper floor) of each residential property (m) 每個住宅物業的層與層之間的高度(指該樓層之石屎地台面與上一層石屎地台面之高度距離)(米)	7/F - 12/F & 15/F - 23/F 7樓 - 12樓及15樓 - 23樓	3.00									
	25/F 25樓	3.45 3.50 3.75 3.85 4.10 4.20	3.50 3.60 3.75 3.85 3.90 4.10 4.20	3.50 3.75 3.85 3.90 4.20	3.50 3.60 3.85 3.90 4.10 4.20	3.50 3.80 3.85 4.10 4.20	3.85			3.60 3.85 3.90 4.10 4.20	
Thickness of the floor slabs (excluding plaster) of each residential property (mm) 每個住宅物業的樓板(不包括灰泥)厚度(毫米)	7/F - 12/F & 15/F - 23/F 7樓 - 12樓及15樓 - 23樓	150									
	25/F 25樓	150 1000	150			150 1000	150			150 175 1000	

## Legend 圖例

A/C PLATFORM = Air-conditioner Platform 空調機平台  
AD = AIR DUCT = 通風槽  
BAL = Balcony 露台  
B = Bathroom 浴室  
BR = Bedroom 睡房  
BW = Bay Window 窗台  
CW = Curtain Wall 幕牆  
CANOPY = 簷蓬  
D = Down 下  
DIN = Dining Room 飯廳  
DOG HOUSE = Mechanical & Electrical Services Duct Connecting to the Floor Below  
連接下層的機電設施管道  
EMC = Electricity Meter Cabinet 電錶箱  
EMR = Electricity Meter Room 電錶房  
ELV = Extra Low Voltage Duct/Cabinet 低電壓槽/箱  
FAMILY = Family Area 家庭廳  
FLAT ROOF = 平台  
INACCESSIBLE FLAT ROOF = 不能直達平台  
HR = Hose Reel 消防喉轆  
KIT = Kitchen 廚房  
LIFT = 升降機  
LIFT LOBBY = 升降機大堂  
LIV = Living Room 客廳  
MBR = Master Bedroom 主人睡房  
OPEN PIPE WELL = 管道井  
PD = Pipe Duct 管道槽  
POOL DECK = 日光曬台  
POOL = Swimming Pool 泳池  
RS/MRR = Refuse Storage and Material Recovery Room 垃圾儲存及物料回收室  
SPACE FOR FILTRATION PLANT = 濾水機房位置  
STO = Store 儲物房  
T = Toilet 洗手間  
U = Up 上  
UP = Utility Platform 工作平台  
VOID ABOVE = 上層中空  
VOID = 中空  
WALK-IN CLOSET = 衣帽間  
WMC = Water Meter Cabinet 水錶箱

The internal areas of the residential properties on the upper floors will generally be slightly larger than those on the lower floors because of the reducing thickness of the structural walls on the upper floors.

### Remarks :

- The dimensions in the floor plans are all structural dimensions in millimetre.
- There is/are a void(s) in between the double structural floor slabs of various thickness (namely, (i) 150mm and 150mm, and (ii) 175mm and 150mm respectively), which slabs are located in between 25/F and 26/F. The floor-to-floor height of residential units on 25/F (i.e. the height between the top surface of the structural slab of that floor (i.e. 25/F) and the top surface of the structural slab of its immediate upper floor (i.e. 26/F)) includes, without limitation, the height of void(s) of 700mm, 675mm, 450mm, 350mm, 325mm, and 300mm in between the double structural slabs.
- There is a structure of maximum 1000mm thick located in between 25/F and 26/F. The floor-to-floor height of residential unit(s) on 25/F (i.e. the height between the top surface of the structural slab of that floor (i.e. 25/F) and the top surface of the structural slab of its immediate upper floor (i.e. 26/F)) includes, without limitation, the thickness of the structure.

因住宅物業的較高樓層的結構牆的厚度遞減，較高樓層的內部面積，一般比較低樓層的內部面積稍大。

### 備註：

- 樓面平面圖之尺規所列數字為以毫米標示之建築結構尺寸。
- 雙層石屎樓層地台(其厚度各有不同，分別為(i)150毫米及150毫米及(ii)175毫米及150毫米)之間存有空心位置，該等地台位於25樓及26樓之間。25樓的住宅單位的層與層之間的高度(指該樓層(即25樓)之石屎地台面與上一層石屎地台面(即26樓)之高度距離)包括但不限於雙層石屎地台之間的空心位置的高度(高度為700毫米、675毫米、450毫米、350毫米、325毫米及300毫米)。
- 厚度不多於1000毫米的結構位於25樓及26樓之間。25樓的住宅單位層與層之間的高度(指該樓層(即25樓)之石屎地台面與上一層石屎地台面(即26樓)之高度距離)包括但不限於該結構的厚度。

# Floor plans of residential properties in the development 發展項目的住宅物業的樓面平面圖

Tower 3 7/F - 12/F, 15/F - 23/F & 25/F (13/F, 14/F & 24/F are omitted)  
第3座 7樓 - 12樓、15樓 - 23樓及25樓(不設13樓、14樓及24樓)

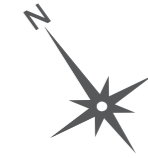

# Floor plans of residential properties in the development 發展項目的住宅物業的樓面平面圖

Tower 3 26/F - 32/F  
第3座 26樓 - 32樓

Description 描述		Residential Unit 住宅單位					
		A	B	C	D	F	G
Floor-to-floor height (refers to the height between the top surface of the structural slab of a floor and the top surface of the structural slab of its immediate upper floor) of each residential property (m) 每個住宅物業的層與層之間的高度 (指該樓層之石屎地台面與上一層石屎地台面之高度距離)(米)	26/F - 31/F 26樓 - 31樓	3.10					
	32/F 32樓	3.10 3.35 3.45 3.50	3.10 3.15 3.30 3.45 3.80	3.10 3.15 3.15 3.45		3.10 3.15 3.35 3.45	
Thickness of the floor slabs (excluding plaster) of each residential property (mm) 每個住宅物業的樓板 (不包括灰泥)厚度(毫米)	26/F - 31/F 26樓 - 31樓	150 200	150	150 200	150	150 200	150
	32/F 32樓	150 200 250	150 200	150 200 250	150	150 200	150

## Legend 圖例

A/C PLATFORM = Air-conditioner Platform 空調機平台  
AD = AIR DUCT = 通風槽  
BAL = Balcony 露台  
B = Bathroom 浴室  
BR = Bedroom 睡房  
BW = Bay Window 窗台  
CW = Curtain Wall 幕牆  
CANOPY = 簷蓬  
D = Down 下  
DIN = Dining Room 飯廳  
DOG HOUSE = Mechanical & Electrical Services Duct Connecting to the Floor Below  
連接下層的機電設施管道  
EMC = Electricity Meter Cabinet 電錶箱  
EMR = Electricity Meter Room 電錶房  
ELV = Extra Low Voltage Duct/Cabinet 低電壓槽/箱  
FAMILY = Family Area 家庭廳  
FLAT ROOF = 平台  
INACCESSIBLE FLAT ROOF = 不能直達平台  
HR = Hose Reel 消防喉轆  
KIT = Kitchen 廚房  
LIFT = 升降機  
LIFT LOBBY = 升降機大堂  
LIV = Living Room 客廳  
MBR = Master Bedroom 主人睡房  
OPEN PIPE WELL = 管道井  
PD = Pipe Duct 管道槽  
POOL DECK = 日光曬台  
POOL = Swimming Pool 泳池  
RS/MRR = Refuse Storage and Material Recovery Room 垃圾儲存及物料回收室  
SPACE FOR FILTRATION PLANT = 濾水機房位置  
STO = Store 儲物房  
T = Toilet 洗手間  
U = Up 上  
UP = Utility Platform 工作平台  
VOID ABOVE = 上層中空  
VOID = 中空  
WALK-IN CLOSET = 衣帽間  
WMC = Water Meter Cabinet 水錶箱

The internal areas of the residential properties on the upper floors will generally be slightly larger than those on the lower floors because of the reducing thickness of the structural walls on the upper floors.

Remark :  
The dimensions in the floor plans are all structural dimensions in millimetre.

因住宅物業的較高樓層的結構牆的厚度遞減，較高樓層的內部面積，一般比較低樓層的內部面積稍大。

備註：  
樓面平面圖之尺規所列數字為以毫米標示之建築結構尺寸。



# Floor plans of residential properties in the development 發展項目的住宅物業的樓面平面圖

Tower 3 26/F - 32/F  
第3座 26樓 - 32樓

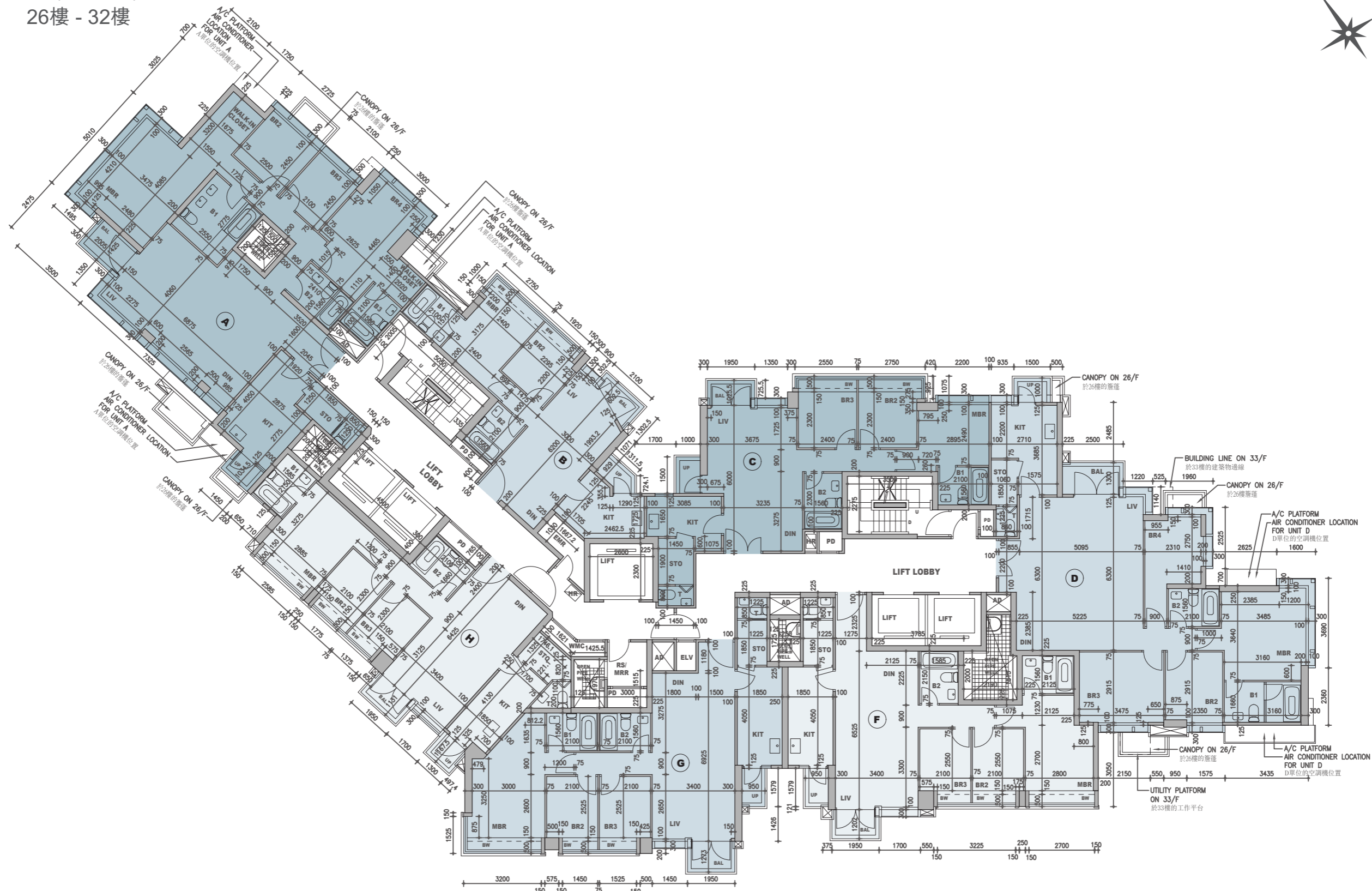
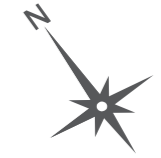

Scale 0 1 2 3 4 5M(米)  
比例 0 1 2 3 4 5M(米)

# Floor plans of residential properties in the development 發展項目的住宅物業的樓面平面圖

Tower 3 33/F  
第3座 33樓

Description 描述	Residential Unit 住宅單位						
	A	B	C	D	F	G	H
Floor-to-floor height (refers to the height between the top surface of the structural slab of a floor and the top surface of the structural slab of its immediate upper floor) of each residential property (m) 每個住宅物業的層與層之間的高度 (指該樓層之石屎地台面與上一層石屎地台面之高度距離)(米)	3.15 3.20 3.25 3.50 3.55 3.60 6.65*	3.20 3.50 3.55	3.15 3.20 3.50 3.55	3.20 3.50 3.55		3.20 3.30 3.50 3.55	
Thickness of the floor slabs (excluding plaster) of each residential property (mm) 每個住宅物業的樓板 (不包括灰泥)厚度(毫米)	150 200	150			150 200		

## Legend 圖例

A/C PLATFORM = Air-conditioner Platform 空調機平台  
AD = AIR DUCT = 通風槽  
BAL = Balcony 露台  
B = Bathroom 浴室  
BR = Bedroom 睡房  
BW = Bay Window 窗台  
CW = Curtain Wall 幕牆  
CANOPY = 簷蓬  
D = Down 下  
DIN = Dining Room 飯廳  
DOG HOUSE = Mechanical & Electrical Services Duct  
Connecting to the Floor Below  
連接下層的機電設施管道  
EMC = Electricity Meter Cabinet 電錶箱  
EMR = Electricity Meter Room 電錶房  
ELV = Extra Low Voltage Duct/Cabinet 低電壓槽/箱  
FAMILY = Family Area 家庭廳  
FLAT ROOF = 平台  
INACCESSIBLE FLAT ROOF = 不能直達平台  
HR = Hose Reel 消防喉轆  
KIT = Kitchen 廚房  
LIFT = 升降機  
LIFT LOBBY = 升降機大堂  
LIV = Living Room 客廳  
MBR = Master Bedroom 主人睡房  
OPEN PIPE WELL = 管道井  
PD = Pipe Duct 管道槽  
POOL DECK = 日光曬台  
POOL = Swimming Pool 泳池  
RS/MRR = Refuse Storage and Material Recovery Room  
垃圾儲存及物料回收室  
SPACE FOR FILTRATION PLANT = 濾水機房位置  
STO = Store 儲物房  
T = Toilet 洗手間  
U = Up 上  
UP = Utility Platform 工作平台  
VOID ABOVE = 上層中空  
VOID = 中空  
WALK-IN CLOSET = 衣帽間  
WMC = Water Meter Cabinet 水錶箱

The internal areas of the residential properties on the upper floors will generally be slightly larger than those on the lower floors because of the reducing thickness of the structural walls on the upper floors.

### Remarks :

- The dimensions in the floor plans are all structural dimensions in millimetre.
- The floor-to-floor height (i.e. the height between the top surface of the structural slab of that floor (i.e. 33/F) and the top surface of the structural slab of its immediate upper floor (i.e. 35/F) includes, without limitation, a mass concrete fill with thickness of 400mm, 350mm, 300mm and 100mm located partly on top of the top surface of the structural slab of that floor (i.e. 33/F).
- "\*" denotes the floor-to-floor height between the top surface of the structural slab of 33/F to the top surface of the structural slab of roof.

因住宅物業的較高樓層的結構牆的厚度遞減，較高樓層的內部面積，一般比較低樓層的內部面積稍大。

### 備註：

- 樓面平面圖之尺規所列數字為以毫米標示之建築結構尺寸。
- 層與層之間的高度(指該樓層(即33樓)之石屎地台面與上一層石屎地台面(即35樓)之高度距離)包括但不限於厚度為400毫米、350毫米、300毫米及100毫米之混凝土填充層(該等混凝土填充層有部分位於該樓層(即33樓)之石屎地台面上)。
- "\*"表示33樓之石屎地台面與天面之石屎地台面之高度。

# Floor plans of residential properties in the development 發展項目的住宅物業的樓面平面圖

Tower 3 33/F  
第3座 33樓

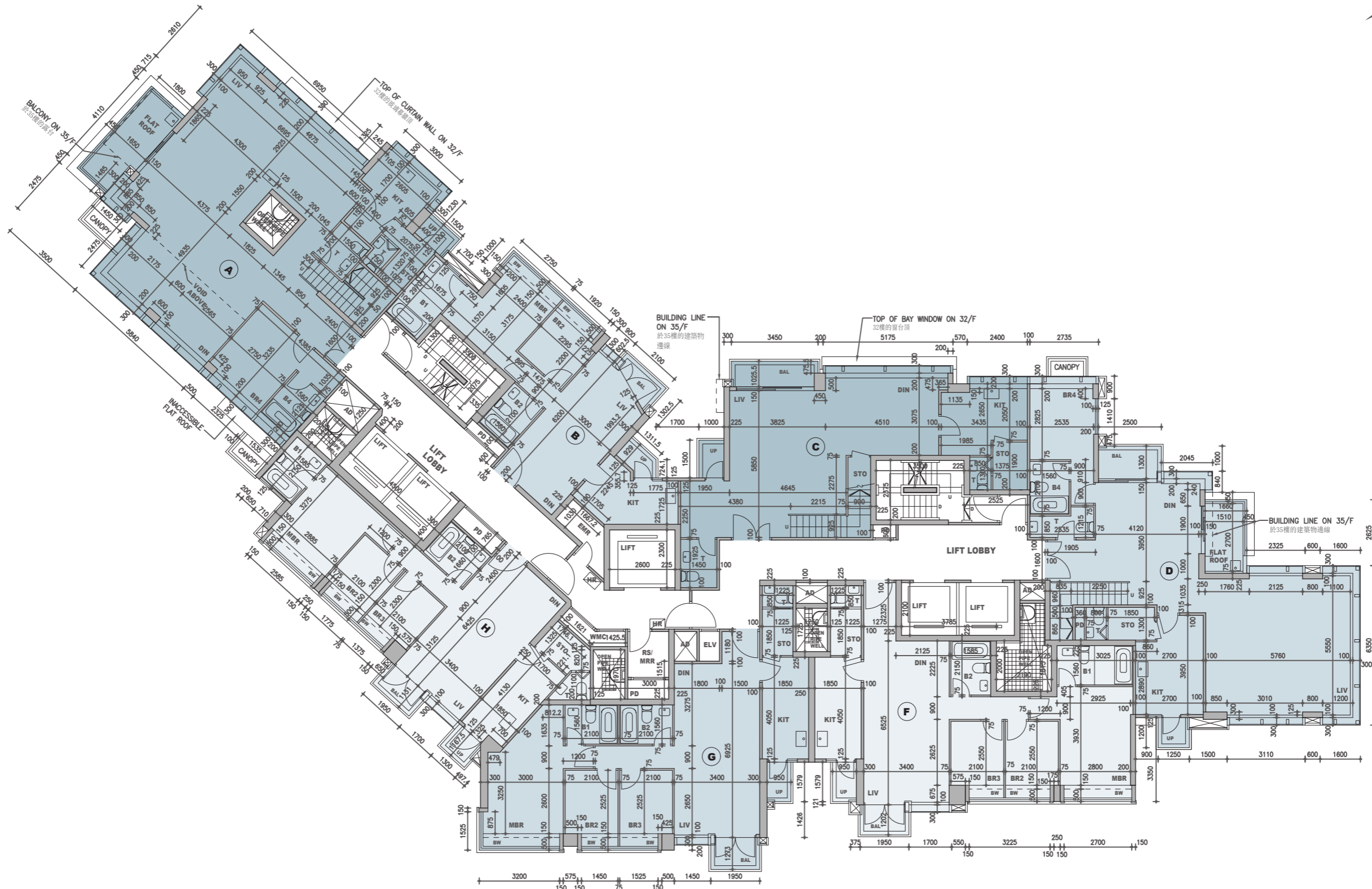
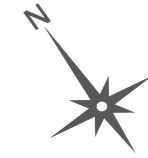



# Floor plans of residential properties in the development 發展項目的住宅物業的樓面平面圖

Tower 3 35/F  
第3座 35樓

Description 描述	Residential Unit 住宅單位							
	A	B	C	D	F	G	H	
Floor-to-floor height (refers to the height between the top surface of the structural slab of a floor and the top surface of the structural slab of its immediate upper floor) of each residential property (m) 每個住宅物業的層與層之間的高度 (指該樓層之石屎地台面與上一層石屎地台面之高度距離)(米)	3.10 3.15 3.45 3.50	3.10 3.15 3.45	3.10 3.15 3.45 3.50	3.10 3.15 3.45	3.10 3.15 3.35 3.45	3.10 3.35 3.45		
Thickness of the floor slabs (excluding plaster) of each residential property (mm) 每個住宅物業的樓板 (不包括灰泥)厚度(毫米)	150 250	150	150 200	150		150 200		

## Legend 圖例

A/C PLATFORM = Air-conditioner Platform 空調機平台  
AD = AIR DUCT = 通風槽  
BAL = Balcony 露台  
B = Bathroom 浴室  
BR = Bedroom 睡房  
BW = Bay Window 窗台  
CW = Curtain Wall 幕牆  
CANOPY = 簷蓬  
D = Down 下  
DIN = Dining Room 飯廳  
DOG HOUSE = Mechanical & Electrical Services Duct  
Connecting to the Floor Below  
連接下層的機電設施管道  
EMC = Electricity Meter Cabinet 電錶箱  
EMR = Electricity Meter Room 電錶房  
ELV = Extra Low Voltage Duct/Cabinet 低電壓槽/箱  
FAMILY = Family Area 家庭廳  
FLAT ROOF = 平台  
INACCESSIBLE FLAT ROOF = 不能直達平台  
HR = Hose Reel 消防喉轆  
KIT = Kitchen 廚房  
LIFT = 升降機  
LIFT LOBBY = 升降機大堂  
LIV = Living Room 客廳  
MBR = Master Bedroom 主人睡房  
OPEN PIPE WELL = 管道井  
PD = Pipe Duct 管道槽  
POOL DECK = 日光曬台  
POOL = Swimming Pool 泳池  
RS/MRR = Refuse Storage and Material Recovery Room  
垃圾儲存及物料回收室  
SPACE FOR FILTRATION PLANT = 濾水機房位置  
STO = Store 儲物房  
T = Toilet 洗手間  
U = Up 上  
UP = Utility Platform 工作平台  
VOID ABOVE = 上層中空  
VOID = 中空  
WALK-IN CLOSET = 衣帽間  
WMC = Water Meter Cabinet 水錶箱

The internal areas of the residential properties on the upper floors will generally be slightly larger than those on the lower floors because of the reducing thickness of the structural walls on the upper floors.

Remark :  
The dimensions in the floor plans are all structural dimensions in millimetre.

因住宅物業的較高樓層的結構牆的厚度遞減，較高樓層的內部面積，一般比較低樓層的內部面積稍大。

備註：  
樓面平面圖之尺規所列數字為以毫米標示之建築結構尺寸。



# Floor plans of residential properties in the development 發展項目的住宅物業的樓面平面圖

Tower 3 35/F  
第3座 35樓

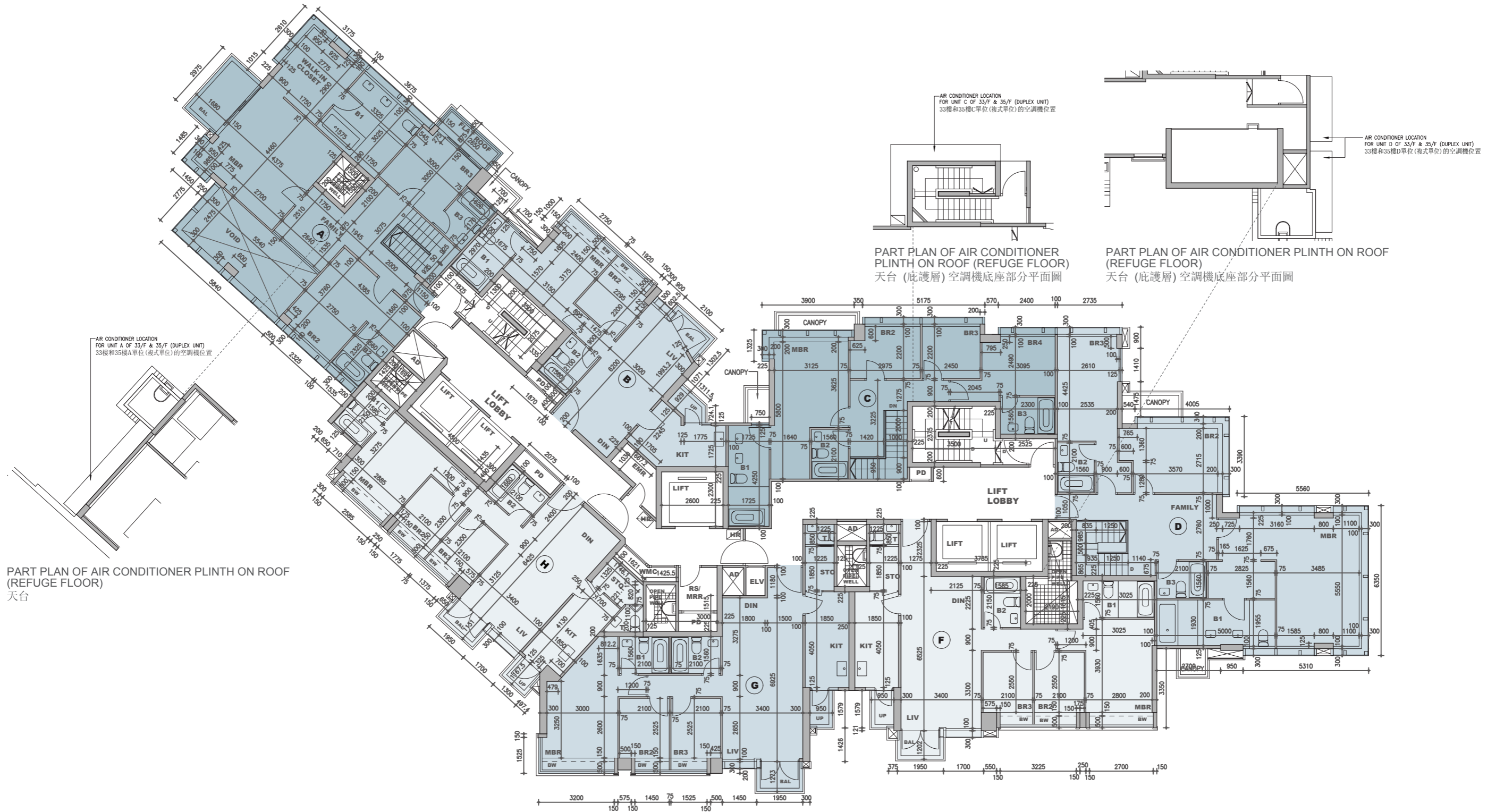
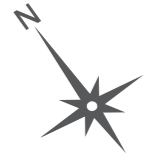

Scale 0 1 2 3 4 5M(米)  
比例 0 1 2 3 4 5M(米)

# Floor plans of residential properties in the development

## 發展項目的住宅物業的樓面平面圖

Remarks applicable to the floor plans in this section :

1. There are architectural features, metal grilles and/or exposed pipes on the external walls of some of the floors. For details, please refer to the latest approved building plans and/or approved drainage plans and/or other relevant plans.
2. Common pipes exposed and/or enclosed in cladding are located at/adjacent to the balcony and/or utility platform and/or flat roof and/or air-conditioner platform and/or external wall of some residential properties. For details, please refer to the latest approved building plans and/or approved drainage plans and/or other relevant plans.
3. There are sunken slabs for mechanical and electrical services and/or false ceiling/bulkheads for the air-conditioning fittings and/or mechanical and electrical services at some residential properties.
4. There are exposed pipes installed in some stores and toilets.
5. There are pipes exposed and/or enclosed in cladding located at the upper part of some utility platforms and balconies.
6. Balconies and utility platforms are non-enclosed areas.
7. Symbols of fittings and fitments such as bath tub, sink, water closet, shower, sink counter, etc. in the floor plans are prepared based on the latest approved building plans and are for general indication only.

適用於本節之樓面平面圖之備註：

1. 部分樓層外牆範圍設有建築裝飾、金屬格柵及/或外露喉管，詳細資料請參考最新經批准的建築圖則及/或經批准的排水設施圖則及/或其他相關圖則。
2. 部分住宅物業的露台及/或工作平台及/或平台及/或空調機平台及/或外牆上/附近設有外露及/或外牆裝飾板(覆蓋板)內藏之公用喉管，詳細資料請參考最新經批准的建築圖則及/或經批准的排水設施圖則及/或其他相關圖則。
3. 部分住宅物業有用以安裝機電設備的跌級樓板及/或用以裝置空調裝備及/或其他機電設備的假天花/裝飾橫樑。
4. 部分儲物房及洗手間內裝有外露喉管。
5. 部分工作平台及露台上方裝有外露及/或裝飾板(覆蓋板)內藏之喉管。
6. 露台及工作平台為不可封閉的地方。
7. 樓面平面圖上所顯示的裝置符號，如浴缸、洗滌盆、坐廁、花灑、洗滌盆櫃等乃按最新經批准建築圖則繪製，只作一般示意用途。

Legend for floor plans of residential properties in the Development  
發展項目的住宅物業的樓面平面圖圖例

A/C PLATFORM = Air-conditioner Platform 空調機平台  
AD = AIR DUCT = 通風槽  
BAL = Balcony 露台  
B = Bathroom 浴室  
BR = Bedroom 睡房  
BW = Bay Window 窗台  
CW = Curtain Wall 幕牆  
CANOPY = 簷蓬  
D = Down 下  
DIN = Dining Room 飯廳  
DOG HOUSE = Mechanical & Electrical Services Duct Connecting to the Floor Below  
連接下層的機電設施管道  
EMC = Electricity Meter Cabinet 電錶箱  
EMR = Electricity Meter Room 電錶房  
ELV = Extra Low Voltage Duct/Cabinet 低電壓槽/箱  
FAMILY = Family Area 家庭廳  
FLAT ROOF = 平台  
INACCESSIBLE FLAT ROOF = 不能直達平台  
HR = Hose Reel 消防喉轆  
KIT = Kitchen 廚房  
LIFT = 升降機  
LIFT LOBBY = 升降機大堂  
LIV = Living Room 客廳  
MBR = Master Bedroom 主人睡房  
OPEN PIPE WELL = 管道井  
PD = Pipe Duct 管道槽  
POOL DECK = 日光曬台  
POOL = Swimming Pool 泳池  
RS/MRR = Refuse Storage and Material Recovery Room  
垃圾儲存及物料回收室  
SPACE FOR FILTRATION PLANT = 濾水機房位置  
STO = Store 儲物房  
T = Toilet 洗手間  
U = Up 上  
UP = Utility Platform 工作平台  
VOID ABOVE = 上層中空  
VOID = 中空  
WALK-IN CLOSET = 衣帽間  
WMC = Water Meter Cabinet 水錶箱